



SAXON SHORE
— ESTATE AGENTS —



10 St. Johns Road, Faversham, ME13 8EL Offers in excess of £260,000

Introducing this two bedroom terrace house on St John's Road in Faversham. Located close to the recreation ground a short walk away from the town centre and mainline train station.

Accommodation spans across two floors and comprises a well proportioned sitting room, a dining room with plenty of built in storage and original cupboard doors, a kitchen with access to the garden where there is a W/C to the ground floor.

Upstairs on the first floor are two good sized bedrooms and a full bathroom.

Outside to the rear is a well proportioned garden, mainly laid to lawn with a patio area.

Don't miss your chance to make this house, your new home! Contact us to arrange a viewing!

Sitting Room

10'5" x 10'11" (3.2 x 3.35)



Bedroom 2

7'9" x 10'11" (2.37 x 3.35)



Dining Room

Dining Room

10'5" x 10'11" (3.2 x 3.35)



Bathroom

5'10" x 9'10" (1.8 x 3)



Kitchen

5'10" x 9'10" (1.8 x 3)



Garden

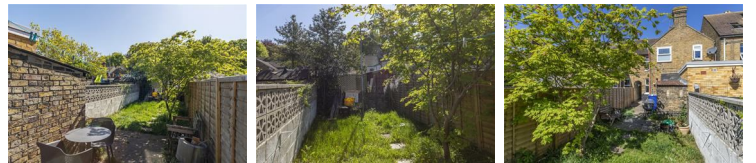

Landing



Bedroom 1

13'3" x 10'11" (4.05 x 3.35)



GROUND FLOOR
31.7 sq.m. (342 sq.ft.) approx.

1ST FLOOR
31.9 sq.m. (343 sq.ft.) approx.

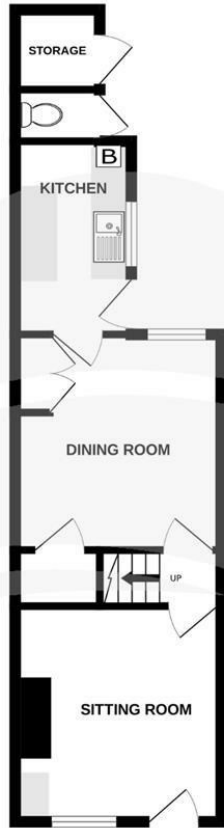

TOTAL FLOOR AREA: 63.6 sq.m. (685 sq.ft.) approx.

Whilst every attempt has been made to ensure the accuracy of the floorplans contained herein, measurements of doors, windows, rooms and any other items are approximate and no responsibility is taken for any error, omission or mis-statement. This plan is for illustrative purposes only and should be used as such by any prospective purchaser. The services, systems and appliances shown have not been tested and no guarantee as to their operability or efficiency can be given.
Made with Metrepro (C020)

