



Newburgh Road, W3

£375,000

A beautifully presented first-floor one-bedroom period conversion, located in the highly desirable Poets' Corner neighbourhood. The property comes with a share of freehold and has been finished to an exceptional standard throughout.

Newburgh Road is located just off Churchfield Road with its independent shops and cafés. Acton Central, Acton Main Line (Elizabeth Line) and Acton Town station are all within half a mile.

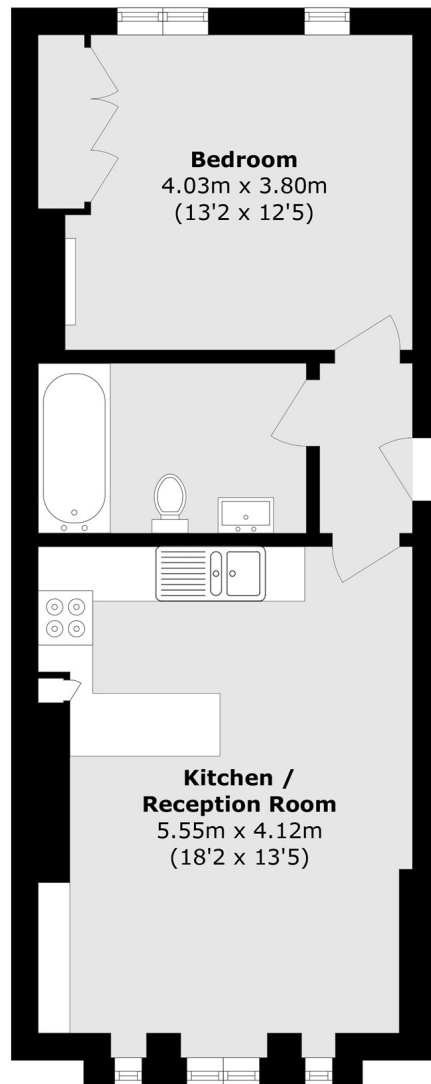

Total area (approx.): 45.8 sq. m (492.9 sq. ft)

Robertson Smith & Kempson Acton Sales
137 High Street, Acton,
London, W3 6LY
020 8896 3996
actonsales@robertsonsmithandkempson.co.uk

Energy Rating: C. We aim to make our particulars both accurate and reliable. However they are not guaranteed; nor do they form part of an offer or contract. If you require clarification on any points then please contact us, especially if you're traveling some distance to view. Please note that appliances and heating systems have not been tested and therefore no warranties can be given as to their good working order.