

High Street, Chatham

£900 PCM



MARTIN&CO

High Street, Chatham

Date Available: 1st December 2025

Deposit: £1,038
Unfurnished

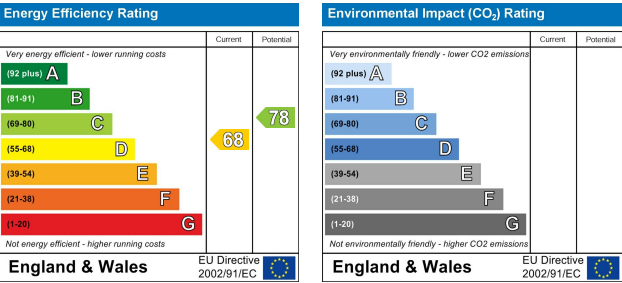
- Fitted kitchen
- 2 Bedrooms
- Central Location
- Electric Heating
- Unfurnished
- No deposit option available
- Local transport links
- High Street Location
- Please note there is no parking with this property (on road permit parking can be obtained from the local council)
- Viewing recommended



A splendid two-bedroom flat in a vibrant urban location, offering an open-plan reception room and kitchen. A large shower room. This property is perfect for individuals or single occupancy seeking comfort, convenience, and excellent transport links.

Please note there is no parking with this property, local permits can be obtained at a cost to tenants from Medway council.

If you would like to arrange a viewing for this property, please submit an online enquiry to us via this website using the 'email agent' or 'request details' button.

Mid Floor
489 sq.ft. (45.4 sq.m.) approx.

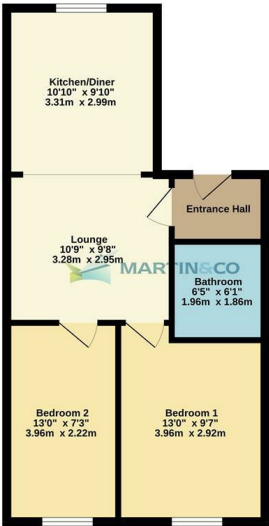

TOTAL FLOOR AREA - 489 sq.ft. (45.4 sq.m.) approx.
Made with Metragen i2025

Martin & Co Medway Lettings
161 High Street, Rochester, Kent, ME1 1EH
01634 838700 . medway@martinco.com

01634 838700
<http://www.martinco.com>



Accuracy: References to the Tenure of a Property are based on information supplied by the Seller. The Agent has not had sight of the title documents. A Buyer is advised to obtain verification from their Solicitor. Items shown in photographs including but not limited to carpets, fixtures and fittings are not included unless specifically mentioned within the sales particulars. They may however be available by separate negotiation. Buyers must check the availability of any property and make an appointment to view before embarking on any journey to see a property. No person in the employment of the agent has any authority to make any representation about the property, and accordingly any information given is entirely without responsibility on the part of the agents, sellers(s) or lessors(s). Any property particulars are not an offer or contract, nor form part of one. **Sonic / laser Tape:** Measurements taken using a sonic / laser tape measure may be subject to a small margin of error. **All Measurements:** All Measurements are Approximate. **Services Not tested:** The Agent has not tested any apparatus, equipment, Fixtures and Fittings or services and so cannot verify that they are in working order or fit for the purpose. A Buyer is advised to obtain verification from their Solicitor or Surveyor.

