



TO LET

Kingsley Road, Hounslow, TW3 4AR
£2,450 Per Calendar Month

DBK
ESTATE AGENTS

- Available To Rent Immediately!
- Semi Detached House
- Two Large Reception Rooms
- Kitchen
- Three Spacious Bedrooms
- Chic Family Bathroom/ WC
- Private Rear Garden
- Off Street Parking for Two Cars
- Hounslow East 0.3 Miles
- Hounslow High Street 0.8 Miles

THE PROPERTY

Available To Rent Immediately!

This well presented semi detached house offers generous living space throughout, ideal for families and professional tenants alike.

The property features two large reception rooms, providing flexible living and dining areas, along with a fitted kitchen offering ample storage and workspace. Upstairs comprises three spacious bedrooms and a chic family bathroom/WC finished to a modern standard.

Externally, the home benefits from a private rear garden, perfect for outdoor entertaining and relaxation, as well as off street parking for two cars.

Conveniently located just 0.3 miles from Hounslow East Underground Station and 0.8 miles from Hounslow High Street, the property offers excellent access to local amenities, shops, schools, and transport links.

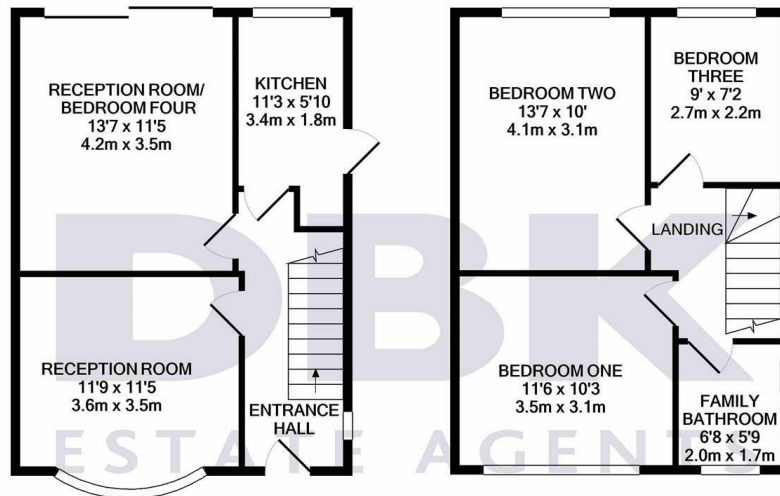

GROUND FLOOR
APPROX. FLOOR
AREA 419 SQ.FT.
(38.9 SQ.M.)

1ST FLOOR
APPROX. FLOOR
AREA 409 SQ.FT.
(38.0 SQ.M.)

TOTAL APPROX. FLOOR AREA 829 SQ.FT. (77.0 SQ.M.)

Whilst every attempt has been made to ensure the accuracy of the floor plan contained here, measurements of doors, windows, rooms and any other items are approximate and no responsibility is taken for any error, omission, or mis-statement. This plan is for illustrative purposes only and should be used as such by any prospective purchaser. The services, systems and appliances shown have not been tested and no guarantee as to their operability or efficiency can be given

Made with Metropix ©2019