



Norwich Road, Barham, Ipswich, IP6 0DH

welcome to

Norwich Road, Barham, Ipswich

This well-presented, semi-detached home has been freshly decorated throughout and benefits from two bedrooms, a lounge/diner, a 1st floor bathroom, a beautifully presented rear garden with cabin, a garage and off street parking. NO ONWARD CHAIN!

Entrance Porch

A door to the kitchen.

Kitchen

Modern kitchen, leading to the living area, with eye and base level units in cashmere with black worktop surfaces, a fitted breakfast bar, tiled flooring, under floor heating, double glazed window to the rear, spotlights, a black sink plus drainer and chrome mixer tap, an integrated double oven with induction hob and extractor hood, space for a dishwasher, washing machine and fridge/freezer.

Lounge/Diner

Beautifully presented lounge/diner with double glazed window to the front, a glazed door to the rear garden, wood effect flooring throughout, two radiators, TV point and an understairs storage cupboard.

First Floor Landing

Carpet flooring.

Master Bedroom

Double glazed box bay window to the front, carpet flooring, one electric radiator and a fitted wardrobe.

Bedroom Two

Double glazed window to the rear, carpet flooring, one electric radiator and loft hatch.

Bathroom

Fully tiled walls and flooring, low level WC, pedestal wash hand basin, a P bath with overhead shower and glass screen, white heated towel rail, spotlights, an airing cupboard and double glazed window to the rear.

Outside:

Front Garden

A shingle parking space and a further parking space in front of the garage.

Rear Garden

Beautifully presented rear garden, which is relatively un-overlooked, with a raised decking area, a patio area, a shed, a cabin to the rear, a grassed area, a side access and an outside tap.

Cabin

With power, insulated walls, double glazed window to the side and patio doors to entry.

Garage

An up and over door. This garage is currently used for storage.

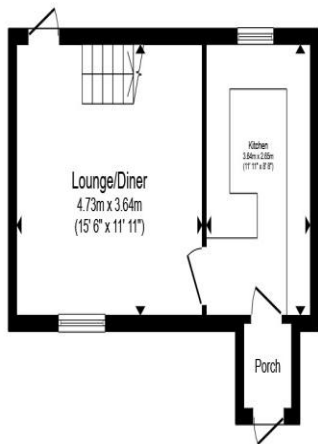

Ground Floor

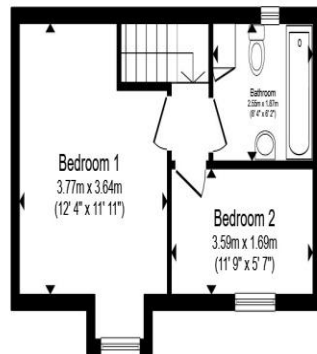

First Floor

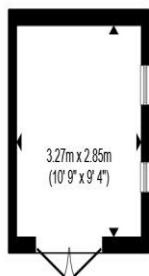

Cabin

Total floor area 65.8 m² (708 sq.ft.) approx

This floor plan is for illustrative purposes only. It is not drawn to scale. Any measurements, floor areas (including any total floor area), openings and orientation are approximate. No details are guaranteed, they cannot be relied upon for any purpose and they do not form part of any agreement. No liability is taken for any error, omission or misstatement. A party must rely upon its own inspection(s). Powered by www.propertybox.io



welcome to
Norwich Road,
Barham, Ipswich

- No onward chain
- Freshly redecorated throughout
- Two bedrooms
- Large cabin in the rear garden
- Garage & off street parking

Tenure: Freehold EPC Rating: D
Council Tax Band: B

offers in excess of
£220,000



view this property online williamhbrown.co.uk/Property/IPS121163



Property Ref:
IPS121163 - 0005

1. MONEY LAUNDERING REGULATIONS Intending purchasers will be asked to produce identification documentation at a later stage and we would ask for your co-operation in order that there is no delay in agreeing the sale. 2. These particulars do not constitute part or all of an offer or contract. 3. The measurements indicated are supplied for guidance only and as such must be considered incorrect. Potential buyers are advised to recheck measurements before committing to any expense. 4. We have not tested any apparatus, equipment, fixtures or services and it is in the buyers interest to check the working condition of any appliances. 5. Where an EPC, or a Home Report (Scotland only) is held for this property, it is available for inspection at the branch by appointment. If you require a printed version of a Home Report, you will need to pay a reasonable production charge reflecting printing and other costs. 6. We are not able to offer an opinion either written or verbal on the content of these reports and this must be obtained from your legal representative. 7. Whilst we take care in preparing these reports, a buyer should ensure that his/her legal representative confirms as soon as possible all matters relating to title including the extent and boundaries of the property and other important matters before exchange of contracts.

William H Brown is a trading name of Sequence (UK) Limited which is registered in England and Wales under company number 4268443, Registered Office is Cumbria House, 16-20 Hockliffe Street, Leighton Buzzard, Bedfordshire, LU7 1GN. VAT Registration Number is 500 2481 05.



william h brown



01473 226101



ipswich@williamhbrown.co.uk



16-18 Wolsey House, Princes Street, IPSWICH,
Suffolk, IP1 1QT



williamhbrown.co.uk