



Riverdale Road, TW1

£2,495 Per calendar month

A truly exceptional one bedroom apartment set within a beautiful Victorian conversion, offering an impressive 760 sq ft of well-balanced living space, larger than many two bedroom properties. The apartment has been tastefully renovated throughout, combining modern finishes with an abundance of original character, including high ceilings and a feature fireplace. The standout bedroom is complete with a feature freestanding bath, while there is also a separate stylish shower room. Further benefits include a charming cottage-style kitchen, direct access to well-maintained communal gardens and the rare advantage of off-street parking.

Riverdale Road is a picturesque, tree-lined residential street, characterised by an attractive collection of grand period buildings. Ideally positioned just moments from the River Thames, it offers a pleasant riverside walk leading directly into the heart of Richmond. Marble Hill Park and Old Deer Park are close by. As well as East

Features

Victorian Conversion
High Ceilings
760 Sq. Ft
Off-Street Parking
One Bedroom
External Storage

Riverdale Road, East Twickenham, TW1

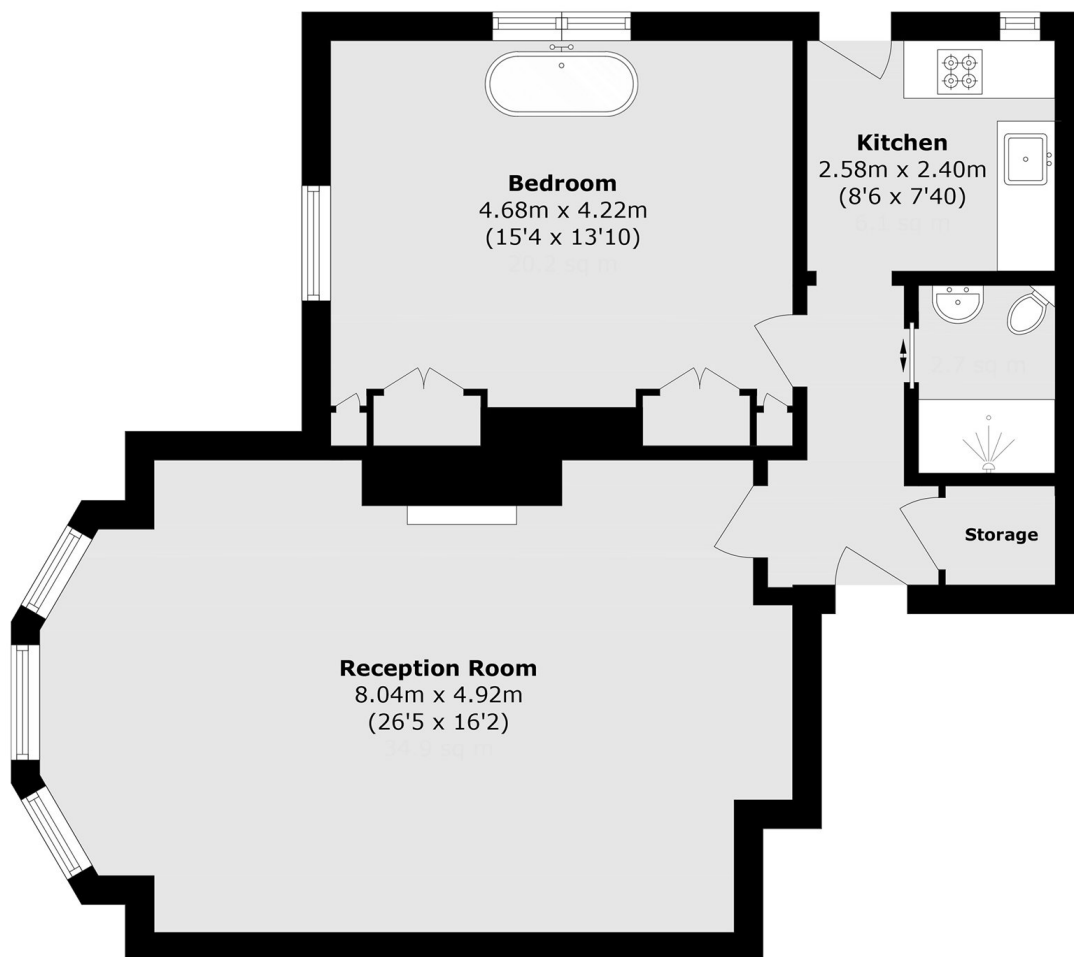

Total area (approx.): 72.0 sq. m (775.0 sq. ft)