



Pentonville Road, N1

£3,500 Per calendar month

A spacious two double bedroom duplex apartment within a Georgian conversion. The property features a private entrance and a private south facing garden and terrace.

Pentonville Road is ideally located for Angel, Upper Street and Kings Cross. There are numerous facilities available for access to the City and the West End. Transport can be found at Angel (Northern line) and Kings Cross (Eurostar, National Rail, Victoria line, Northern line, Hammersmith & City, Circle & Metropolitan line).

Features

- Two Bedrooms
- Period Conversion
- Private Garden & Terrace
- Duplex
- High Ceilings
- Private Entrance

Pentonville Road, London, N1

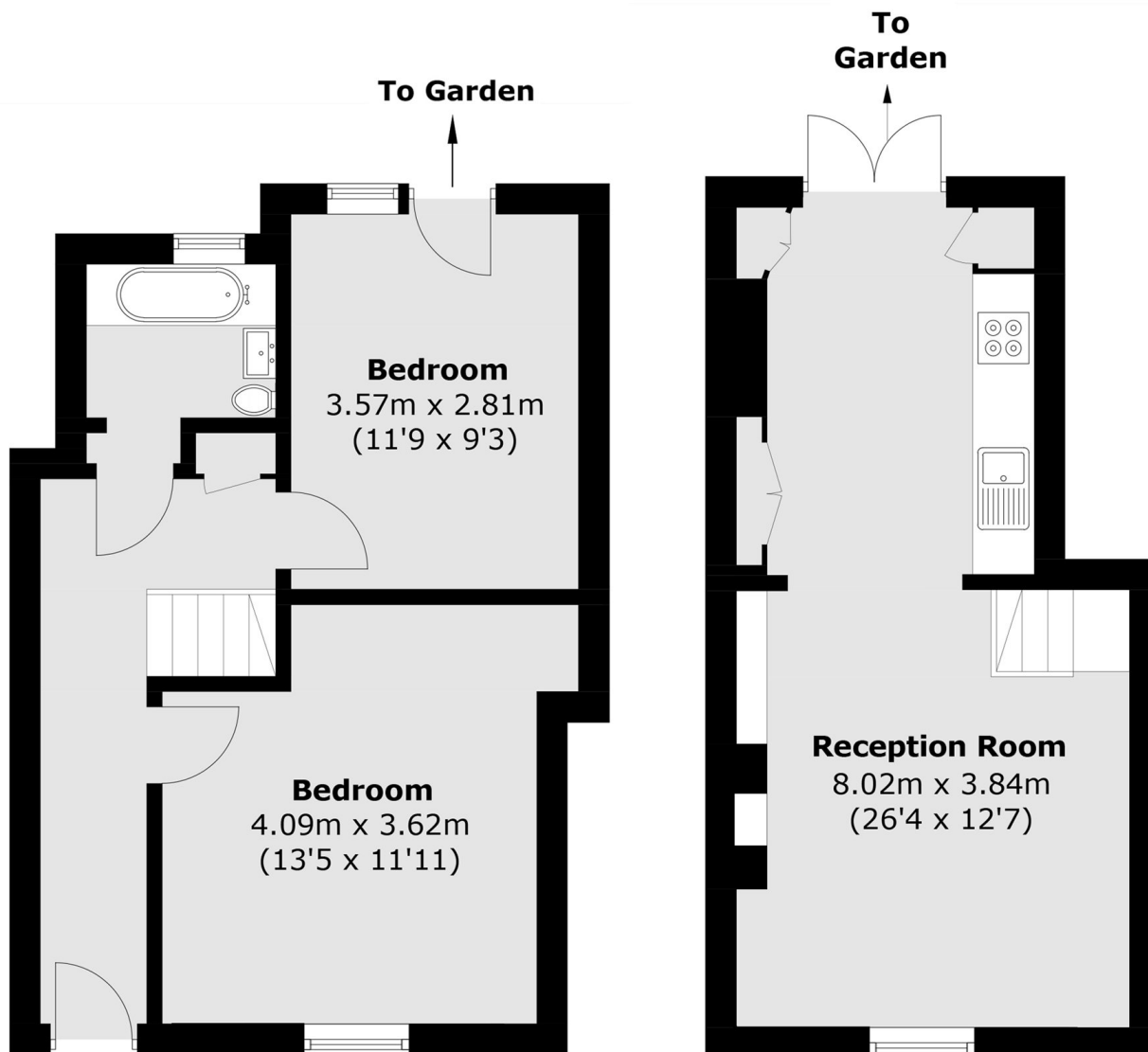

Total area (approx.): 65.9 sq. m (709.3 sq. ft)