

Whilst every attempt has been made to ensure the accuracy of the floor plan and details contained here, measurements of doors, windows, rooms and any other items are approximate and no responsibility is taken for any error, omission, or mis-statement. This plan is for illustrative purposes only and should be used as such by any prospective purchaser. The services, systems and appliances shown have not been tested and have no guarantee as to their operability or efficiency can be given. Floor plan made with Metropix 2014. Fixtures and fittings may vary at point of sale.

Tel: 01536 524475  
www.chrisgeorgeestategent.co.uk

Corby  
1A SPENCER COURT  
CORBY  
NORTHAMPTONSHIRE  
NN17 1BH

Thrapston  
22 HIGH STREET  
THRAPSTON  
NORTHAMPTONSHIRE  
NN14 4JH

Rothwell  
30 HIGH STREET  
ROTHWELL  
NORTHAMPTONSHIRE  
NN14 6BQ

Kettering  
12B HORSEMARKET  
KETTERING  
NORTHAMPTONSHIRE  
NN16 0DQ

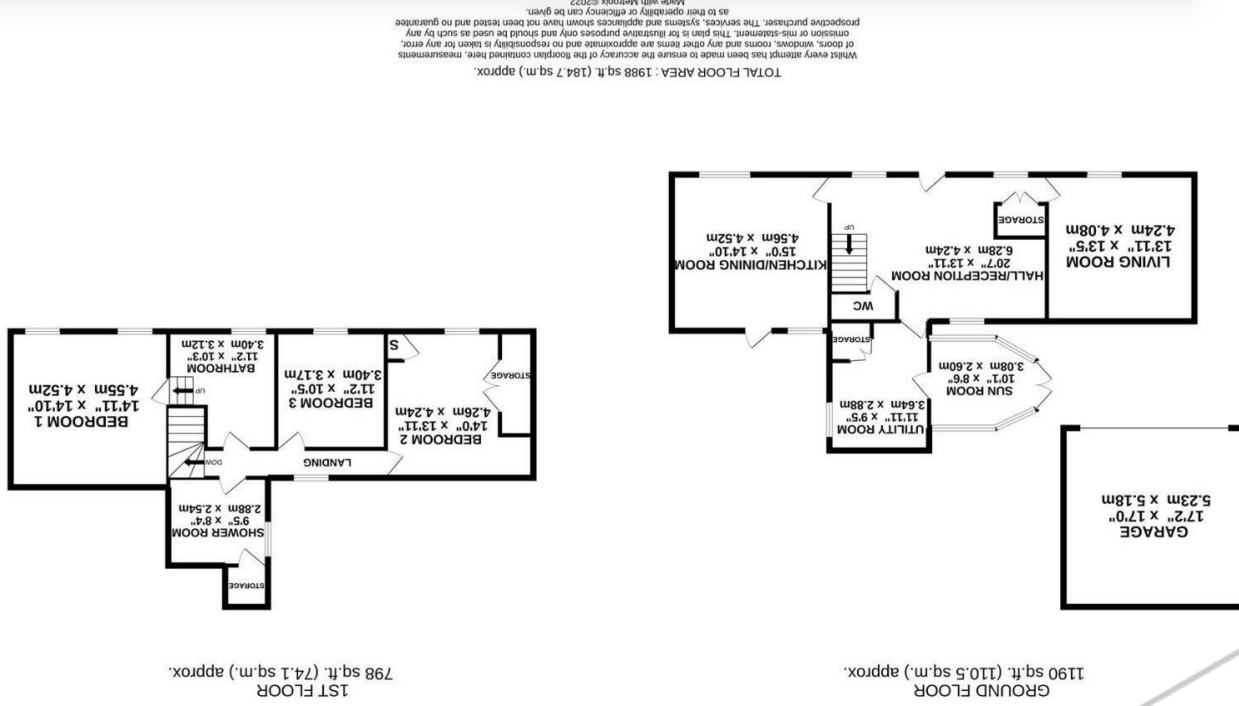

Surrenden House The Green, Kettering, NN14 4BB  
Asking price £600,000



Inside, the home opens into a welcoming hall/reception space, where flagstone flooring and underfloor heating create a warm yet practical entrance, ideal for country living. The accommodation flows seamlessly into a generous living room featuring engineered wood flooring and a clear view wood burner, providing a cosy focal point. A second reception area offers additional versatility, also benefitting from its own wood burner—perfect for use as a snug, study, or family room.

The kitchen/dining room forms the heart of the home and is fitted with a high-quality Wychwood kitchen, complemented by elegant granite worktops and ample space for a range oven. This well-designed space is ideal for both everyday family life and entertaining guests. A separate utility room and WC add further convenience, while the adjoining sun room offers a bright and tranquil space with views over the garden.

Upstairs, the property offers three well-proportioned bedrooms. The principal bedroom enjoys access to a stylish Jack and Jill bathroom, which also serves the landing, creating a practical yet luxurious arrangement.

Two further bedrooms provide flexible accommodation, supported by an additional shower room.

Externally, the cottage continues to impress with its detached garage, charming garden setting, and strong kerb appeal.



PREVIEW



**Hall/Reception Room**  
20'7" x 13'10" (6.28 x 4.24)

**Living Room**  
13'10" x 13'4" (4.24 x 4.08)

**Kitchen/Dining Room**  
14'11" x 14'9" (4.56 x 4.52)

**Utility Room**  
11'11" x 9'5" (3.64 x 2.88)

**Sun Room**  
10'1" x 8'6" (3.08 x 2.60)

**Landing**

**Bedroom One**  
14'11" x 14'9" (4.55 x 4.52)

**Bedroom Two**  
13'11" x 13'10" (4.26 x 4.24)

**Bedroom Three**  
11'1" x 10'4" (3.40 x 3.17)

**Bathroom**  
11'1" x 10'2" (3.40 x 3.12)

**Shower Room**  
9'5" x 8'3" (2.88 x 2.54)

