

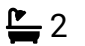

## Lodge Close, Edgware

£450,000

 3  2  1

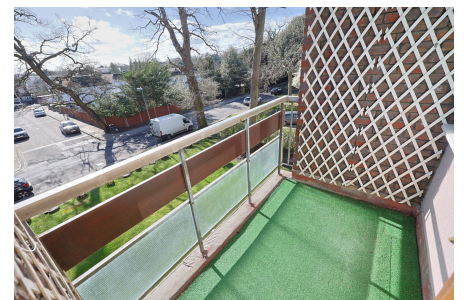

A Chain Free Three Double Bedroom, Two Bathroom Apartment in this desirable Edgware location.

## Key Features

- Share of Freehold
- Two Bathrooms
- Secure gated parking
- Communal Gardens
- Separate Kitchen
- Three Bedrooms
- Spacious Reception
- SouthWest Facing Balcony
- Sole Agent
- 2nd Floor with Lift in Block

SECOND FLOOR  
1113 sq.ft. (103.4 sq.m.) approx.

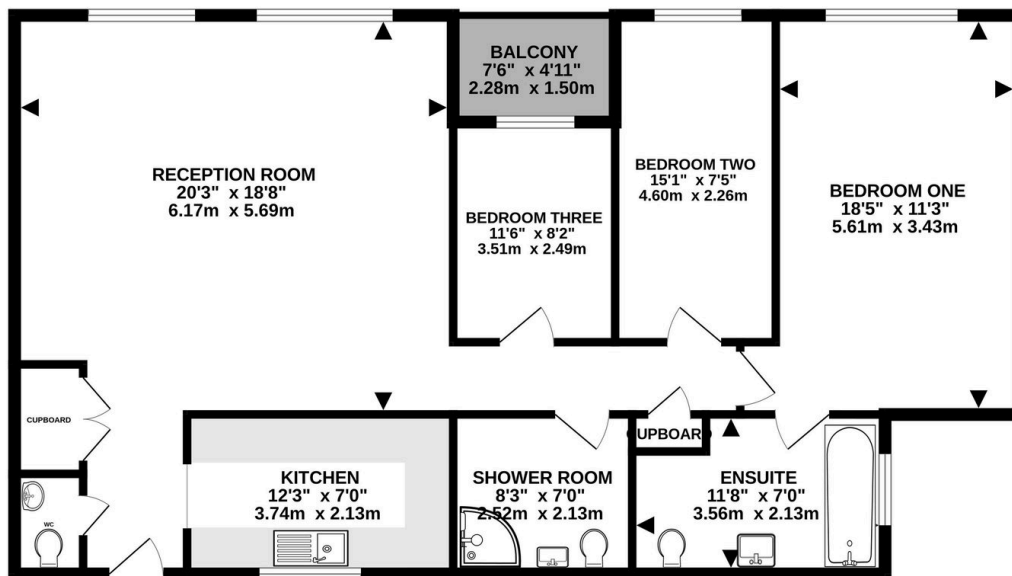

TOTAL FLOOR AREA: 1113 sq.ft. (103.4 sq.m.) approx.

Whilst every attempt has been made to ensure the accuracy of the floorplan contained here, measurements of doors, windows, rooms and any other items are approximate and no responsibility is taken for any error, omission or mis-statement. This plan is for illustrative purposes only and should be used as such by any prospective purchaser. The services, systems and appliances shown have not been tested and no guarantee as to their operability or efficiency can be given.  
Made with Metropix ©2026

