



Pevensey Road, St. Leonards-On-Sea TN38 0JY

Offers in excess of £310,000



NO ONWARD CHAIN - A deceptively spacious TWO BEDROOM GARDEN APARTMENT situated in a sought after St. Leonards setting just a short stroll from local shops, transport links and both Hastings Town centre and the vibrant hub of St. Leonards On Sea which benefits from a mainline railway station with connections to London. Spanning the entirety of the GROUND FLOOR and accessed via a PRIVATE ENTRANCE, the accommodation benefits from a wealth of original features including floorboards and wooden sash windows. The bright living room measures 20'11 x 15'10, offering ample room for a full dining table and enjoys double doors to the enclosed rear garden. The kitchen is fitted with modern units and offers additional dining space, alongside access to the useful utility room. There are TWO DOUBLE BEDROOMS with the primary enjoying a BAY WINDOW and BUILT-IN STORAGE, together with the FAMILY BATHROOM where there is a bath with shower over and a separate W/C. There is also a useful BUILT-IN cupboard located in both the living room and entrance hall, offering plenty of storage space. The PRIVATE REAR GARDEN is a particular feature here with an area of decking and wooden pergola, providing an idyllic spot to dine al-fresco, followed by a LARGE EXPANSE OF LAWN. Relishing generous proportions, this property would make the perfect first time home or investment.

GROUND FLOOR
976 sq.ft. (90.7 sq.m.) approx.

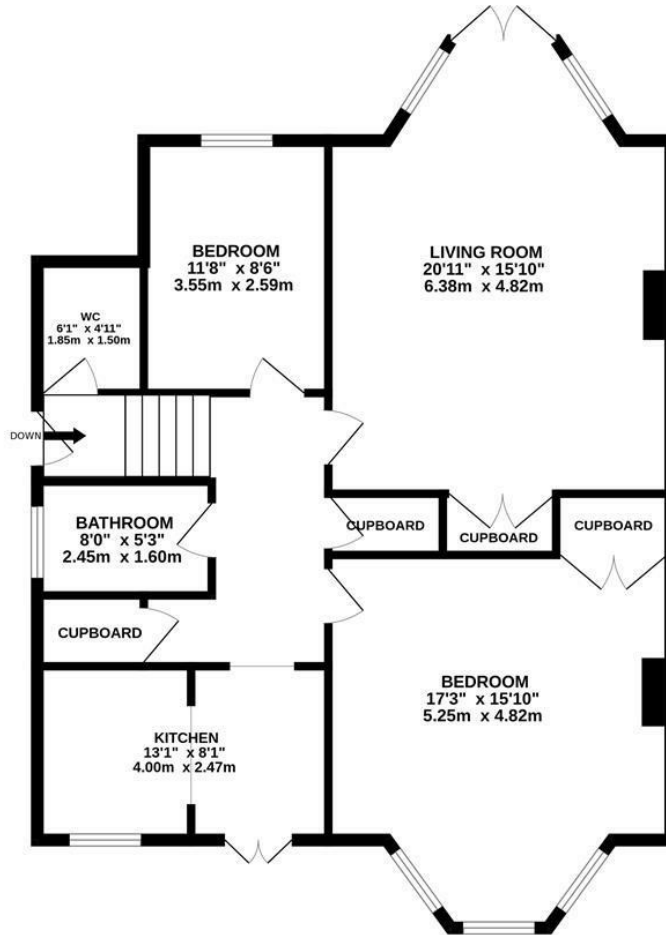

TOTAL FLOOR AREA : 976 sq.ft. (90.7 sq.m.) approx.

Whilst every attempt has been made to ensure the accuracy of the floorplan contained here, measurements of doors, windows, rooms and any other items are approximate and no responsibility is taken for any error, omission or mis-statement. This plan is for illustrative purposes only and should be used as such by any prospective purchaser. The services, systems and appliances shown have not been tested and no guarantee as to their operability or efficiency can be given.
Made with Metropix ©2025

