



Redmason Road, Ardleigh

50% SHARED OWNERSHIP. Enquire for further information.

A beautifully presented two-bedroom semi-detached home built by Bellway Homes, situated within a popular modern development in the sought-after village of Ardleigh. Offering approximately 785 sq. ft. of contemporary accommodation, the property features a spacious open-plan living and dining room, modern fitted kitchen, principal bedroom with en-suite, enclosed rear garden and private driveway parking. Ideally located for village amenities, Colchester city centre and excellent transport links, this is an ideal first-time purchase, downsizing opportunity or investment.

Guide price £150,000

Redmason Road

Ardleigh, Colchester, CO7



- Beautifully presented two-bedroom semi-detached home
- Modern fitted kitchen and ground floor cloakroom
- Sought-after Ardleigh village location with easy access to Colchester, the A12 and mainline rail links to London
- Built by Bellway Homes on a popular modern development
- Principal bedroom with en-suite shower room
- Shared Ownership Scheme - 50% ownership - alternative buying options available. Contact office for further information
- Spacious open-plan sitting and dining room with French doors to the garden
- Enclosed rear garden and private driveway providing off-road parking

The Property

Built by Bellway Homes and presented in excellent decorative order throughout, this beautifully maintained two-bedroom semi-detached home offers contemporary accommodation ideal for first-time buyers, young families or those looking to downsize. Occupying a desirable position within a modern development in the sought-after village of Ardleigh, the property benefits from a spacious open-plan living area, a stylish fitted kitchen, en-suite to the principal bedroom and driveway parking.

The welcoming entrance hall provides access to a convenient ground floor cloakroom before leading into the modern kitchen, which is fitted with a range of contemporary units, contrasting work surfaces and integrated cooking appliances, with space for additional white goods.

To the rear of the property, the impressive sitting and dining room extends across the full width of the house, creating a bright and versatile living space. French doors open directly onto the rear garden, allowing plenty of natural light while providing the perfect setting for entertaining or relaxing.

The first floor offers two generous double bedrooms. The principal bedroom enjoys the added luxury of a stylish en-suite shower room, while the second bedroom is served by a modern family bathroom fitted with a white three-piece suite and shower over the bath.

Finished in neutral tones throughout, the property offers a move-in-ready home with well-planned accommodation extending to approximately 785 sq. ft

The Outside

To the front of the property is an attractive frontage with a pathway leading to the entrance and a private driveway providing off-road parking. A gated side access leads to the enclosed rear garden, which is mainly laid to lawn with a patio area adjoining the house, creating an ideal space for outdoor dining and entertaining. Timber fencing provides privacy, while a useful garden shed offers additional external storage.

The Area

Redmason Road forms part of a popular modern development in the highly desirable village of Ardleigh, located just a few miles north-east of Colchester. The village offers a strong sense of community together with a range of everyday amenities including a village shop, primary school, public house and recreational facilities. Colchester city centre and Colchester North Station are within easy reach, providing direct rail services to London Liverpool Street, while the nearby A12 offers convenient access towards Chelmsford, Ipswich and beyond. The surrounding countryside also provides an abundance of scenic walking routes and open green spaces.

Further Information

£150,000 for 50% ownership through Shared Ownership Scheme.

Tenure: Freehold

Council Tax: Tendring Band C

Construction: Brick

Mains water, gas, electricity and sewerage.

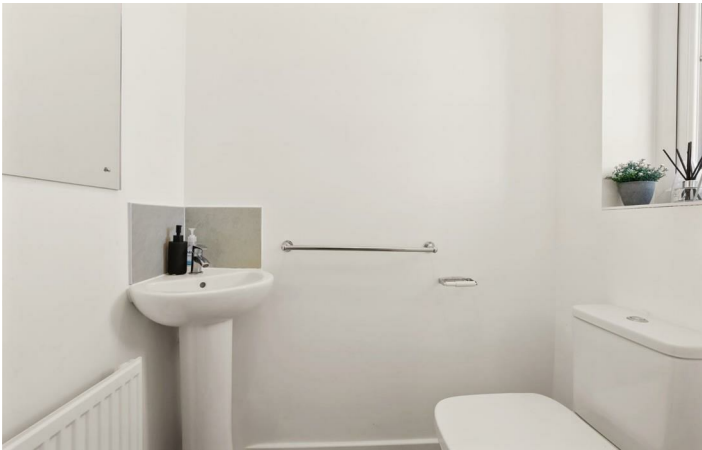

Floor Plan

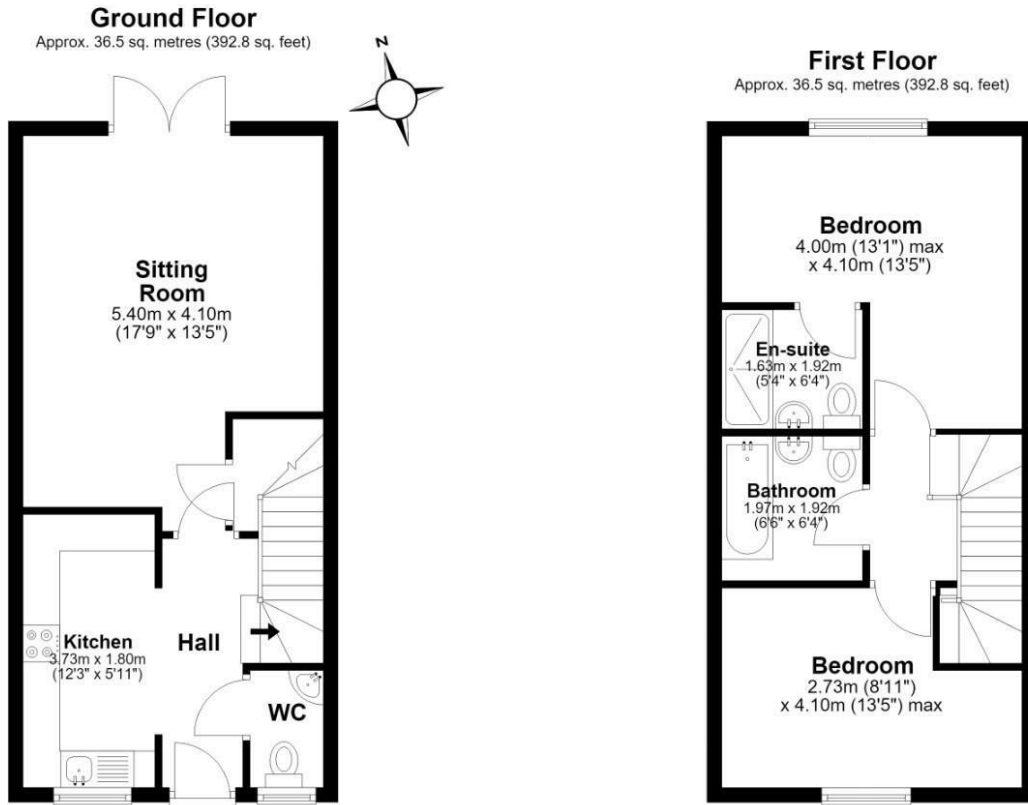

Total area: approx. 73.0 sq. metres (785.5 sq. feet)

All measurements are provided as a general guide for prospective buyers and should not be considered precise. This floor plan is for illustrative purposes only, and no responsibility is accepted for any error, omission, or misstatement. The services, systems and appliances shown have not been tested, and no guarantee is given regarding their operability or efficiency. Measurements may have been taken from the widest points and could include wardrobe or cupboard space. No guarantee is given for any measurements, including total areas. Buyers are strongly advised to take their own measurements.

Plan produced using PlanUp.

Redmason Road, Ardleigh

These particulars, whilst believed to be accurate are set out as a general outline only for guidance and do not constitute any part of an offer or contract. Intending purchasers should not rely on them as statements of representation of fact, but must satisfy themselves by inspection or otherwise as to their accuracy. No person in this firm's employment has the authority to make or give any representation or warranty in respect of the property.

