



Donington Park, Leverington Wisbech PE13 5EF

Welcome to

Donington Park, Leverington Wisbech

Situated within one of the most desirable areas of Leverington, this beautifully presented two bedroom bungalow on Donington Park offers modern living in a peaceful cul-de-sac setting. The property has been fully modernised and provides well-balanced accommodation including a comfortable lounge, a modern fitted kitchen, two bedrooms and a family bathroom. Externally, the home benefits from off-road parking along with a single garage, providing both convenience and storage. The rear garden is enclosed, offering a private and manageable outdoor space. Located in a highly regarded residential area, properties in this part of Leverington are always in strong demand. A fantastic opportunity to secure a modern bungalow in a prime location - early viewing is highly recommended



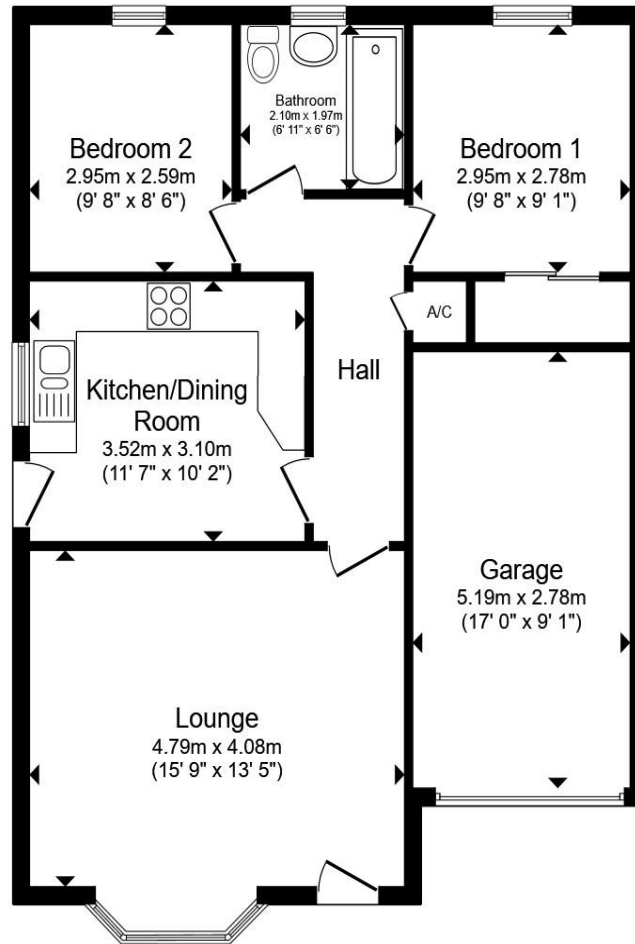

- Lounge**
- Hallway**
- Kitchen / Diner**
- Bedroom One**
- Bedroom Two**
- Bathroom**
- Garage**

Total floor area 76.2 m² (820 sq.ft.) approx

This floor plan is for illustrative purposes only. It is not drawn to scale. Any measurements, floor areas (including any total floor area), openings and orientation are approximate. No details are guaranteed, they cannot be relied upon for any purpose and they do not form part of any agreement. No liability is taken for any error, omission or misstatement. A party must rely upon its own inspection(s). Powered by www.propertybox.io



Welcome to

Donington Park, Leverington Wisbech

- Two bedroom modern bungalow
- Fully modernised throughout
- Highly desirable Donington Park location
- Quiet cul-de-sac position
- Modern fitted kitchen
- Off road parking
- Garage
- Enclosed rear garden

Tenure: Freehold EPC Rating: Awaited
Council Tax Band: B

£210,000



Please note the marker reflects the
postcode not the actual property

view this property online [williamhbrown.co.uk/Property/WSB128380](https://www.williamhbrown.co.uk/Property/WSB128380)



Property Ref:
WSB128380 - 0002

1. MONEY LAUNDERING REGULATIONS Intending purchasers will be asked to produce identification documentation at a later stage and we would ask for your co-operation in order that there is no delay in agreeing the sale. 2. These particulars do not constitute part or all of an offer or contract. 3. The measurements indicated are supplied for guidance only and as such must be considered incorrect. Potential buyers are advised to recheck measurements before committing to any expense. 4. We have not tested any apparatus, equipment, fixtures or services and it is in the buyers interest to check the working condition of any appliances. 5. Where an EPC, or a Home Report (Scotland only) is held for this property, it is available for inspection at the branch by appointment. If you require a printed version of a Home Report, you will need to pay a reasonable production charge reflecting printing and other costs. 6. We are not able to offer an opinion either written or verbal on the content of these reports and this must be obtained from your legal representative. 7. Whilst we take care in preparing these reports, a buyer should ensure that his/her legal representative confirms as soon as possible all matters relating to title including the extent and boundaries of the property and other important matters before exchange of contracts.

William H Brown is a trading name of Sequence (UK) Limited which is registered in England and Wales under company number 4268443, Registered Office is Cumbria House, 16-20 Hockliffe Street, Leighton Buzzard, Bedfordshire, LU7 1GN. VAT Registration Number is 500 2481 05.



william h brown



01945 464451



Wisbech@williamhbrown.co.uk



20 High Street, WISBECH, Cambridgeshire,
PE13 1DE



[williamhbrown.co.uk](https://www.williamhbrown.co.uk)