 paulwallace

Hoecroft, Nazeing, EN9 2RD |  
£415,000 | Freehold

## Key features

- Three bedroom family home
- Spacious lounge
- Conservatory
- Front and rear gardens
- Quiet cul-de-sac location
- Modern kitchen/diner
- Family bathroom
- Garage en-bloc with parking

## Property Information

Tenure  
Freehold

Council Tax  
D

EPC Rating  
D

Local Authority  
Epping Forest District Council

Lease Length

Service Charge & Ground Rent  
TRC



 paulwallace  
estate agents

[hoddesdon@paulwallace.co.uk](mailto:hoddesdon@paulwallace.co.uk)

01992 466471





 paulwallace



 paulwallace



 paulwallace



 paulwallace

GROUND FLOOR  
501 sq.ft. (46.5 sq.m.) approx.

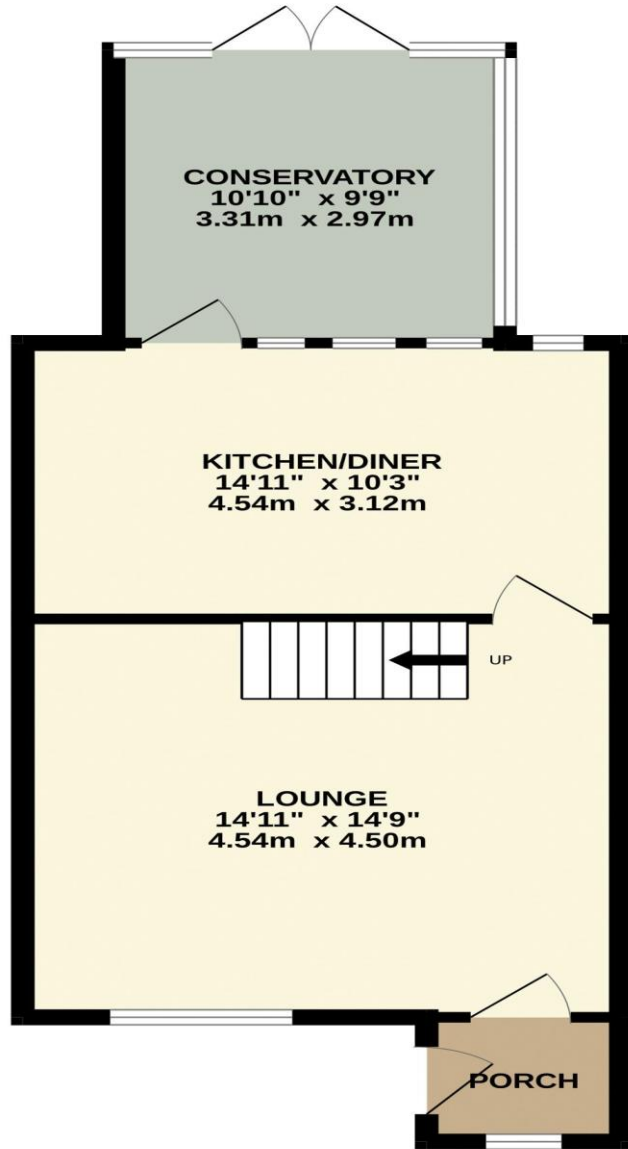

1ST FLOOR  
372 sq.ft. (34.6 sq.m.) approx.

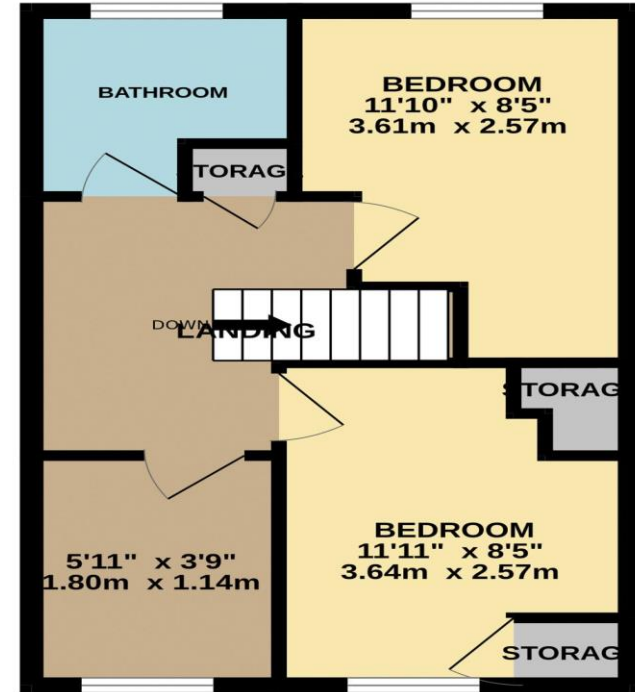

TOTAL FLOOR AREA : 873 sq.ft. (81.1 sq.m.) approx.

Whilst every attempt has been made to ensure the accuracy of the floorplan contained here, measurements of doors, windows, rooms and any other items are approximate and no responsibility is taken for any error, omission or mis-statement. This plan is for illustrative purposes only and should be used as such by any prospective purchaser. The services, systems and appliances shown have not been tested and no guarantee as to their operability or efficiency can be given.  
Made with Metropix ©2026







## Paul Wallace Estate Agents

70 High Street  
Hoddesdon  
Hertfordshire  
EN11 8ET

 01992 466471

 [hoddesdon@paulwallace.co.uk](mailto:hoddesdon@paulwallace.co.uk)

 [www.paulwallace.co.uk](http://www.paulwallace.co.uk)



## Opening Times

Mon	9am to 6.30pm
Tues	9am to 6.30pm
Wed	9am to 6.30pm
Thurs	9am to 6.30pm
Fri	9am to 6.30pm
Sat	9am to 5.00pm
Sun	Closed



Agents Note: Whilst every care has been taken to prepare these sales particulars, they are for guidance purposes only. All measurements are approximate and are for general guidance purposes only and whilst every care has been taken to ensure their accuracy, they should not be relied upon. Potential buyers are advised to recheck the measurements.