



9 Kenelm Close,
Clifton upon Teme, Worcestershire, WR6 6EB

HS
HOLLINGSTONE



OUTSIDE

The property is approached via a private driveway, providing off-road parking and access to the garage. The outside space is designed with ease of maintenance in mind, offering a manageable yet enjoyable setting.

THE PROPERTY

An attractive semi-detached bungalow, quietly positioned within a small cul-de-sac in the highly sought-after rural village of Clifton upon Teme.

The property offers well-proportioned and thoughtfully arranged accommodation, comprising a kitchen and a generous living room, providing a light and comfortable space for everyday living. There are two well-sized double bedrooms and a bathroom, all presented in a clean and well-maintained condition.

The bungalow offers an excellent opportunity for a purchaser to personalise and enhance to their own taste, whilst enjoying a home that is ready for immediate occupation.





SITUATION

Clifton upon Teme is a particularly desirable village located in the heart of the Teme Valley. The village is well regarded for its strong community and attractive rural surroundings. Local amenities include a village shop, primary school and public house, whilst the surrounding countryside offers excellent walking and riding opportunities.

Clifton-upon-Teme Primary School sits within the village. Secondary schooling is available at The Chantry School in Martley, with additional state options nearby.

The nearby market towns of Tenbury Wells and Bromyard, together with the city of Worcester, provide a broader range of shopping, schooling and leisure facilities.

SERVICES

Mains water, electricity and drainage are connected. Heating is provided via electric night storage heaters.

(Services have not been tested)

COUNCIL TAX BAND

C

VIEWING

Strictly by appointment through the sole agents, Hollingstone Ltd.

Kenelm Close, Worcester, WR6

Approximate Area = 668 sq ft / 62 sq m
 Garage = 131 sq ft / 12.2 sq m
 Total = 799 sq ft / 74.2 sq m

For identification only - Not to scale

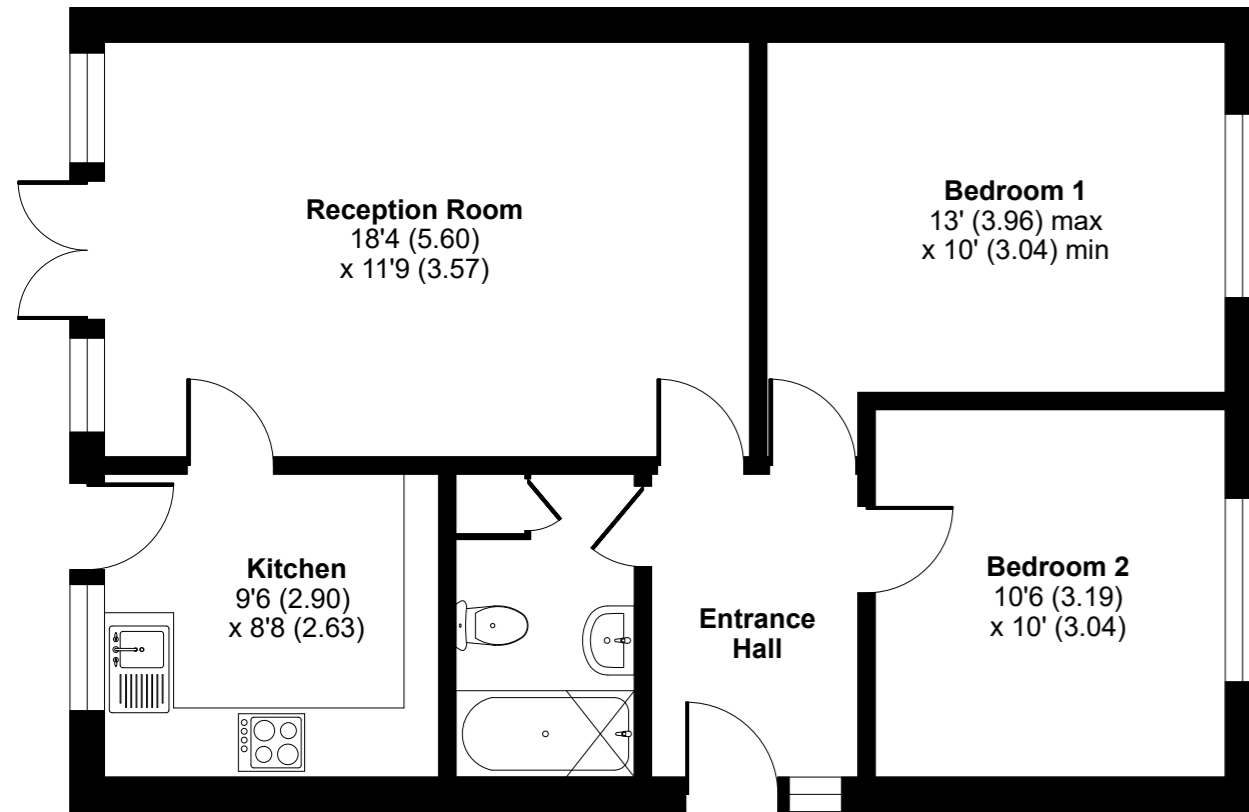
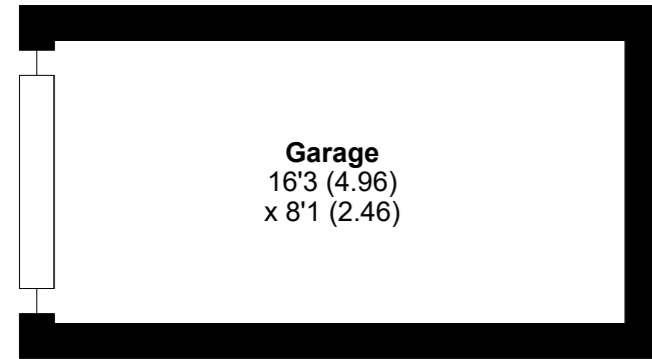

GROUND FLOOR

Floor plan produced in accordance with RICS Property Measurement 2nd Edition, Incorporating International Property Measurement Standards (IPMS2 Residential). © nichecom 2026. Produced for Hollingstone. REF: 1442522

Score	Energy rating	Current	Potential
92+	A		
81-91	B		86 B
69-80	C		
55-68	D	55 D	
39-54	E		
21-38	F		
1-20	G		

Please note:

Hollingstone Ltd give notice that: 1. They have no authority to make or give any representation or warranty on any property whether on their own behalf or on behalf of their clients or otherwise. 2. They do not owe any duty of care to you and assume no responsibility for any statements, representations, warranties or otherwise made in the particulars and you should not rely on those in the particulars. 3. The particulars are produced in good faith, are set out as a general guide only and do not constitute or form an offer or a contract or part thereof. 4. Any photographs, descriptions, plans, measurements, distances and any other details in the particulars are approximate estimates only taken as the property appeared at the time and should not be relied upon as factually accurate. 5. Hollingstone assumes prospective purchasers have carried out inspections to satisfy themselves that the information in the particulars is correct. Particulars dated April 2026. Photographs dated April 2026.





Agriculture | Rural Business | Residential

The Piggery,
Upper Holling Farm,
Martley,
Worcester,
WR6 6PU

T: 07891 996962
E: josie@hollingstone.co.uk