



Guide Price
£125,000

Leasehold

2x  1x  1x 

**Kingston House,
Kingston Cresc,
Portsmouth, Hampshire,
PO2**

OVER 60?

Secure this property
for up to **59% less!**

cubitt&west
Helping you move forwards

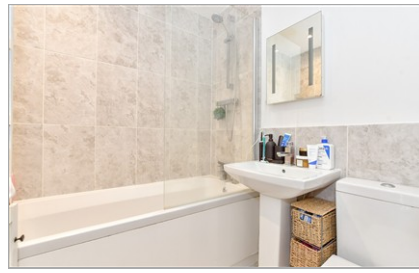

Main features

- Perfect for first time buyers or investors
- Allocated parking space
- Close to local shops and transport links
- Open plan living with modern decor
- Lift in the building

Accommodation

THIRD FLOOR

Entrance Hallway

Lounge/Kitchen: 15'9 x 11'8 (4.80m x 3.56m)

Bedroom 1: 12'4 x 11'3 (3.76m x 3.43m)

Bedroom 2: 12'8 x 7'6 (3.86m x 2.29m)

Bathroom: 5'7 x 5'5 (1.70m x 1.65m)

OUTSIDE

Allocated Parking

Third Floor

Approx. 40.5 sq. metres (436.4 sq. feet)

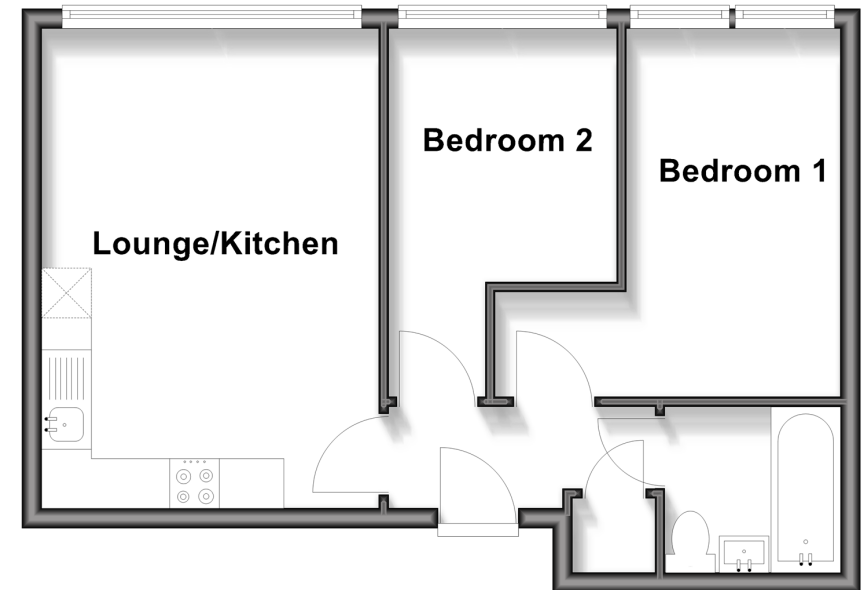

Call Portsmouth - 023 9266 1213 ■ cubittandwest.co.uk

- A private rental licensing scheme applies to some properties in this area, please check with the Local Authority before proceeding
- Appliances & services are untested, dimensions are approximate and floor plans are not to scale

- Legal advice should be taken to verify fixtures/fittings, planning, alterations and/or lease details
- Through a Homewise Home For Life Plan people aged 60+ can secure this property for up to 59% less, by purchasing a Lifetime Lease