



# HILLFIELD HOUSE

Liveridge Hill, Henley-in-Arden, Warwickshire



## COUNTRY HOME WITH LAND AND OUTSTANDING POTENTIAL

Situated on the edge of Henley-in-Arden, offering the perfect blend of peaceful countryside living and convenient town access with land in all about 10.47 acres.



Local Authority: Stratford-on-Avon District Council

Council Tax band: G

Tenure: Feehold



## SITUATION

Henley-in-Arden, a historic medieval market town, is home to a variety of shops, restaurants, public houses, and recreational facilities, including a fine parish church. The town features two primary schools and a choice of excellent state and private schools nearby, as well as top grammar schools in Stratford-upon-Avon.

Well-connected for commuters, Henley-in-Arden is just 8 miles from the M40 (J15), 7 miles from Warwick Parkway Station with direct trains to London Marylebone, and 15 miles from Birmingham International Airport. The area is also well-served by a local commuter train to Birmingham.

Henley-in-Arden 1 mile, Warwick Parkway Station 7 miles (trains to Marylebone from 90 minutes), M40 (J15) 8 miles, Warwick 8 miles (distances and time approximate).

## THE PROPERTY

Hillfield House is a sizeable and impressive residence in a beautiful location, with panoramic views. Rarely does a home of such scale, setting and opportunity become available, making this a compelling prospect for those seeking a picturesque rural lifestyle with scope to personalise and enhance to their own tastes.

A welcoming entrance hall provides access to the principal ground-floor rooms, including an elegant drawing room, a well-proportioned dining room, and a spacious dining kitchen, ideal for family living and entertaining. Practicality is well catered for with a utility room, laundry and cloakroom, ensuring the ground floor flows effortlessly for modern-day to-day life.

The upper floors offer extensive, flexible accommodation. The principal bedroom has superb views and is supported by three further bedrooms, three bathrooms, and a dedicated home office/further sitting room, offering excellent versatility for family living, visiting guests, or those working from home.



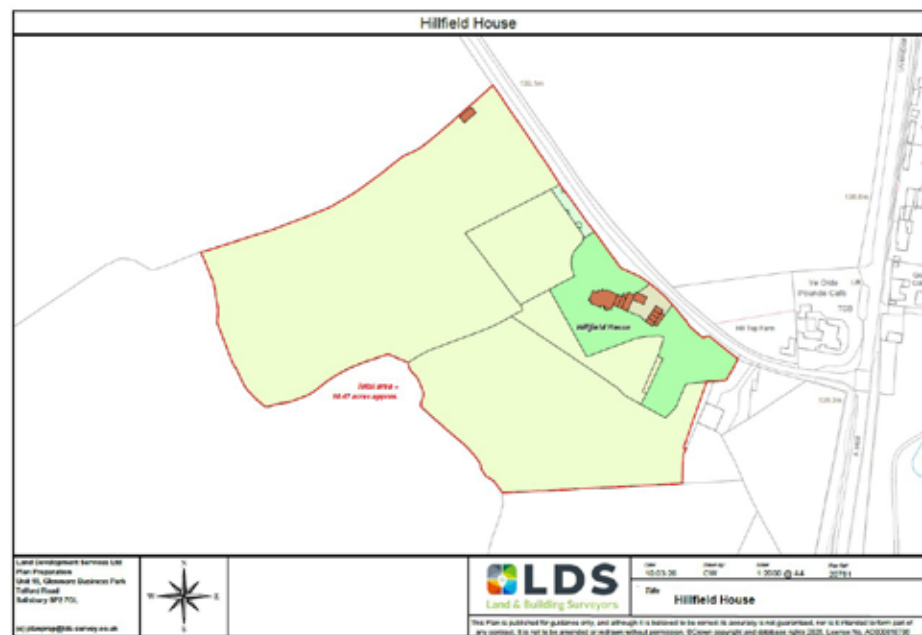

Outside, a large gated driveway provides a fitting approach and leads to a double garage, the stables, a triple garage block with a store, and a variety of additional outbuildings. Together, these offer immense potential for hobbies, storage, workshops, or future development (subject to the necessary consents).

The formal gardens are delightful, beautifully complementing the house, while the land, totalling in all about 10.47 acres, ensures the property works exceptionally well for those with equestrian or smallholding interests, or simply for those seeking space and privacy in a glorious country setting.

Services: Oil fired central heating. Private drainage. Electricity connected. Well-fed water to the house which is also connected to the mains.

What 3 words: [///projects.september.upsetting](http://projects.september.upsetting)



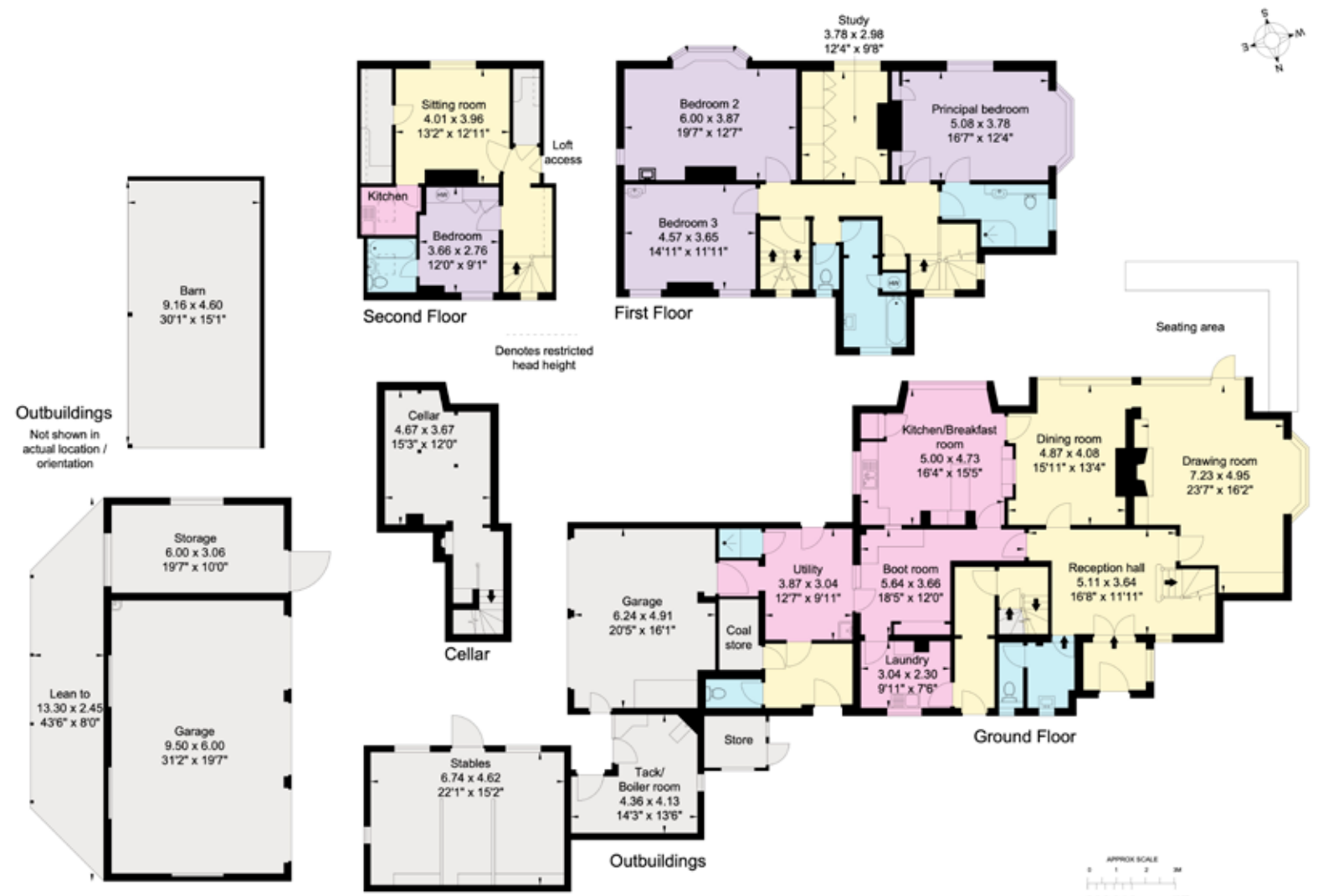

This plan is for guidance only and must not be relied upon as a statement of fact. Attention is drawn to the Important Notice on the last page of text of the Particulars.

**Hillfield House  
Henley-in-Arden**

**APPROXIMATE GROSS INTERNAL FLOOR AREA:**  
 House: 366 sq m (3,941 sq ft)  
 Outbuildings: 231 sq m (2,488 sq ft)  
 Total: 597 sq m (6,429 sq ft)  
 inc. restricted head height  
 © Cotswold Plans Ltd ma/16482



Will Ward-Jones  
 01789 297735  
 william.ward-jones@knightfrank.com

**Knight Frank Stratford-upon-Avon**  
 Bridgeway House, Bridgeway  
 Stratford-upon-Avon, Warwickshire, CV37 6YX

[knightfrank.co.uk](http://knightfrank.co.uk)

Your partners in property

1. Particulars: These particulars are not an offer or contract, nor part of one. You should not rely on statements given by Knight Frank in the particulars, by word of mouth or in writing ("information") as being factually accurate about the property, its condition or its value. Neither Knight Frank nor any joint agent has any authority to make any representations about the property, and accordingly any information given is entirely without responsibility on the part of Knight Frank. 2. Material Information: Please note that the material information is provided to Knight Frank by third parties and is provided here as a guide only. While Knight Frank has taken steps to verify this information, we advise you to confirm the details of any such material information prior to any offer being submitted. If we are informed of changes to this information by the seller or another third party, we will use reasonable endeavours to update this as soon as practical. 3. Photos, Videos etc: The photographs, property videos and virtual viewings etc. show only certain parts of the property as they appeared at the time they were taken. Areas, measurements and distances given are approximate only. 4. Regulations etc: Any reference to alterations to, or use of, any part of the property does not mean that any necessary planning, building regulations or other consent has been obtained. A buyer must find out by inspection or in other ways that these matters have been properly dealt with and that all information is correct. 5. Fixtures and fittings: A list of the fitted carpets, curtains, light fittings and other items fixed to the property which are included in the sale (or may be available by separate negotiation) will be provided by the Seller's Solicitors. 6. VAT: The VAT position relating to the property may change without notice. 7. To find out how we process Personal Data, please refer to our Group Privacy Statement and other notices at <https://www.knightfrank.com/legals/privacy-statement>.

Particulars dated March 2026. Photographs and videos dated March 2026. All information is correct at the time of going to print. Knight Frank is the trading name of Knight Frank LLP. Knight Frank LLP is a limited liability partnership registered in England and Wales with registered number OC305934. Our registered office is at 55 Baker Street, London W1U 8AN. We use the term "partner" to refer to a member of Knight Frank LLP or an employee or consultant. A list of members names of Knight Frank LLP may be inspected at our registered office. If you do not want us to contact you further about our services then please contact us by either calling 020 3544 0692, email to [marketing.help@knightfrank.com](mailto:marketing.help@knightfrank.com) or post to our UK Residential Marketing Manager at our registered office (above) providing your name and address.



Date: 26 March 2026  
Our reference: STR012577988

## Hillfield House, Liveridge Hill, Henley-in-Arden, B95 5QT

We have pleasure in enclosing details of the above property for which we are quoting a guide price of **£1,450,000**.

Please let us know if you need any further information about the property or surrounding area and we will be delighted to provide it.

Full details of all our properties and a wide range of services can be viewed online at [knightfrank.co.uk](https://knightfrank.co.uk). You can also receive early information on new properties coming on to the market by signing up to [My Knight Frank](#).

For additional information or to make arrangements to view the property, please get in touch.

**We'd love to help you.**

Yours faithfully



**KNIGHT FRANK LLP**

Enc:

**William Ward-Jones**  
Partner, Office Head  
+44 1789206951  
[william.ward-jones@knightfrank.com](mailto:william.ward-jones@knightfrank.com)

**Knight Frank, Stratford**  
Bridgeway House, Bridgeway, Stratford upon Avon, CV37 6YX  
+44 1789 297 735

[knightfrank.co.uk](https://knightfrank.co.uk)

Your partners in property

Knight Frank LLP is a limited liability partnership registered in England and Wales with registered number OC305934. Our registered office is at 55 Baker Street, London W1U 8AN. We use the term 'partner' to refer to a member of Knight Frank LLP, or an employee or consultant. A list of members' names of Knight Frank LLP may be inspected at our registered office.

Regulated by RICS

V4.3 Sep 24