



THE OLD VICARAGE

Sevenhampton, Cheltenham GL54 5SW



CHURCH LANE, SEVENHAMPTON, CHELTENHAM, GL54 5SW

A beautiful edge of village former Vicarage with pretty gardens and
delightful rural views.

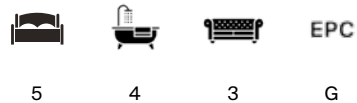

Local Authority: Cotswold District Council

Council Tax Band: G

Tenure: Freehold

Winchcombe 5 miles, Cheltenham 7 miles, Bourton-on-the-Water 11 miles, Oxford 39 miles, London 91 miles (all distances are approximate)

Guide Price: 3,000,000



THE PROPERTY

The Old Vicarage was built around 1850 for the Rev Edward Ellerton and is a charming Grade II listed Cotswold ashlar stone house adjacent to the church in the pretty village of Sevenhampton.

Approached through double electric wooden gates between stone piers, the drive terminates in a parking area to the front and side of the house. Immediately off to one side is a converted outbuilding, now a self-contained annexe, ideal as a home office or as staff/guest accommodation.









LIVING

From the house are delightful rural views over the grounds and hills beyond. The ground floor has three comfortable reception rooms off the central entrance hall, a well appointed kitchen with an Aga and central island which in turn leads out to the conservatory. This larger kitchen/living space makes a wonderful entertaining area with immediate access to the terrace and gardens beyond.







ACCOMMODATION

The accommodation is arranged over three floors with well-balanced ground and bedroom accommodation offering good ceiling heights across its five bedrooms and four bathrooms.







GARDEN AND OUTBUILDINGS

The gardens at The Old Vicarage are well laid out and beautifully maintained with the formal garden immediately adjacent to the house and contained within a pretty Cotswold stone wall. Beyond is the large paddock interspersed with specimen trees, ideal for walking dogs, games or keeping a pony.

There are various useful little outbuildings conveniently positioned around the house and gardens as well as store rooms and a gardeners' loo. The property extends to just under 2.5 acres in total.

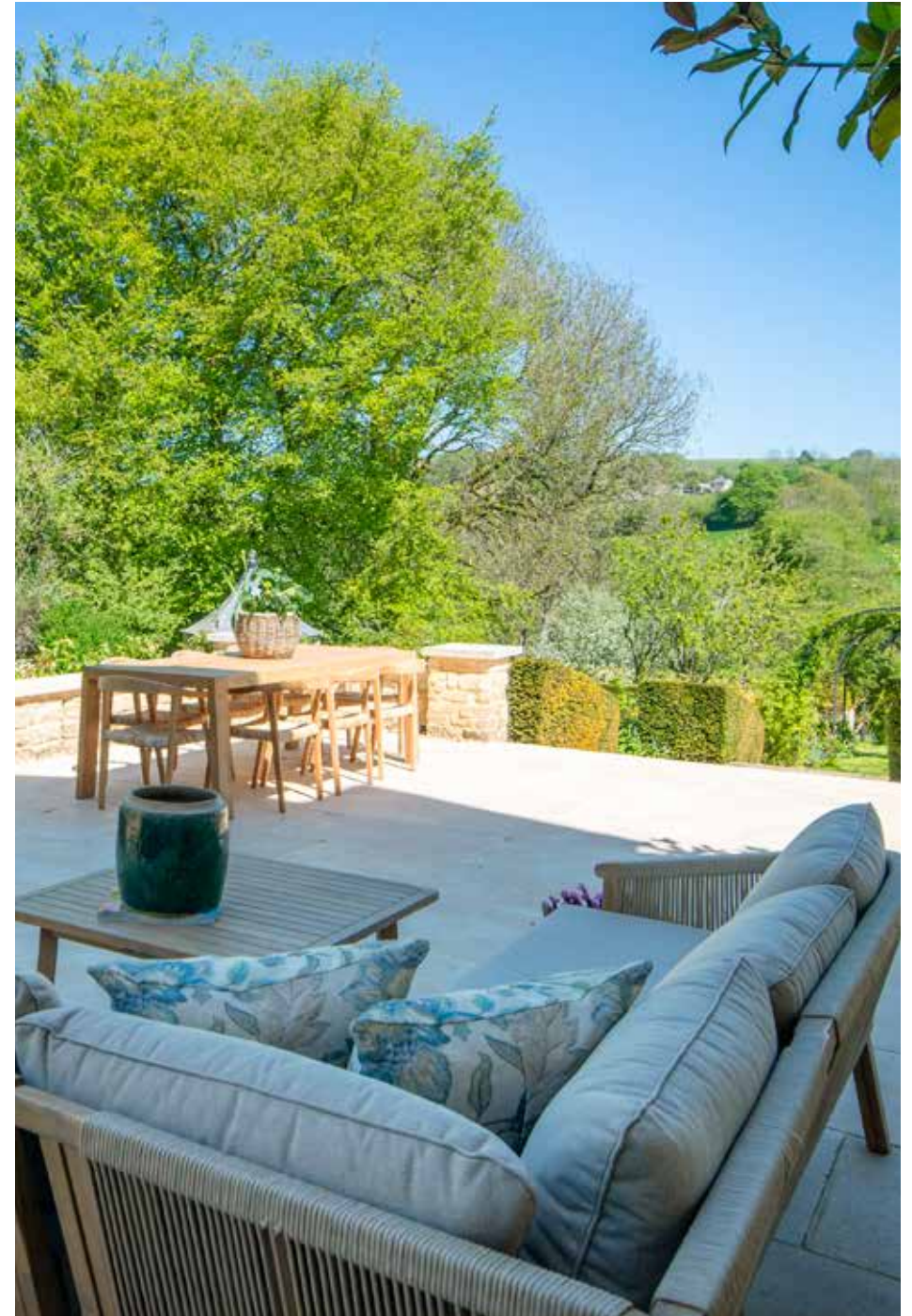

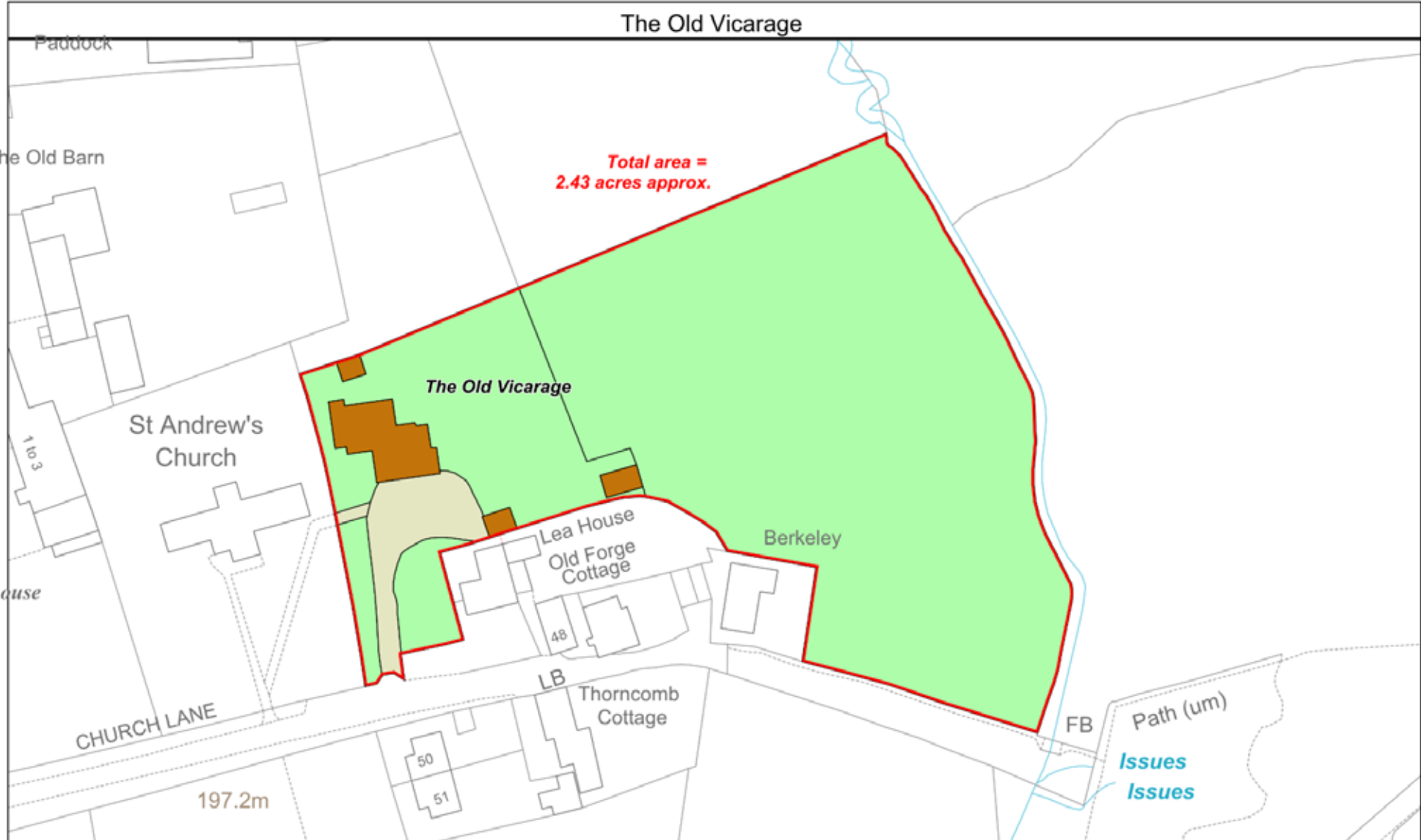

Knight Frank Mapping
 2 Lower Woodspen Court,
 Lambourne Road,
 Newbury RG20 8BL
 (t) 01488 688508
 (e) mapping@knightfrank.com



Date: 10:05:22 CW
 Drawn By: CW
 Scale: 1:1000 @ A4
 Plan Ref:

Title
The Old Vicarage

This Plan is published for guidance only, and although it is believed to be correct its accuracy is not guaranteed, nor is it intended to form part of any contract. ©Crown copyright and database rights 2022 Licence No. 100021721

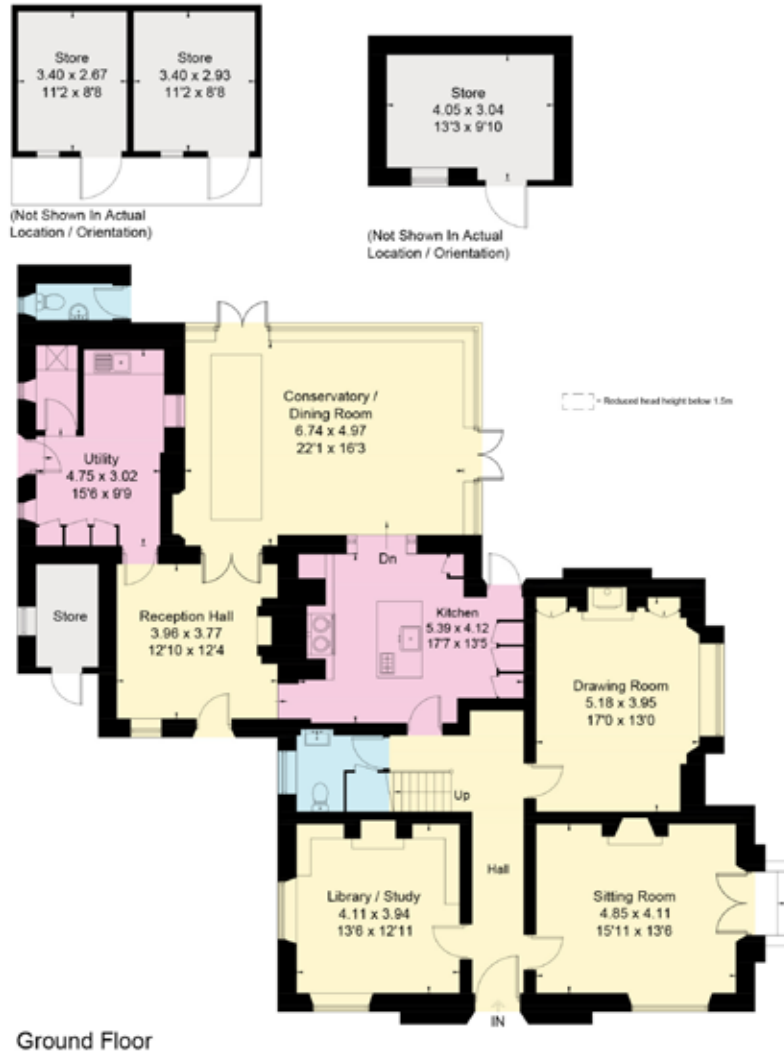

Second Floor



First Floor



Annex First Floor



Annex Ground Floor

Outbuildings and Annex Approx. gross internal area 771 Sq Ft. / 82 Sq M.
 Main House Approx. gross internal area 4141 Sq Ft. / 382 Sq M.
 Total Approx. gross internal area 5000 Sq Ft. / 464 Sq M.

This plan is for layout guidance only. Not drawn to scale unless stated. Windows and door openings are approximate. Whilst every care is taken in the preparation of this plan, please check all dimensions, shapes and compass bearings before making any decisions reliant upon them. (ID767266)



Tom Banwell

01242 246 951

tom.banwell@knightfrank.com

Knight Frank West Gloucestershire

123 Promenade

Cheltenham, GL50 1NW

knightfrank.co.uk

Your partners in property

1. Particulars: These particulars are not an offer or contract, nor part of one. You should not rely on statements given by Knight Frank in the particulars, by word of mouth or in writing ("information") as being factually accurate about the property, its condition or its value. Neither Knight Frank nor any joint agent has any authority to make any representations about the property, and accordingly any information given is entirely without responsibility on the part of Knight Frank. 2. Material Information: Please note that the material information is provided to Knight Frank by third parties and is provided here as a guide only. While Knight Frank has taken steps to verify this information, we advise you to confirm the details of any such material information prior to any offer being submitted. If we are informed of changes to this information by the seller or another third party, we will use reasonable endeavours to update this as soon as practical. 3. Photos, Videos etc: The photographs, property videos and virtual viewings etc. show only certain parts of the property as they appeared at the time they were taken. Areas, measurements and distances given are approximate only. 4. Regulations etc: Any reference to alterations to, or use of, any part of the property does not mean that any necessary planning, building regulations or other consent has been obtained. A buyer must find out by inspection or in other ways that these matters have been properly dealt with and that all information is correct. 5. Fixtures and fittings: A list of the fitted carpets, curtains, light fittings and other items fixed to the property which are included in the sale (or may be available by separate negotiation) will be provided by the Seller's Solicitors. 6. VAT: The VAT position relating to the property may change without notice. 7. To find out how we process Personal Data, please refer to our Group Privacy Statement and other notices at <https://www.knightfrank.com/legals/privacy-statement>.

Particulars dated March 2026. Photographs and videos dated September 2023. All information is correct at the time of going to print. Knight Frank is the trading name of Knight Frank LLP. Knight Frank LLP is a limited liability partnership registered in England and Wales with registered number OC305934. Our registered office is at 55 Baker Street, London W1U 8AN. We use the term 'partner' to refer to a member of Knight Frank LLP, or an employee or consultant. A list of members names of Knight Frank LLP may be inspected at our registered office. If you do not want us to contact you further about our services then please contact us by either calling 020 3544 0692, email to marketing.help@knightfrank.com or post to our UK Residential Marketing Manager at our registered office (above) providing your name and address.

