

## PERIOD HOMES

By Simon Miller



### Kenward Road

, Yalding ME18 6JR

- GUIDE PRICE: £525,000 - £550,000
- Three Bedrooms - Two Receptions - Two Bath/ Shower Rooms
- Pretty Garden, Driveway and Large Shed/Storage
- Charming Upgraded and Improved Period Cottage
- Open Plan Kitchen/ Oak Framed Conservatory
- Popular Kentish Village

**Guide Price £525,000 Freehold**

Local Authority  
Council Tax Band F  
EPC Rating C

Honeysuckle Cottage Kenward Road, Yalding, Maidstone, Kent  
Approximate Gross Internal Area  
Main House = 1177 Sq Ft/109 Sq M  
Outbuilding = 66 Sq Ft/6 Sq M  
Total = 1243 Sq Ft/115 Sq M

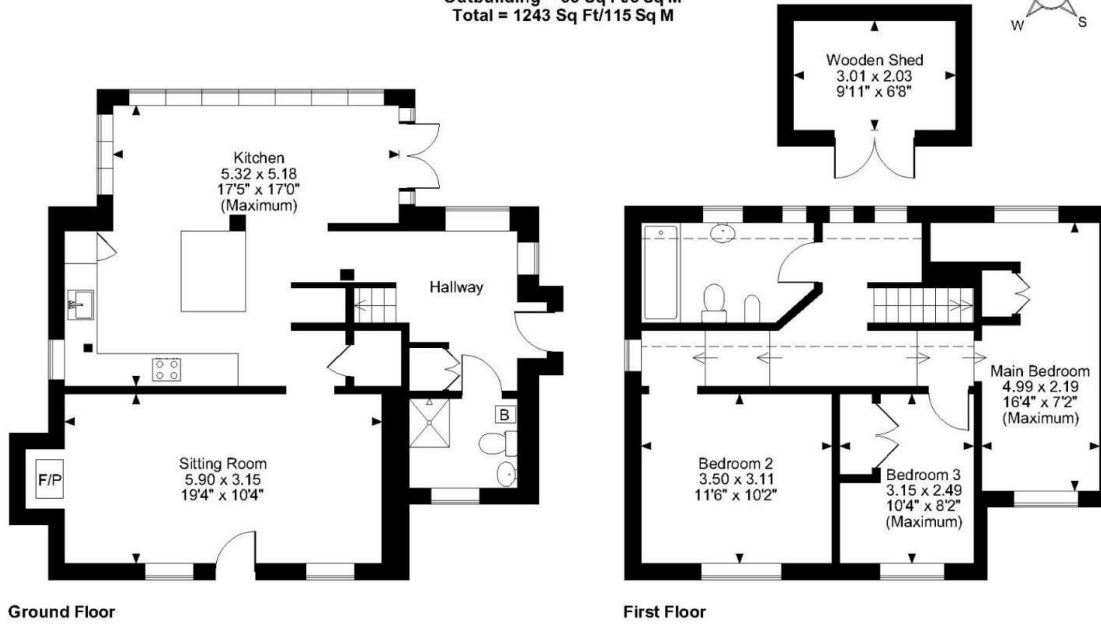

Ground Floor

First Floor

FOR ILLUSTRATIVE PURPOSES ONLY - NOT TO SCALE

The position & size of doors, windows, appliances and other features are approximate only.

□ □ □ □ Denotes restricted head height

© ehouse. Unauthorised reproduction prohibited. Drawing ref. dig/8593310/SLU



**Period Homes by Simon Miller Office**  
Weald, 5 High Street, Headcorn, Ashford,  
Kent, TN27 9NH

**Contact**

01622 850888  
admin@periodhomesbysimonmiller.co.uk  
<https://simonmiller.co.uk/period-homes/>

Agents Note: Whilst every care has been taken to prepare these particulars, they are for guidance purposes only. All measurements are approximate and for general guidance purposes only and whilst every care has been taken to ensure accuracy, they should not be relied upon and potential buyers/tenants are advised to recheck the measurements.

