

Mark Anthony

Estate Agents



The Gables Church Road, Wisbech St. Mary, Wisbech, PE13 4RJ
Offers in excess of £325,000





The Gables Church Road, Wisbech St. Mary, Wisbech, PE13 4RJ

Offers in excess of £325,000

Mark Anthony Estate Agents are delighted to be instructed to market The Gables, a stunning detached bungalow developed by local company Shrubland Estates. The property is located within the desirable village of Wisbech St. Mary with its excellent Local Shops, Post Office, Primary School and Public House.

The property was refurbished and extended to an extremely high standard to offer; a welcoming reception hallway, larger enough to be used as a study area, leading to a bespoke high end fitted kitchen with multiple Bosch integrated appliances set in a large open plan kitchen diner combined family room with bi folding doors accessing and overlooking the patio and rear garden, creating a great space for family living and entertaining. Three /four good size bedrooms and two luxury bathrooms one of which is ensuite to the master bedroom.

Other features include a large utility room, high quality flooring throughout, underfloor and radiator heating via an energy efficient heat source pump.

Lawned South East facing rear garden, gated driveway with ample parking and planning permission Ref F/YR22/094R/F for a Car port.

Viewing is recommended to fully appreciate this wonderful, quality family home.

In compliance with the Estate Agents Act we notify any interested parties there is a connection between the seller and Mark Anthony Estate Agents.

- Stunning bungalow in the desirable village of Wisbech St. Mary
- Refurbished and extended to an extremely high standard
- Bespoke high end fitted kitchen with multiple Bosch integrated appliances
- Open plan kitchen diner combined family room with bi folding doors
- Three / four goodsize bedrooms
- Ensuite shower room and family bathroom
- EPC Rating: C
- Large utility room
- Energy efficient heat source pump
- Viewing is recommended



Floor Plans

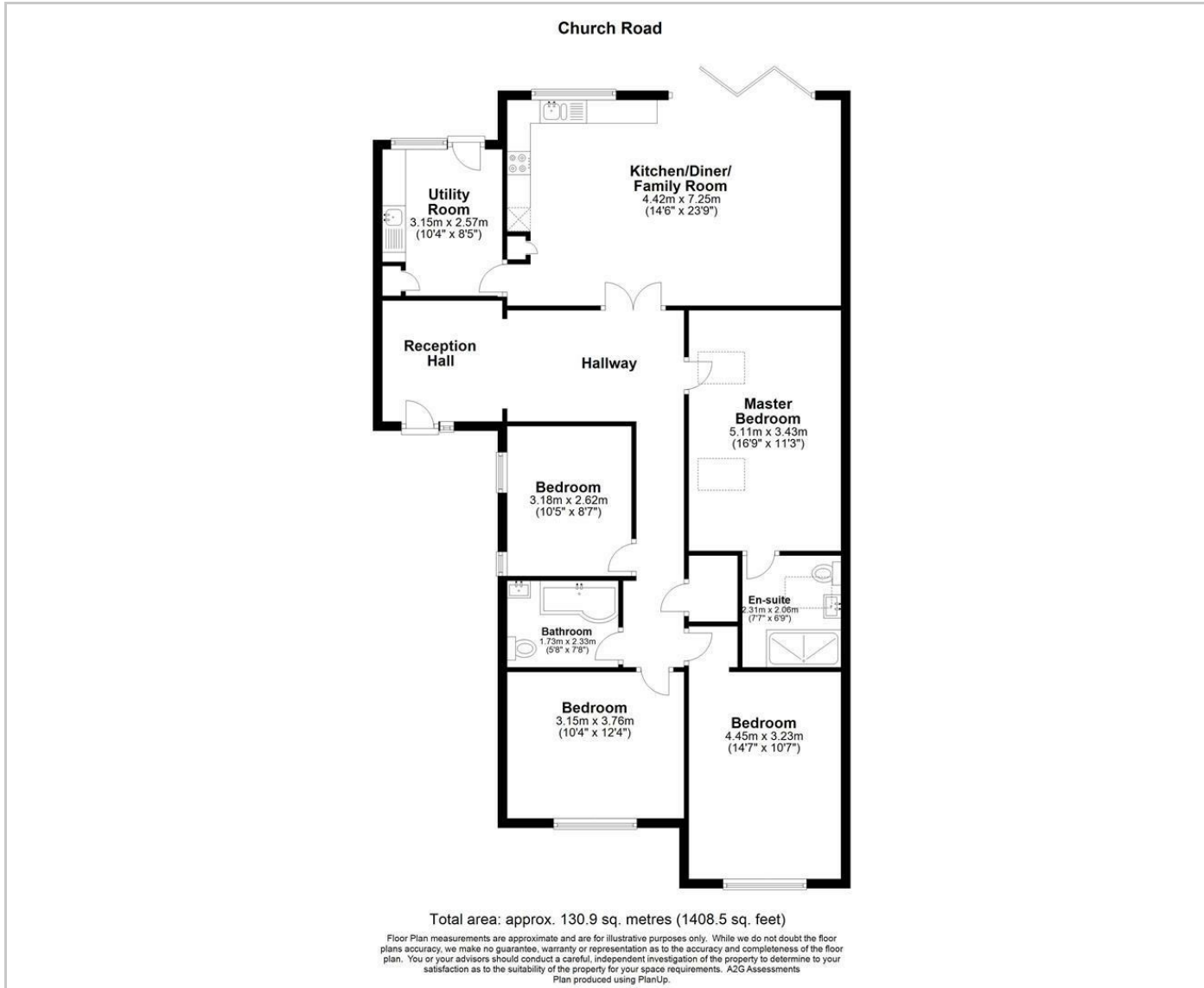

Area Map

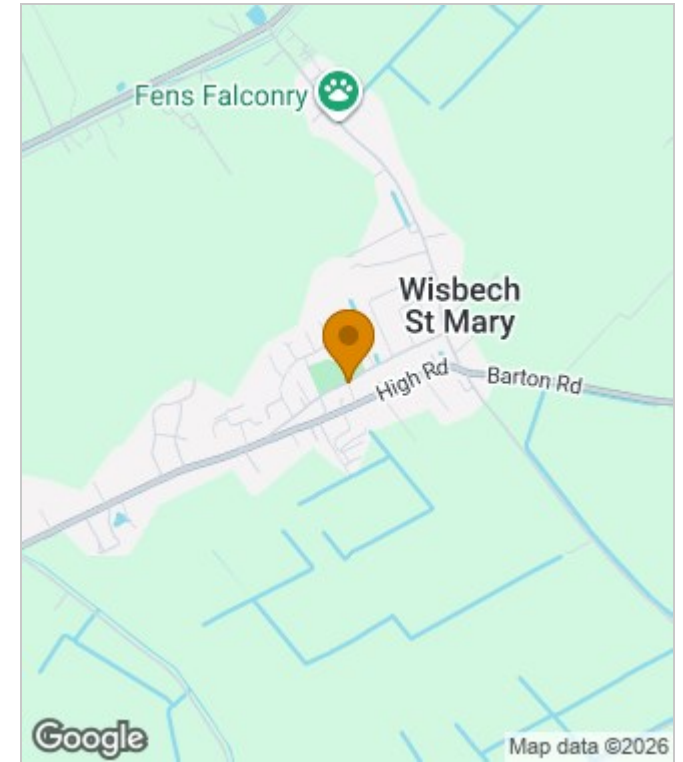

Energy Performance Graph

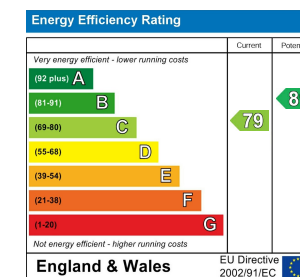

These particulars, whilst believed to be accurate are set out as a general outline only for guidance and do not constitute any part of an offer or contract. Intending purchasers should not rely on them as statements of representation of fact, but must satisfy themselves by inspection or otherwise as to their accuracy. No person in this firm's employment has the authority to make or give any representation or warranty in respect of the property.

Mark Anthony Estate Agents 28 High Street, Ewell, Surrey, KT17 1RW

Tel: 02083937275 Email: mark@markanthonystateagents.co.uk <https://www.markanthonystateagents.co.uk>