



OFFERS OVER

**£280,000**

**Cottesmore Close**  
Great Sankey, WA5 3UN



## PROPERTY SUMMARY

FANTASTIC LOCATION \* QUIET CUL-DE-SAC \* CLOSE TO SCHOOLS AND TRANSPORT LINKS \*

Nestled in the desirable area of Great Sankey, Cottesmore Close presents an exceptional opportunity to acquire a modern mid-terrace house. This charming three-bedroom townhouse offers ample space for comfortable living.

Upon entering, you are welcomed into a well-appointed reception room, perfect for both relaxation and entertaining. The property boasts three generously sized bedrooms, providing plenty of room for family or guests. With three bathrooms, including en-suite facilities, convenience and privacy are assured for all occupants.

The exterior of the home features a low-maintenance garden with astro turf to the rear, allowing you to enjoy outdoor space without the hassle of extensive upkeep. Additionally, the property includes a car charging port, catering to the needs of modern living and environmentally conscious residents.

3



3



1













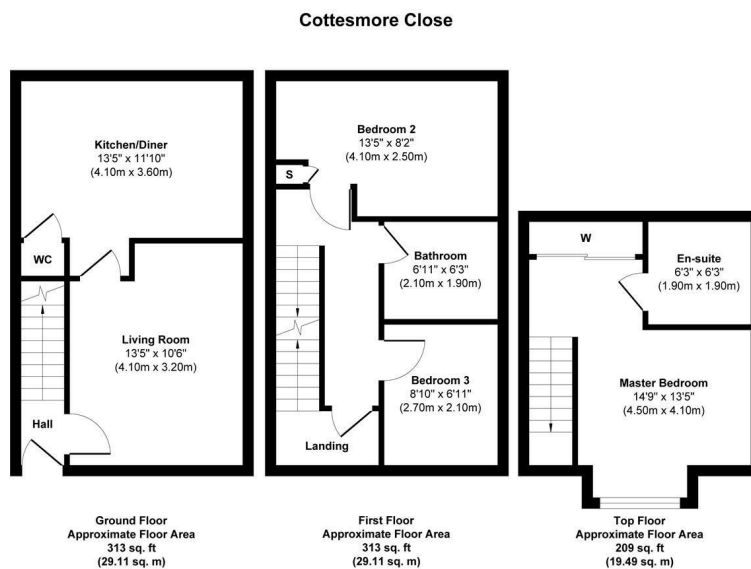

**Approx. Gross Internal Floor Area 835 sq. ft / 77.71 sq. m**  
Illustration for identification purposes only, measurements are approximate, not to scale.  
Produced by Elements Property

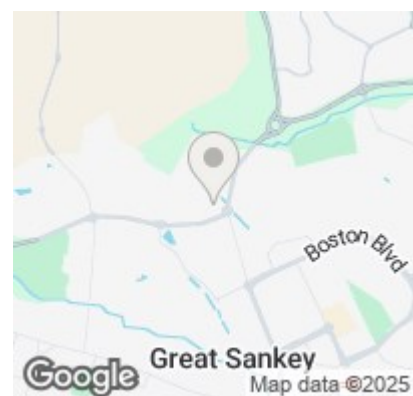
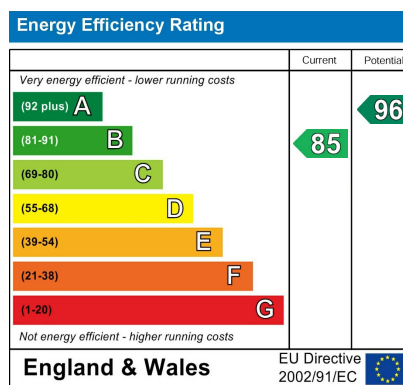
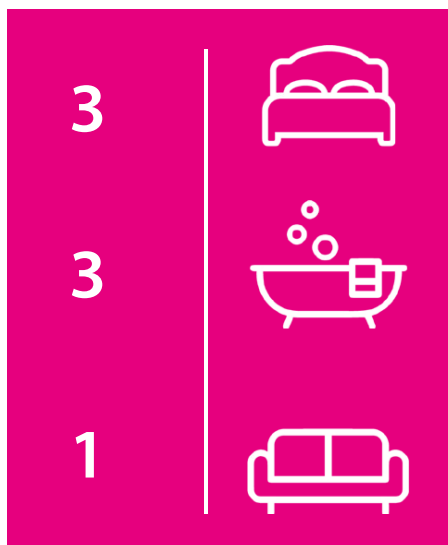

**Agents Note:** Whilst every care has been taken to prepare these particulars, they are for guidance purposes only. All measurements are approximate and are for general guidance purposes only and whilst every care has been taken to ensure their accuracy, they should not be relied upon and potential buyers/tenants are advised to recheck the measurements.



**OFFICE ADDRESS**  
The Hive Sankey Street  
Warrington  
WA1 1XG

**OFFICE DETAILS**  
01925 987 085  
info@real5estates.com  
www.real5estates.com