



HEARTWOOD
HOMES

Wain Close, St Albans, AL1 1AW

£450,000

🛏️ 2 🚿 2 🚗 1



A truly superb top floor apartment, this beautifully designed home is set within an intimate and highly sought after development just moments from London Road, offering stylish, modern living in a prime St Albans location.

Immaculately presented throughout, the apartment offers a spacious thoughtfully arranged accommodation, perfectly blending high quality finishes with everyday practicality. The heart of the home is the impressive open plan living space, where a bright and airy lounge flows seamlessly into a sleek, contemporary kitchen fitted with a range of high spec integrated appliances, including a dishwasher, fridge/freezer, oven, hob and washer/dryer.

Natural light floods the space through an array of windows, skylights and full height double doors, which open onto a private balcony creating the perfect spot to relax or entertain.

The property offers two generous double bedrooms, both featuring bespoke fitted wardrobes, with the principal bedroom further benefiting from a stylish en suite shower room. A second modern bathroom provides additional convenience for guests or family.

Ideally positioned within easy reach of the vibrant city centre and within walking distance of the mainline station, this exceptional apartment is perfectly suited to professionals, commuters or those seeking a high quality home in a convenient and well connected setting.

Early viewing is highly recommended.



2ND FLOOR
699 sq.ft. (64.9 sq.m.) approx.

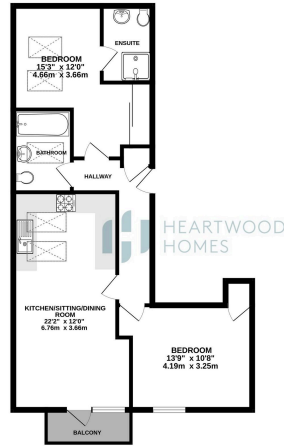

TOTAL FLOOR AREA: 699 sq.ft. (64.9 sq.m.) approx.
While every effort has been made to ensure the accuracy of the floor plan, measurements of actual rooms, areas and heights are not guaranteed and are for general guidance only. The actual layout and specifications may vary from those shown and are subject to change without notice.



- Stunning top floor apartment within a sought-after and intimate development
- Contemporary kitchen with high-spec integrated appliances
- Private balcony accessed via full-height double doors
- Additional modern bathroom ideal for guests or family use
- Close proximity to motorway access
- A spacious and beautifully designed, modern living space
- Bright and spacious open-plan lounge/kitchen/dining area
- Two generous double bedrooms with bespoke fitted wardrobes
- Easy access to both the City Centre and City Station
- EPC Grade B

