



WARE & CO
estate and letting agents

58 Batt Drive, Cheddon Fitzpaine – TA2 8FY
£325,000

58 Batt Drive

Cheddon Fitzpaine, Taunton

- Immaculately presented three-storey end of terrace home
- Spacious and well appointed accommodation throughout
- Open plan kitchen/dining/family room with garden access
- First floor living room
- Separate study/home office
- Principal bedroom with en suite shower room
- Two double guest bedrooms
- Ground floor cloakroom/WC
- Private enclosed rear garden with patio and lawn
- Driveway parking and garage to the rear

TOTAL FLOOR AREA 113 sq.m.

TENURE Freehold. There is an annual charge for upkeep of public areas, bins etc to Pinnacle Property Management. This fee was £222.57 (June '25 to June '26).

COUNCIL TAX Council Tax Band D. Charges payable for 2026/27 - £2,467.01

SERVICES Main services of gas, electricity, water and drainage are connected. Broadband speeds of upto 1800 mbps are available and good mobile signal across the for main networks (source: Ofcom).

EPC Energy Efficiency Rating: B





An immaculately presented and deceptively spacious three-storey end of terrace home, offering superbly appointed accommodation throughout, ideal for modern family living. Benefitting from drive parking and a garage to the rear, along with a private enclosed garden, this exceptional property must be viewed to be fully appreciated.

The accommodation is thoughtfully arranged over three floors. On entering, a welcoming entrance hall provides access to a useful cloaks cupboard and a separate ground floor WC. There is also a versatile study, ideal for home working or as a snug. To the rear, the impressive open plan kitchen/dining/family room forms the heart of the home, beautifully fitted and offering ample space for both dining and relaxing, with double doors opening directly onto the rear garden—perfect for entertaining and indoor-outdoor living.

The first floor hosts a spacious and light-filled living room, providing a comfortable retreat, alongside the principal bedroom which benefits from a stylish en suite shower room.

On the second floor are two further generously sized double bedrooms, both well-proportioned and served by a modern family bathroom.

Externally, the property enjoys a private enclosed rear garden, laid predominantly to lawn with a patio area ideal for al fresco dining. To the rear, there is the added advantage of off-road parking and a garage with electric.

This superb home combines space, style, and practicality in a highly desirable location. Early viewing is strongly recommended to fully appreciate the quality of accommodation and excellent finish on offer.



GROUND FLOOR
398 sq.ft. (37.0 sq.m.) approx.

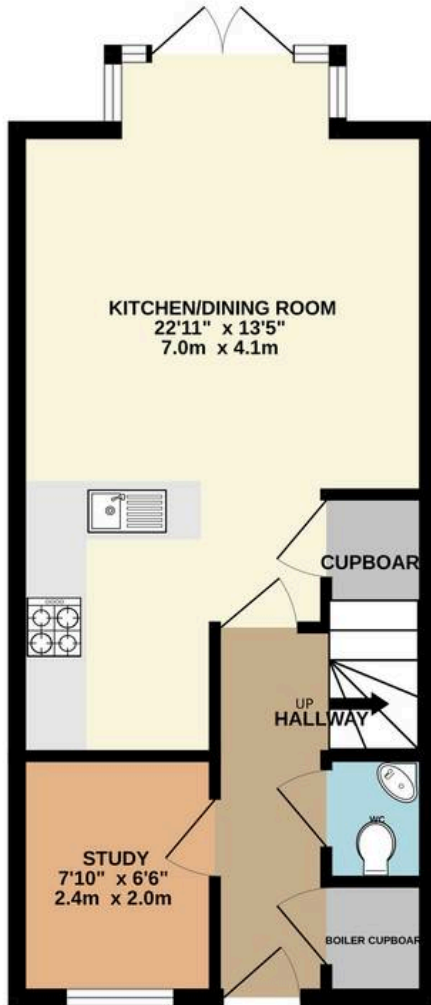

1ST FLOOR
380 sq.ft. (35.3 sq.m.) approx.

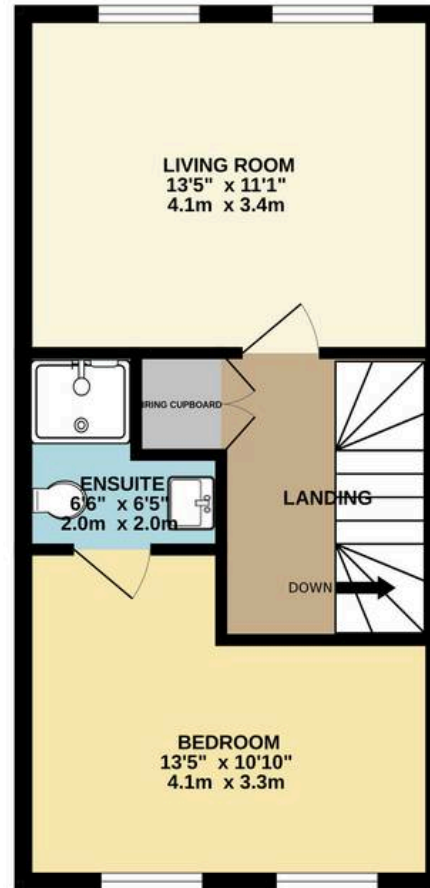

2ND FLOOR
380 sq.ft. (35.3 sq.m.) approx.

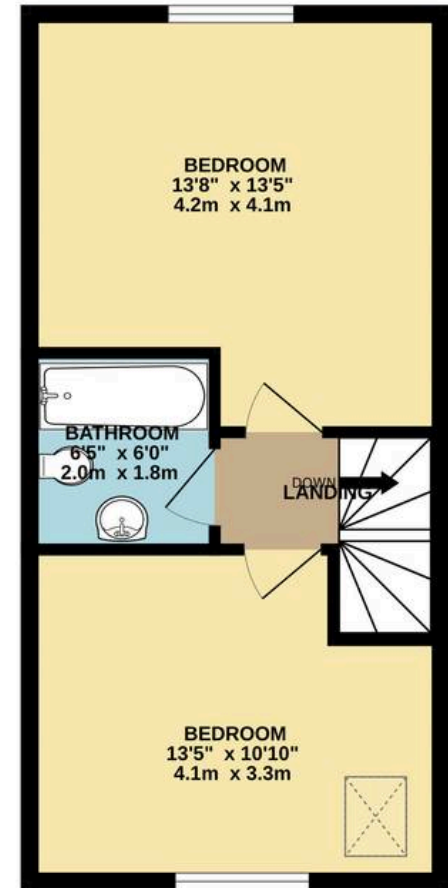

TOTAL FLOOR AREA : 1159 sq.ft. (107.7 sq.m.) approx.

Whilst every attempt has been made to ensure the accuracy of the floorplan contained here, measurements of doors, windows, rooms and any other items are approximate and no responsibility is taken for any error, omission or mis-statement. This plan is for illustrative purposes only and should be used as such by any prospective purchaser. The services, systems and appliances shown have not been tested and no guarantee as to their operability or efficiency can be given.
Made with Metropix ©2026



Ware & Co

Ware & Co, 53 Bridge Street - TA1 1TP

01823259604 • info@wareandco.com • www.wareandco.com

