



Dobree Avenue, NW10

Freehold - £1,450,000

Exclusively marketed by Camerons Stiff is this substantial five-bedroom detached 1930s home that offers a rare opportunity to purchase an extensive family house in one of the area's most desirable residential pockets, just above Queen's Park and Kensal Rise.

The house offers generous proportions with large rooms typical of the period. The current layout is more compartmentalised, offering clear scope to reconfigure into a contemporary open-plan arrangement. Internally, the property would benefit from modernisation, presenting a strong opportunity for a new owner to personalise. Externally, a large private driveway provides off-street parking for up to three vehicles along with a south-facing 61 ft rear garden that offers generous outdoor space and potential to extend both sideways (into the garage) and rearward (STPP).

Close to vibrant nearby areas; residents enjoy a variety of independent shops, cafes on College Road and Chamberlayne Road and the green outdoor space of King Edward VII Park. Transport links include Kensal Rise (Mildmay Zone 2) & Willesden Green (Jubilee Zone 2). Early viewing is thoroughly recommended.



020 7328 2828

enquiries@cameronsstiff.co.uk

cameronsstiff.co.uk





Dobree Avenue, London, NW10

APPROX. GROSS INTERNAL FLOOR AREA 2240 SQ FT 208.1 SQ METRES (INCLUDES GARAGE/ STORE)

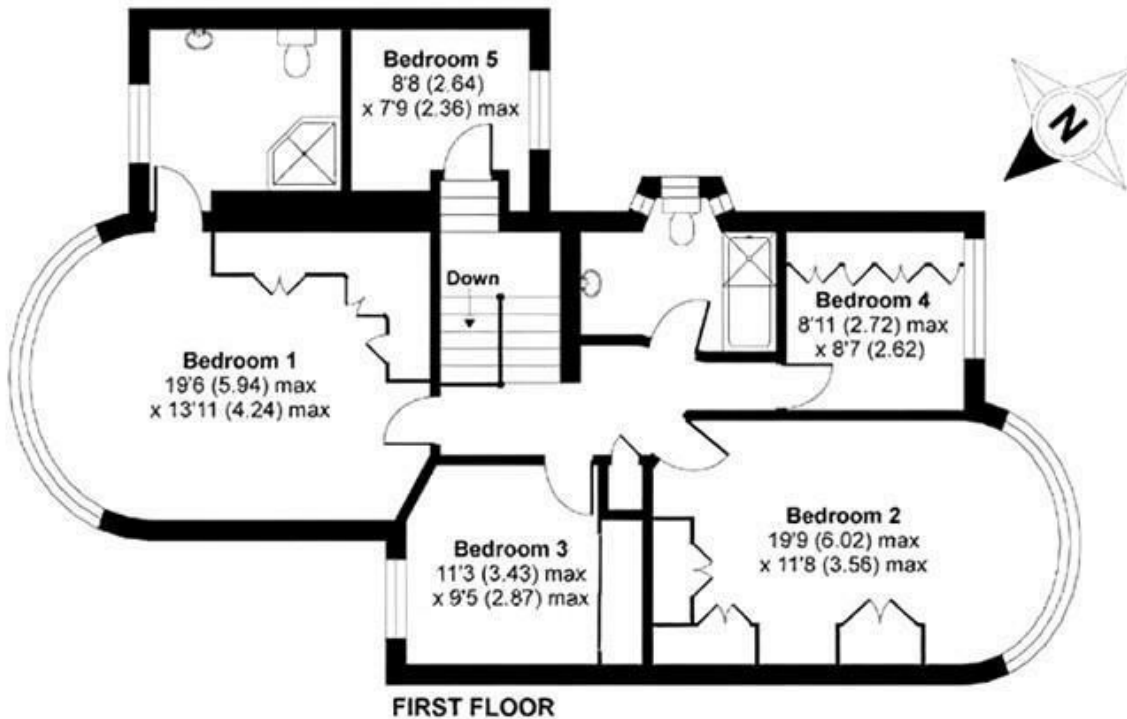

EPC: D

Ref: 15063929

Whilst every attempt has been made to ensure the accuracy of the floor plan contained here, measurements of doors, windows and rooms are approximate and no responsibility is taken for any error, omission or misstatement. These plans are for representation purposes only as defined by RICS Code of Measuring Practice and should be used as such by any prospective purchaser. Specifically no guarantee is given on the total square footage of the property if quoted on this plan. Any figure given is for initial guidance only and should not be relied on as a basis of valuation.

Copyright nichecom.co.uk

Produced for Camerons Stiff & Co REF : 389373

