

ELLIS HAY

COMMERCIAL



68 Victoria Road

Scarborough, YO11 1SF

£650 Per Calendar Month

A lock-up retail unit close to Scarborough's Town Centre. This ground-floor unit is currently laid out with a retail area with office space and storage behind. The unit also has a staff kitchen and WC. This property would be suitable for a variety of uses, subject to planning approval.



LOCATION

Situated on a busy thoroughfare leading to Scarborough's Town Centre. There is a car park adjacent and on street parking nearby

DESCRIPTION

The unit benefits from a large display window and a glazed double-door leading to the main retail area. The office area is at the rear of the property which has access to the store room, kitchen and WC.

COSTS

The tenant is responsible for their own legal costs and may be asked for a contribution to the landlord's costs

TERMS

The unit is available to lease for a term to be negotiated at a rent of £7800pa

BUSINESS RATES

Rateable value £6900. Interested parties are advised to confirm with the local taxation department what the exact rates payable will be

SERVICES

Mains supplies of water, electric. Prospective tenants are advised to satisfy themselves regarding services connected.

VIEWING

Via ELLIS HAY

Area Map



GROUND FLOOR

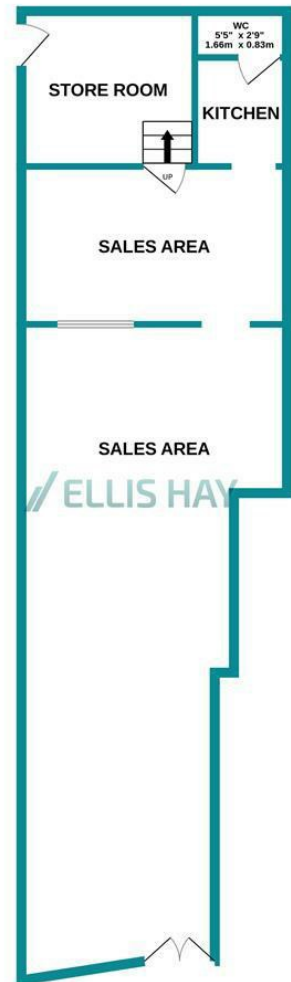

Whilst every attempt has been made to ensure the accuracy of the floorplan contained here, measurements of doors, windows, rooms and any other items are approximate and no responsibility is taken for any error, omission or mis-statement. This plan is for illustrative purposes only and should be used as such by any prospective purchaser. The services, systems and appliances shown have not been tested and no guarantee as to their operability or efficiency can be given.
Made with Metropix ©2023

Ellis Hay for themselves, for any joint agents and for the vendors or lessors of this property whose agents they are, give notice that (i) all the particulars are set out as a general outline only for the guidance of intending purchasers or lessees, and do not constitute, nor constitute part of, an offer or contract; (ii) all descriptions, dimensions, references to condition and necessary permissions for use and occupation, and other details are given in good faith and are believed to be correct but any intending purchasers or tenants should not rely on them as statements or representations of fact but must satisfy themselves by inspection or otherwise as to the correctness of each of them; (iii) no person in the employment of Ellis Hay, has any authority to make or give any representation or warranty whatever in relation to this property