

GROUND FLOOR  
936 sq.ft. (87.0 sq.m.) approx.

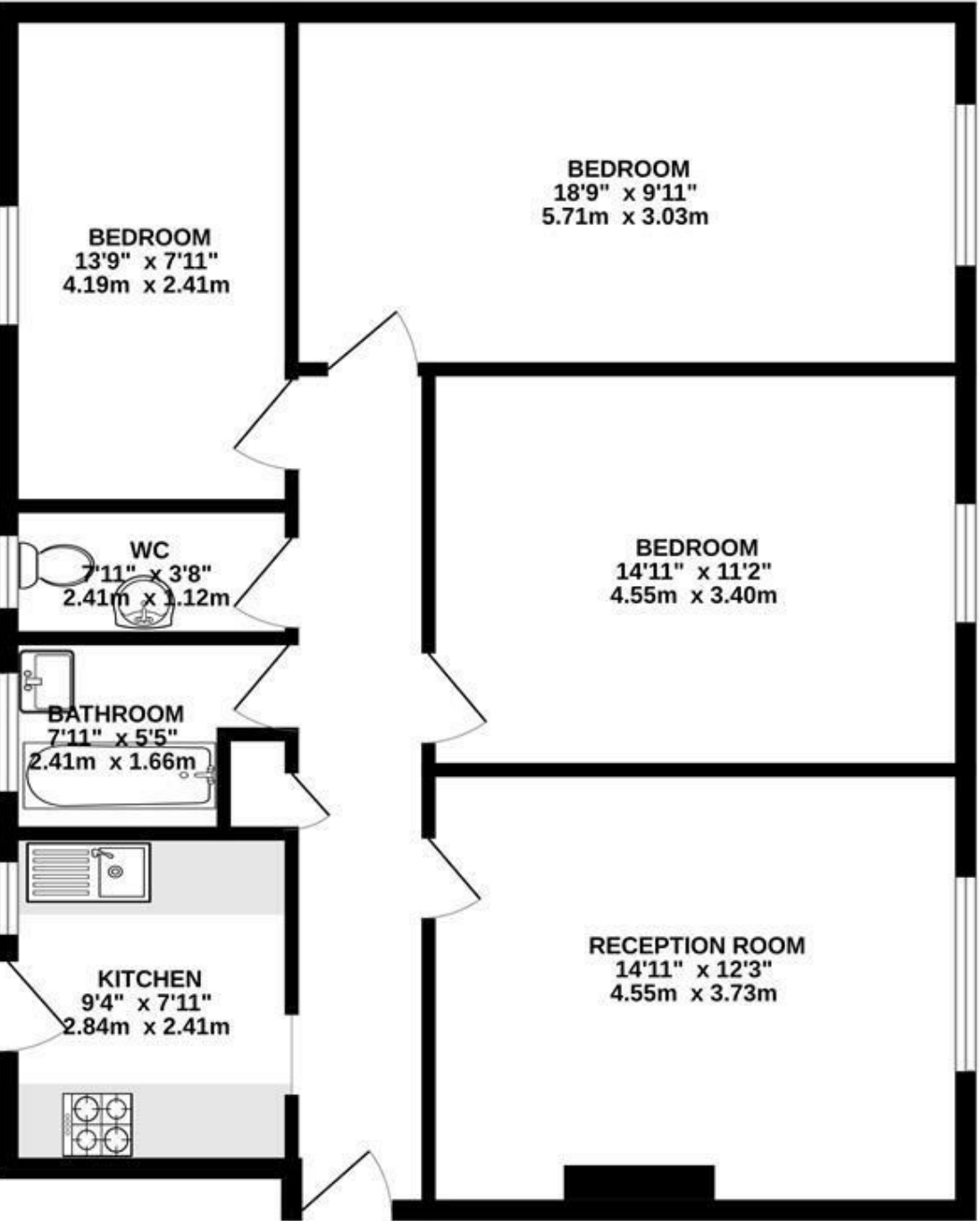

HENDON PARK MANSIONS, NW4

TOTAL FLOOR AREA : 936 sq.ft. (87.0 sq.m.) approx.

Whilst every attempt has been made to ensure the accuracy of the floorplan contained here, measurements of doors, windows, rooms and any other items are approximate and no responsibility is taken for any error, omission or mis-statement. This plan is for illustrative purposes only and should be used as such by any prospective purchaser. The services, systems and appliances shown have not been tested and no guarantee as to their operability or efficiency can be given.  
Made with Metropix ©2023

Gravity Estates  
18 Golders Green Road, London, NW11 8LL  
02083570810 sales@gravity-estates.com

GRAVITY  
estates

Gravity Estates  
18 Golders Green Road, NW11 8LL  
02083570810  
sales@gravity-estates.com  
www.gravity-estates.com



Queens Road, London, NW4 2TG

A beautifully modernised 3 bed ground floor apartment. Situated in a fantastic location, just 2 minutes from Hendon Central Tube Station (Northern Line) and just across the road is the beautiful green space, Hendon Park. Comprising 3 spacious bedrooms, luxury bathroom with heated towel rail, and separate w/c. The reception room is very spacious and has a feature fireplace and the fitted kitchen has a door providing direct access to rear communal gardens. The flat boasts impressive lighting throughout.

The lease has been renewed and is offered chain free.

Leasehold

£550,000



