



4 Bed  
House - Mid  
Terrace  
located in

£2,500 Per month



TAYLOR  
MICHAEL  
STUDENTS

# Washington Street, Brighton, BN2 9SR

Approximate Gross Internal Area = 87.8 sq m / 945 sq ft

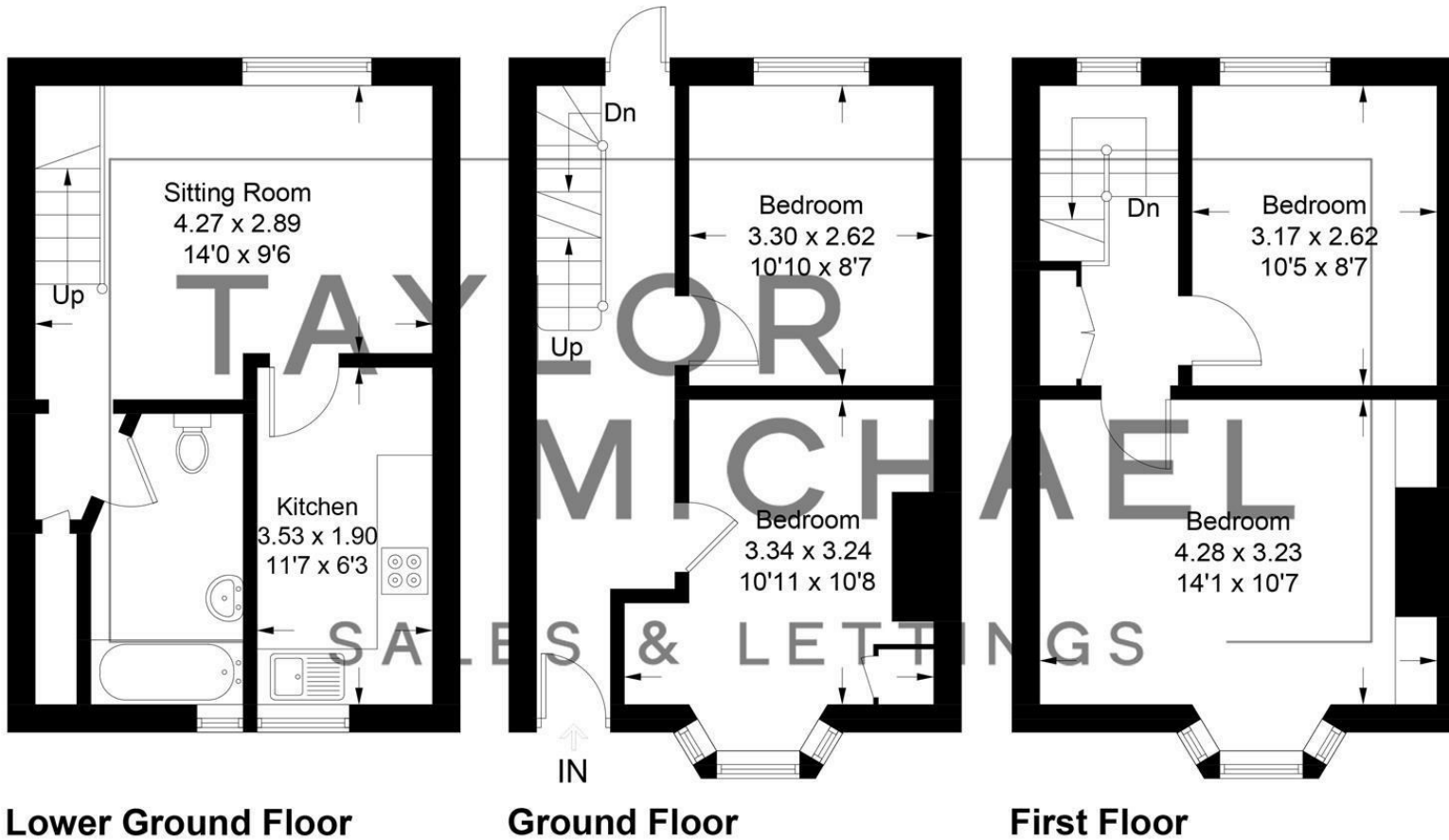
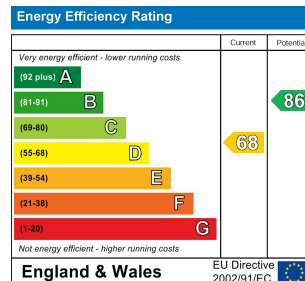

Illustration for identification purposes only, measurements are approximate, not to scale.  
Imageplansurveys @ 2026



## DIRECTIONS

## CONTACT

62 Church Road  
Hove  
East Sussex  
BN3 2FP

E: [lettings@taylormichael.agency](mailto:lettings@taylormichael.agency)  
T:  
<https://taylormichael.agency/>

**TAYLOR  
MICHAEL**  
STUDENTS