



## 2 Watts Cottages Grosvenor Road

Kennington Ashford, TN24 9PL

Price £275,000

A most attractive terraced home in the popular Kennington area of Ashford, offered for sale with no onward chain.

Set back from the road, this charming property offers a cosy sitting room with wood burning stove, kitchen, ground floor bathroom and two first floor bedrooms. Modern double glazing is installed along with gas fired central heating, an enclosed rear garden and parking for one car.

Highly regarded schools are within easy reach as are a wide range of shopping and leisure facilities with many delightful countryside walks nearby.

### Viewing

Please contact our Ashford Office on 01233 646411 if you wish to arrange a viewing appointment for this property or require further information.

- CHARACTERFUL TERRACED COTTAGE
- SET BACK FROM THE ROAD
- TWO BEDROOMS
- SITTING ROOM WITH WOOD BURNING STOVE
- POPULAR KENNINGTON LOCATION
- GAS CENTRAL HEATING & DOUBLE GLAZING
- ALLOCATED PARKING AREA
- NO ONWARD CHAIN



2



1



1



C



Floor Plan

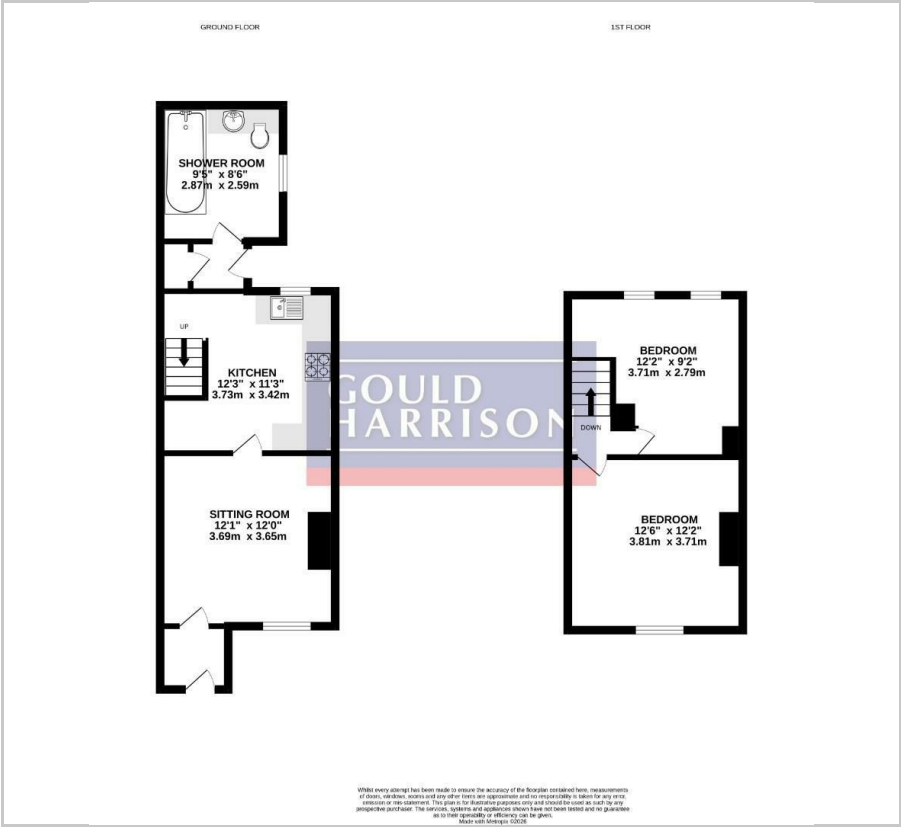

Area Map



Energy Efficiency Graph

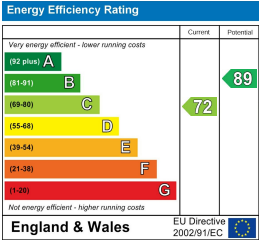

These particulars, whilst believed to be accurate are set out as a general outline only for guidance and do not constitute any part of an offer or contract. Intending purchasers should not rely on them as statements of representation of fact, but must satisfy themselves by inspection or otherwise as to their accuracy. No person in this firm's employment has the authority to make or give any representation or warranty in respect of the property.