



Connells

Barton Hill Drive
Minster On Sea Sheerness



Property Description

Connells are delighted to offer this well-presented two-bedroom property to the market. This inviting terraced home features a spacious lounge, kitchen, wet room, along with two comfortable bedrooms that provide a flexible space suitable for a small family, couple, or home office setup. The property is enhanced by convenient allocated parking, ensuring residents have easy access and peace of mind.

Nestled in the desirable and popular area of Minster, the property is just a short distance from an array of local amenities, including shops, schools, and is only a short stroll to the picturesque beach. It's an ideal setting for those looking for both convenience and leisure, making it a perfect choice for those seeking a blend of comfort and practicality.

A standout feature of this charming residence is its attractive west-facing garden that basks in the afternoon and evening sun, providing the perfect spot for relaxation and outdoor enjoyment.









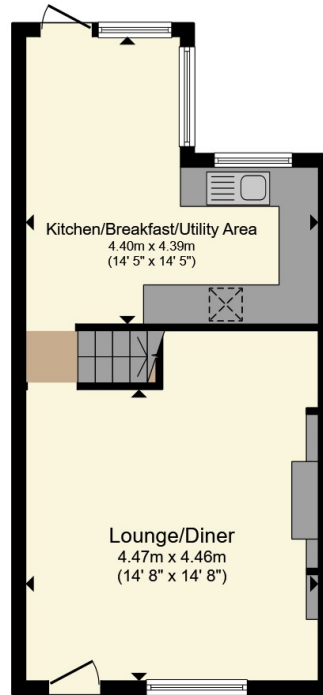

Ground Floor

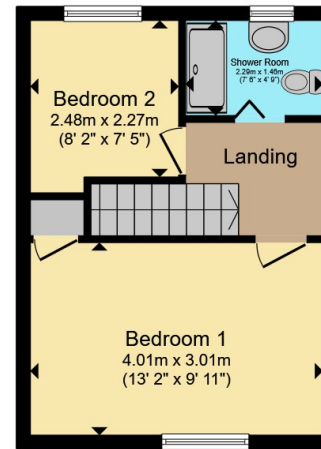

First Floor

Total floor area 68.2 m² (735 sq.ft.) approx

This floor plan is for illustrative purposes only. It is not drawn to scale. Any measurements, floor areas (including any total floor area), openings and orientation are approximate. No details are guaranteed, they cannot be relied upon for any purpose and they do not form part of any agreement. No liability is taken for any error, omission or misstatement. A party must rely upon its own inspection(s). Powered by www.propertybox.io



To view this property please contact Connells on

T 01795 477859
E sittingbourne@connells.co.uk

68 High Street
 SITTINGBOURNE ME10 4PB

EPC Rating: D Council Tax
 Band: B

Tenure: Freehold

view this property online connells.co.uk/Property/SIT104213



1. MONEY LAUNDERING REGULATIONS Intending purchasers will be asked to produce identification documentation at a later stage and we would ask for your co-operation in order that there will be no delay in agreeing the sale. 2. These particulars do not constitute part or all of an offer or contract. 3. The measurements indicated are supplied for guidance only and as such must be considered incorrect. Potential buyers are advised to recheck measurements before committing to any expense. 4. We have not tested any apparatus, equipment, fixtures, fittings or services and it is in the buyers interest to check the working condition of any appliances.

Connells Residential is registered in England and Wales under company number 1489613, Registered Office is Cumbria House, 16-20 Hockliffe Street, Leighton Buzzard, Bedfordshire, LU7 1GN. VAT Registration Number is 500 2481 05.

See all our properties at www.connells.co.uk | www.rightmove.co.uk | www.zoopla.co.uk

Property Ref: SIT104213 - 0006