

House - Terraced (EPC Rating:)

**SOULDERN STREET, WATFORD, WD18
0EU
PCM**

£1,650 PCM

2 Bedroom House - Terraced located in Watford

TWO BEDROOM HOUSE IN THE HEART OF WATFORD JUST 0.2 MILES TO WATFORD GENERAL HOSPITAL AND A 5 MINUTE WALK INTO WATFORD TOWN CENTRE - 2 PARKING PERMITS AVAILABLE AND AVAILABLE MARCH 2026

A superb 2 bedroom mid terrace family home located in a local conservation area, excellent decorative order with modern kitchen stunning rear garden and bedrooms and bathroom off the landing. Entered via the front door into a large hallway with access to both the lounge and Kitchen, with laminated flooring around the property.. The lounge has large windows to the front and rear making for a bright and airy reception. The kitchen has a range of fitted units at base level with integrated electric oven and gas hob, optional washing machine & free standing fridge freezer available too. The grey coloured stairs lead to the first floor. There are two double bedrooms and bathroom off the landing with the master having 2 large windows and a storage cupboard housing the boiler. The bathroom is part tiled with a coloured suite comprising a panel enclosed bath mixer taps and shower attachment. Low level w.c and wash hand basin. Outside: there is a small front garden but the rear garden has freestanding flower bed borders and a lovely seating area. There is outside storage which also has plumbing for a washing machine.

-0.2 MILES TO VICARAGE STADIUM - 0.2 WATFORD GENERAL HOSPITAL - 0.3 MILES TO WATFORD JUNCTION

-0.4 MILES TO WATFORD TOWN CENTRE - 0.4 MILES TO WATFORD GIRL GRAMMAR SECONDARY SCHOOL

-0.8 MILES TO WATFORD BOYS GRAMMAR SECONDARY SCHOOL - 0.8 MILES TO SAINBURY'S.

-0.9 MILES TO ALDI - 1.0 MILES TO WATFORD METROPOLITAN STATION.



WATFORD LETTINGS | 12 MARKET STREET, WATFORD, HERTFORDSHIRE, WD18 0PD

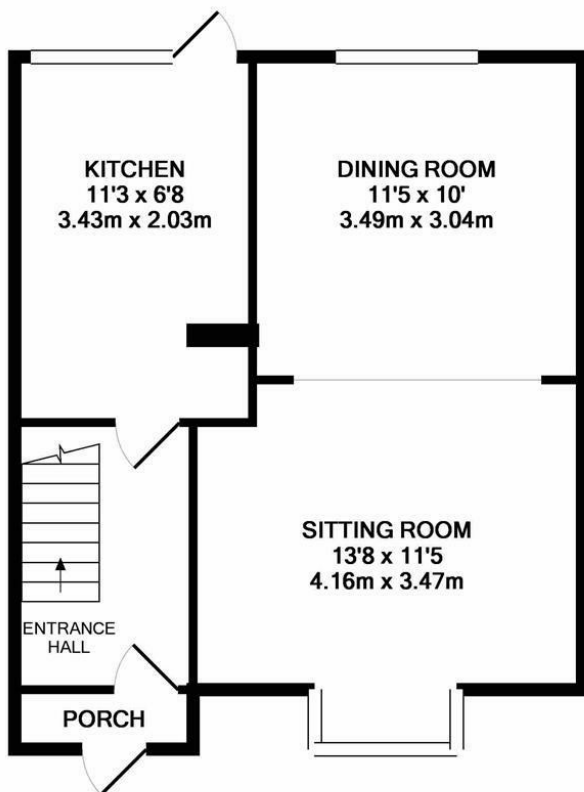

GROUND FLOOR
APPROX. FLOOR
AREA 516 SQ.FT.
(48.0 SQ.M.)

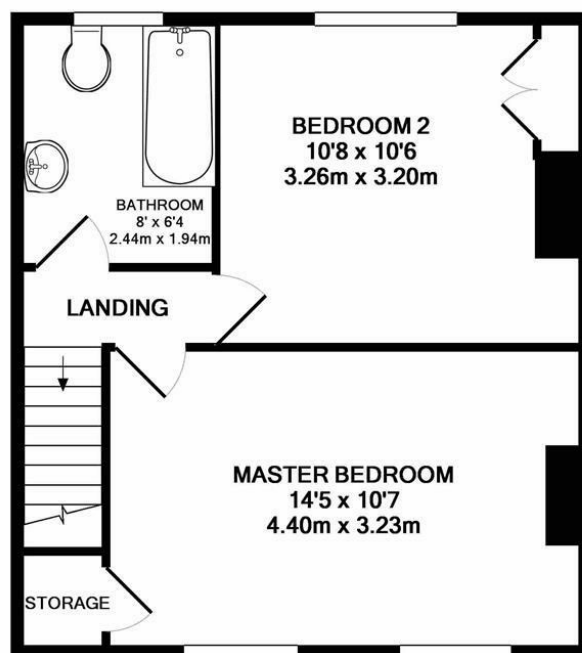

1ST FLOOR
APPROX. FLOOR
AREA 479 SQ.FT.
(44.5 SQ.M.)

SOULDERN STREET
TOTAL APPROX. FLOOR AREA 995 SQ.FT. (92.4 SQ.M.)

Whilst every attempt has been made to ensure the accuracy of the floor plan contained here, measurements of doors, windows, rooms and any other items are approximate and no responsibility is taken for any error, omission, or mis-statement. This plan is for illustrative purposes only and should be used as such by any prospective purchaser. The services, systems and appliances shown have not been tested and no guarantee as to their operability or efficiency can be given
Made with Metropix ©2019

Council Tax Band

Energy Performance Graph

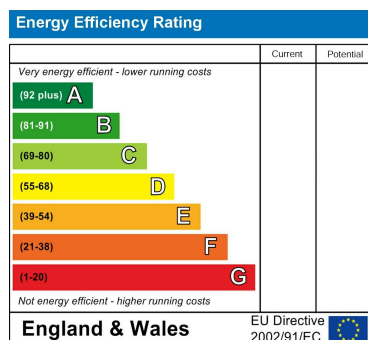

Call us on

01923 220 012

enquiries@warrenanthony.co.uk

www.warrenanthony.co.uk

Agents Note: Whilst every care has been taken to prepare these particulars, they are for guidance purposes only. All measurements are approximate and are for general guidance purposes only and whilst every care has been taken to ensure their accuracy, they should not be relied upon and potential buyers are advised to recheck the