

GUIDE PRICE

£290,000

Croydon Road

Westerham, TN16 1EU

PROPERTY SUMMARY

GUIDE PRICE £290,000 - £300,000 A ground floor two bedroom apartment with it's own private patio area overlooking communal gardens, situated in the heart of Westerham. The property is offered for sale in good order throughout, offers well proportioned accommodation and briefly comprises a generous entrance hall, living/dining leading to a patio area, well-appointed kitchen, a master bedroom with wardrobes and a further double bedroom and a bathroom.

To the rear are communal gardens which are mainly laid to lawn.

Occupying a most convenient location with the town's amenities only a few steps away. Viewing comes highly recommended.

2



1



1





Marlborough Court, Croydon Road, TN16

Approximate Gross Internal Area 64.6 sq m / 696 sq ft

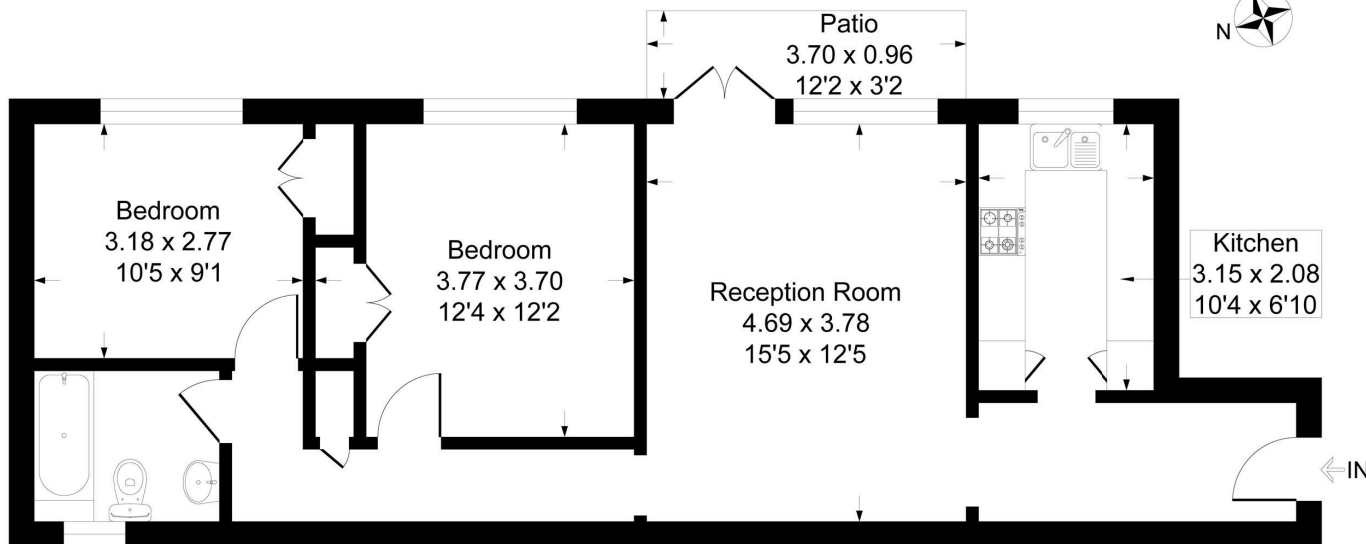

Ground Floor



This plan is for layout guidance only. Not drawn to scale unless stated. Windows and door openings are approximate. Whilst every care is taken in the preparation of this plan, please check all dimensions, shapes and compass bearings before making any decisions reliant upon them.
Produced By Planpix



LOCAL AUTHORITY

TENURE

EPC RATING

C

COUNCIL TAX BAND

C

VIEWINGS

By prior appointment only

Energy Efficiency Rating		Current	Potential
Very energy efficient - lower running costs			
(92 plus) A			
(81-91) B			
(69-80) C		72	79
(55-68) D			
(39-54) E			
(21-38) F			
(1-20) G			
Not energy efficient - higher running costs			
England & Wales		EU Directive 2002/91/EC	

Agents Note: Whilst every care has been taken to prepare these particulars, they are for guidance purposes only. All measurements are approximate and are for general guidance purposes only and whilst every care has been taken to ensure their accuracy, they should not be relied upon and potential buyers/tenants are advised to recheck the measurements

Sinclair Hammelton

OFFICE ADDRESS

1&2 The Grange
Westerham
Kent
TN16 7AH

OFFICE DETAILS

01959 587 460
infowh@sinclairhammelton