



MELANIE ANDERSON
Independent Estate Agents POWERED BY **exp** UK

Ground Floor Flat, Vanewood Court, Plunch Lane, Mumbles, Swansea, SA3 4JY

Offers Over £240,000

🛏 1 🚿 1 🚗 1



- Immaculately Presented One Bedroom Ground Floor Flat
- Includes 150 Year Lease Extension
- Modern, Newly Fitted Kitchen
- Engineered Oak Floor Throughout
- New Heating System + Hot Water Tank
- Front Terrace with Sea Views Plus Rear Courtyard
- Allocated Parking Space + Visitor Bays Available
- Walking Distance to Bracelet Bay, Limeslade Bay and Cliff Path to Langland or Mumbles
- Ideal Location in Limeslade, Close to Mumbles Cricket Club, Forte's Cafe, Lighthouse/Rok Restaurants
- Quote RT001



Immaculately presented, one bedroom ground floor flat, located in the highly desirable coastal area of Limeslade. Finished to a high standard throughout, this stylish home is ideal for first time buyers, downsizers, or those seeking a seaside retreat. Accommodation briefly comprises; living/dining room, newly fitted modern kitchen, double bedroom and shower room. The property further benefits from engineered oak flooring throughout, a new heating system and hot water tank, plus a 150 year lease extension. Externally, there is a front terrace with sea views, rear courtyard, allocated parking space right in front of flat and visitor bays available. Ideally positioned within walking distance to Bracelet Bay, Limeslade Bay and the coastal path to Langeland and Mumbles, whilst also being close to local cafés and restaurants. Leasehold.



It is essential to quote RT001 when enquiring about this property

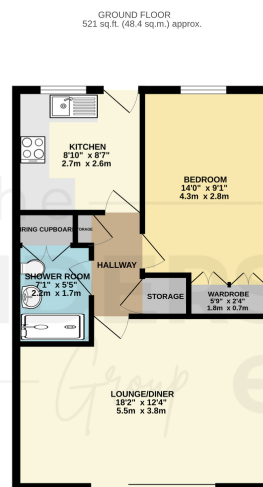

TOTAL FLOOR AREA: 521 sq.ft. (48.4 sq.m.) approx.
While every effort has been made to ensure the accuracy of the Property information, representations or statements, we do not warrant the accuracy, completeness or reliability of any information, including any statements or representations made by us or any third party. We do not accept any liability for any loss or damage, including any consequential loss or damage, arising from the use of the information. The information is provided for your information only and should not be relied upon as a basis for any decision. Please contact us for further information.

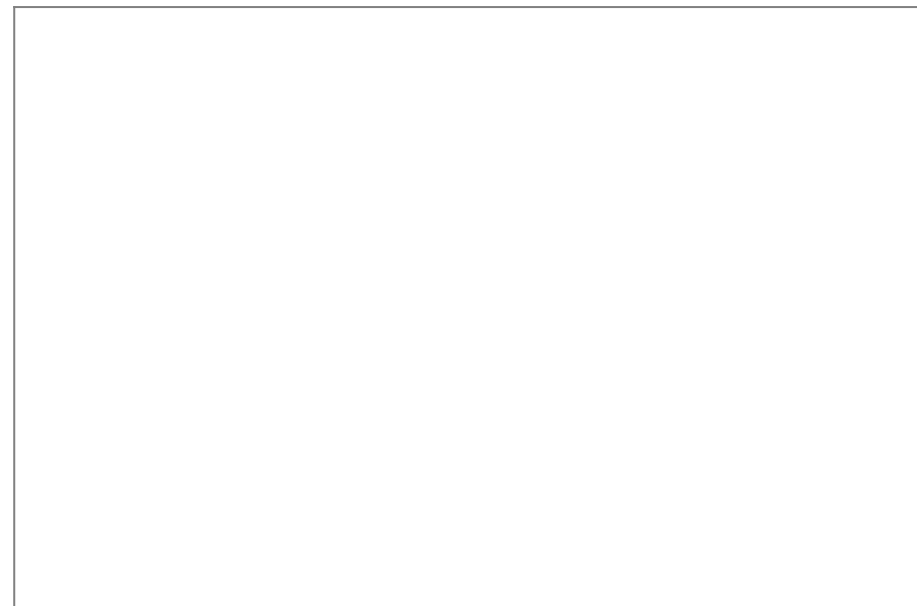

01792 805075

Swansea, Mumbles & Cower

sales@melanieanderson.co.uk