



The Mews, Southsea, PO4 0AR Asking Price £235,000

This beautifully presented two-bedroom mews-style house in Southsea is perfectly situated in a peaceful spot, close to local amenities and public transport.

With a spacious lounge, spacious kitchen, a double bedroom, single bedroom and a family bathroom, this property has plenty to offer couples and small families.

Benefitting from off road parking, this property is sure to receive a lot of interest, alongside this, the property is vacant and is being sold chain free!

Disclaimer

All dimensions are approximate and are quoted for guidance only, their accuracy cannot be confirmed. Reference to appliances and / or services does not imply they are necessarily in working order or fit for the purpose. Buyers are advised to obtain verification from their Solicitors as to the freehold / Leasehold status of the property, the position regarding any fixtures and fittings and where the property has been extended / converted as to Planning Approval and Building Regulations compliance. These particulars do not constitute or form part of an offer or contract, nor may they be regarded as representations. All interested parties must, themselves verify their accuracy. Where a room layout is included, this is for general guidance only, it is not to scale, and its accuracy cannot be confirmed.

The Mews, Southsea, PO4 0AR

Lounge 12'2" x 14'7" (3.73 x 4.46)

Kitchen 12'2" x 9'2" (3.72 x 2.80)

Bedroom 12'3" x 11'6" (3.74 x 3.53)

Bedroom 2 6'0" x 12'3" (1.85 x 3.74)

Bathroom 5'10" x 5'6" (1.79 x 1.68)

Ground Floor

Approx. 27.8 sq. metres (298.8 sq. feet)

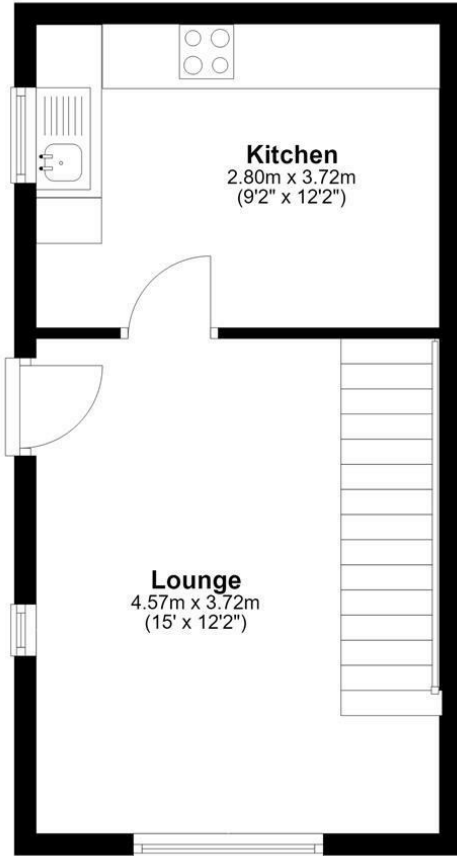

First Floor

Approx. 28.4 sq. metres (305.6 sq. feet)



Total area: approx. 56.2 sq. metres (604.4 sq. feet)

