



23 Cordelia Close, Dibden, SO45 5UD

Offers in Region of **£250,000**



ANTHONY JAMES
PROPERTIES



23 Cordelia Close

Dibden, Southampton

Presenting this well appointed 2-bedroom mid-terraced house in a prime location. The property boasts a spacious living room, kitchen, two double bedrooms and refitted bathroom. Enjoy the convenience of two allocated parking spaces, ensuring easy access for you and your visitors plus a rear garden laid to lawn with rear access. Gas fired central heating and double glazing throughout.

Council Tax band: B

Tenure: Freehold



1 Southward House
Dibden Purlicu SO45 4PT



T: 02380 844405

info@anthonyjamesproperties.co.uk



GROUND FLOOR
347 sq.ft. (32.2 sq.m.) approx.

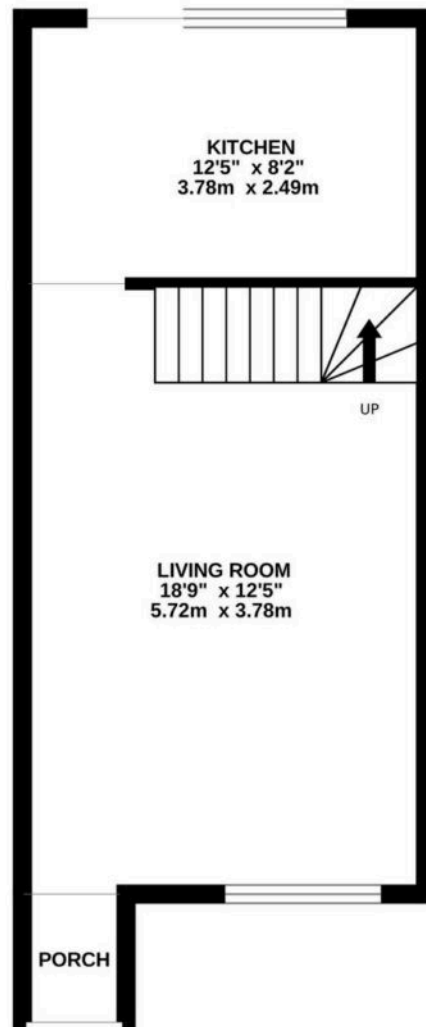

1ST FLOOR
334 sq.ft. (31.1 sq.m.) approx.



TOTAL FLOOR AREA: 681 sq.ft. (63.3 sq.m.) approx.

Whilst every attempt has been made to ensure the accuracy of the floorplan contained here, measurements of doors, windows, rooms and any other items are approximate and no responsibility is taken for any error, omission or mis-statement. This plan is for illustrative purposes only and should be used as such by any prospective purchaser. The services, systems and appliances shown have not been tested and no guarantee as to their operability or efficiency can be given.
Made with Metropix ©2025