



Knights Road, E16

£300,000

Located within a modern and sought after development in the heart of the Royal Docks, this well-presented one bedroom apartment offers stylish contemporary living with excellent transport links and residents' facilities.

The property features a spacious open plan living and dining area, a modern fitted kitchen and direct access to a private balcony. The double bedroom is well proportioned, complemented by a contemporary bathroom and built-in storage throughout. Residents also have access to a communal roof terrace, providing a space to enjoy views across the surrounding area.

West Silvertown DLR station is conveniently located close to the property, providing connections to Canary Wharf, Stratford and Bank. Custom House station, served by the Elizabeth line and DLR, is also nearby, offering easy access to the City, West End and Heathrow Airport.

Features

- Chain Free
- Modern one-bedroom apartment
- Private balcony
- Spacious open-plan living area
- Built-in storage throughout
- Communal roof terrace

Knights Road, London, E16

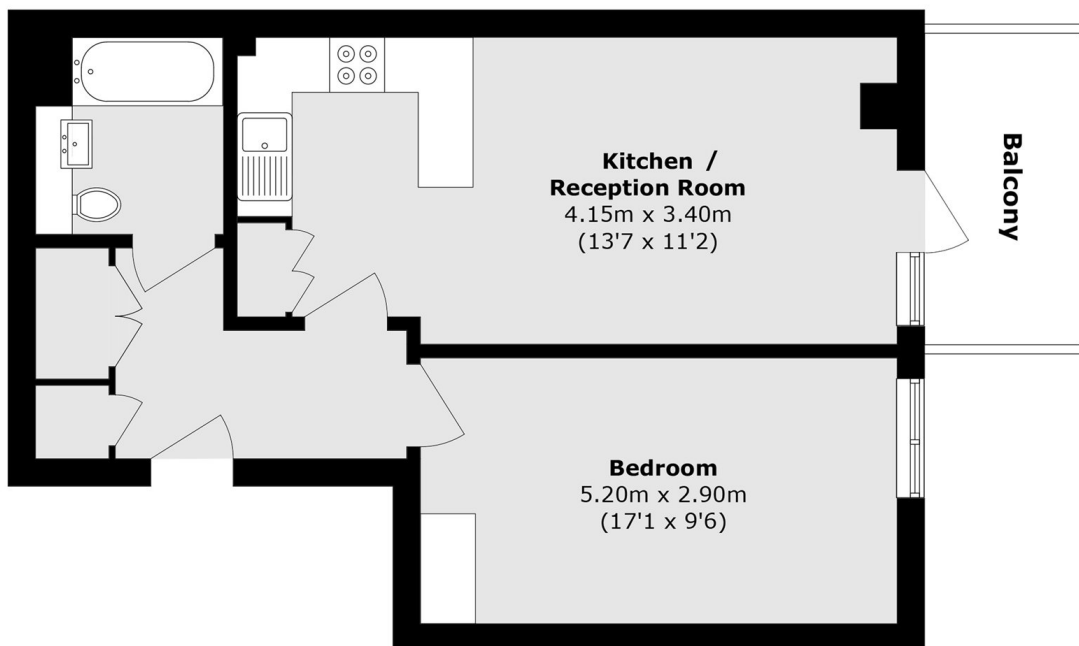

Total area (approx.): 51.6 sq. m (555.4 sq. ft)

Balcony area (approx.): 5.7 sq. m (61.3 sq. ft)