

# STEPPING STONES

3-4 Horsefair • Banbury • Oxfordshire • OX16 0AA

Telephone: 01295 275909 • Email: [info@steppingstonesletting.com](mailto:info@steppingstonesletting.com)



**ALMA ROAD, BANBURY, OXON, OX16 4RQ**

**£950pcm**



A one bedroom second floor apartment located within walking distance of the train station and town centre. The property benefits from having allocated car parking, built in wardrobe and electric heating.

EPC Rating: C. **Available: 18th May.**

- 1 Bedroom
- 1 Bathroom
- Electric heating
- Balcony
- Close to the train station
- Second floor

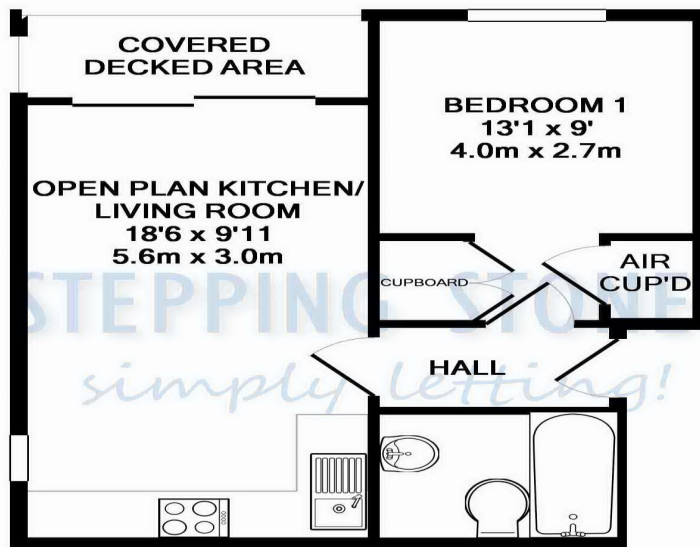

Whilst every attempt has been made to ensure the accuracy of the floor plan contained here, measurements of doors, windows, rooms and any other items are approximate and no responsibility is taken for any error, omission, or mis-statement. This plan is for illustrative purposes only and should be used as such by any prospective purchaser. The services, systems and appliances shown have not been tested and no guarantee as to their operability or efficiency can be given  
 Made with Metropix ©2016

Score	Energy rating	Current	Potential
92+	A		
81-91	B		
69-80	C	72 C	80 C
55-68	D		
39-54	E		
21-38	F		
1-20	G		

**ENTRANCE HALL:** Door to front aspect.  
**KITCHEN/DINER/LOUNGE:** 18'6 x 9'11 Doors to balcony and window to side aspect. Open plan comprising floor and wall mounted units with worktops over. Built in four ring electric hob with oven below and extractor hood above.  
**BEDROOM ONE:** 13'1 x 9'0 Window to front aspect. Built in wardrobe and airing cupboard.  
**BATHROOM:** White suite comprising bath with shower over, low level w.c. and wash hand basin. Heated towel radiator.  
**HEATING:** Electric heating  
**WATER & DRAINAGE:** Mains connected  
**PARKING:** One allocated car parking space  
**COUNCIL TAX:** Band A  
**EPC RATING:** C  
**REFERENCE:** 101

RENT: £ 950.00  
 TOTAL DEPOSIT: £ 1,096.15  
 HOLDING DEPOSIT: £ 219.23

Holding deposit is payable when the application is made and is deducted from the initial rent if the application is successful.

**Please Note:** This is **non-refundable** should any relevant person (including any guarantor(s)) withdraw from the tenancy, fail a Right-to-Rent check, provide materially significant false or misleading information, or fail to sign their tenancy agreement (and / or Deed of Guarantee) within 15 calendar days (or other Deadline for Agreement as mutually agreed in writing).

To check broadband and phone coverage please visit the Ofcom website: <https://www.ofcom.org.uk/phones-and-broadband/coverage-and-speeds/ofcom-checker/>

**Important Notice**

Every care has been taken with the preparation of these particulars but they are for general guidance only and complete accuracy cannot be guaranteed. If there is any point which is of particular importance then professional verification should be sought. These particulars do not constitute part, or all of, an offer or contract and are not to be relied upon as statement of representation or fact. Stepping Stones have not carried out a structural survey and the services, appliances, equipment, fixtures and fittings have not been tested and no guarantees as to their operating ability or efficiency are given. The measurements and floorplans supplied are for general guidance only and are not to scale. All dimensions and compass positions are approximate and for guidance only and should not be relied upon. Photographs are reproduced for general information and it cannot be inferred that any item shown is included in the letting.

