

Commercial
Second Floor Suite
The Welsh Mill
Park Hill Drive
Frome, BA11 2LE

Rent £8,000.00 (plus VAT) per annum
***Plus Services and Utilities**

A fantastic second-floor office suite within this multi-use complex.

This bright warehouse style office suite is suitable for a small/medium sized company.

There is onsite parking available.

*The services and utilities costs for example: the month of December 2025 equate to £335.00 + VAT this includes gas heating and electricity.

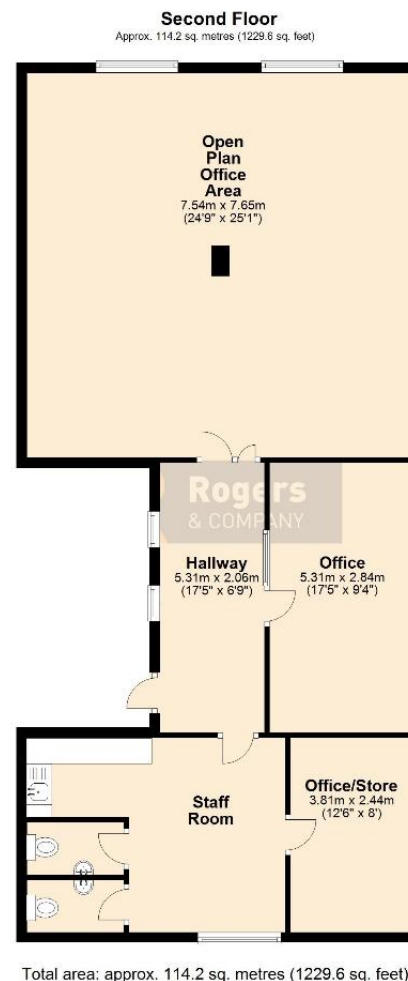

IMPORTANT: we would like to inform prospective purchasers that these sales particulars have been prepared as a general guide only. A detailed survey has not been carried out, nor the services, appliances and fittings tested. Room sizes should not be relied upon for furnishing purposes and are approximate. If floor plans are included, they are for guidance only and illustration purposes only and may not be to scale. If there are any important matters likely to affect your decision to buy, please contact us before viewing the property.

24 Bath Street, Frome, Somerset, BA11 1DJ
T 01373 454 335
E info@rogersandcompany.co.uk
rogersandcompany.co.uk

