



Stewart Road, Leyton

Offers Over £535,000



SIGNATURE
PROPERTY PARTNERS

Stewart Road, Leyton

Discover this beautiful two-bedroom Victorian house on the desirable Stewart Road in Leyton on Guide Price: £550,000 - £575,000. This charming property blends timeless period features with contemporary updates, providing a welcoming and comfortable home for its next owners. Lounge at the front with oak flooring and tasteful modern decor, creating a cosy space to unwind. The adjoining dining room, also with oak flooring, provides ample room for a dining table and relaxation, making it perfect for entertaining guests or enjoying family meals. Large windows in both rooms allow plenty of natural light to fill the space, enhancing the bright and airy atmosphere. The generously sized kitchen is a standout feature, offering ample space for cooking and storage. With cupboards running along two walls, there is plenty of room for all your kitchen essentials. Large windows flood the kitchen with natural light, creating a bright and inviting environment, while the tiled flooring adds a sleek and easy-to-maintain finish, making it both practical and stylish for everyday use. The ground floor bathroom, located at the rear of the property, is fully tiled and showcases a modern design with stylish fixtures and fittings, offering a fresh and functional space for everyday use. Additionally, there is a convenient utility room on the side of the property, providing extra space for appliances and laundry. Upstairs, you'll find two generously sized bedrooms, each offering a peaceful haven to retreat to at the end of the day. Both rooms are well-lit with natural light and offer plenty of storage, making them perfect for relaxation and comfort. The property boasts a private rear garden, ideal for outdoor dining, gardening, or simply relaxing in your own tranquil green space. This outdoor area is perfect for those who enjoy spending time in nature. Situated in the popular area of Leyton, Stewart Road offers easy access to a variety of local amenities, including shops, cafes, and the renowned Westfield Stratford City shopping center. Enjoy the nearby Drapers Fields recreation park, perfect for leisurely strolls and outdoor activities.





The property is well-served by excellent transport links, with Leyton Underground Station and Stratford International Station nearby, providing fast and easy connections to Central London and beyond.

The house is also conveniently located near Downsell Primary School, a well-regarded institution with a 'Good' Ofsted rating, making it an ideal choice for families.

Don't miss the chance to own this delightful Victorian house that perfectly balances historical charm with modern living.





You can also easily access Westfield Shopping Centre and Leyton Mills Shopping Centre, as well as local cafes, boutique shops, and the East Village, which is great for evening dining at restaurants



Approximate Gross Internal Area
77.54 sq m / 834.63 sq ft

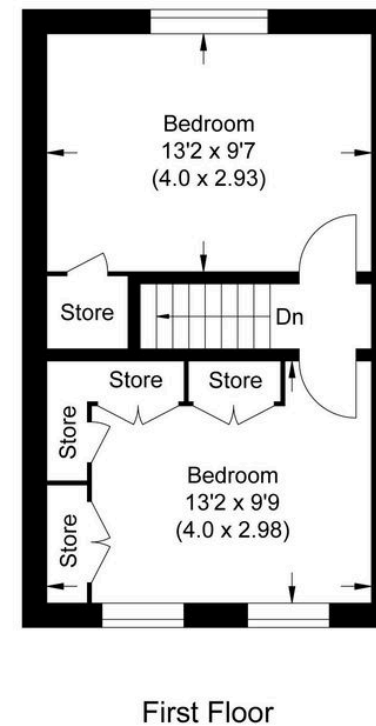
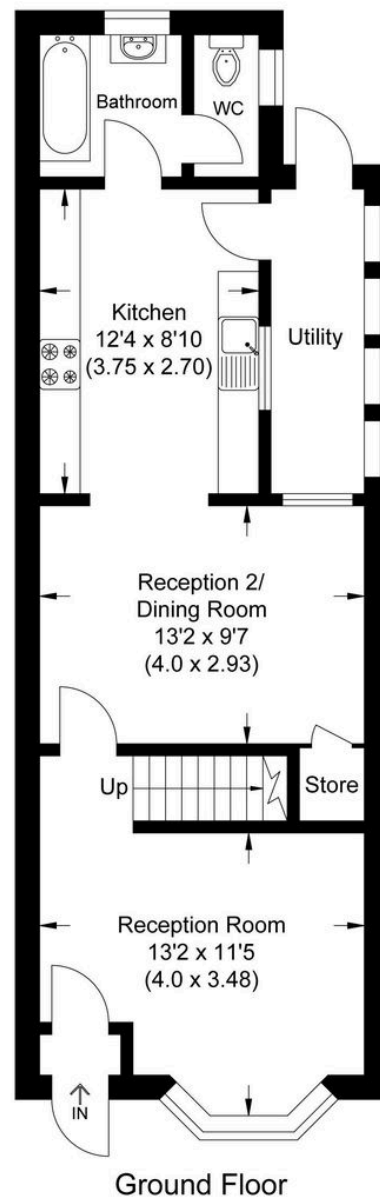

Illustration for identification purposes only, measurements are approximate, not to scale.

INFO@SIGNATUREPROPERTYPARTNERS.CO.UK

WWW.SIGNATUREPROPERTYPARTNERS.CO.UK