



Mole End Cottage, Brook Street, Buxton, Norwich, NR10 5HF

welcome to

Mole End Cottage, Brook Street, Buxton, Norwich

This is a charming Mid-Terrace Cottage, set in the sought after village of Buxton. This property enjoys Lounge/Diner, re-fitted Kitchen, 2 Bedrooms & Bathroom. Outside offers a delightful courtyard garden.



Description

Don't miss this charming Period Property, set in the popular village of Buxton which has a range of amenities to include a Morrison's Daily, Primary School, Fish & Chip Shop and 'The Black Lion' pub. The Market Town of Aylsham, with further amenities and transport links, lies approximately 4.2 miles away.

This property enjoys a Lounge/Diner with wood burner & re-fitted Kitchen to the ground floor, while upstairs has 2 Bedrooms & Bathroom.

Outside has a delightful courtyard garden with patio & store.

Lounge / Diner

17' 3" x 14' 8" (5.26m x 4.47m)

Front door opens into Lounge/Diner with wood burner inset to Inglenook fireplace & timber beam over, TV & BT points, wood floor, electric heater & front aspect double glazed window. Stairs lead to first floor & door to Kitchen.

Kitchen

11' 11" x 8' (3.63m x 2.44m)

Re-fitted kitchen with a range of wall & base units and work top over with sink. Electric cooker point with extractor over, plumbing for washing machine & dishwasher, space for fridge/freezer & built-in wine rack. Spotlights, tiled floor, rear aspect double glazed window & double glazed door to courtyard garden.

First Floor Landing

Loft access and doors to Bedrooms & Bathroom.

Bedroom One

13' 8" max x 12' 3" (4.17m max x 3.73m)

Double built-in wardrobe, wood floor & front aspect double glazed window.

Bedroom Two

12' 2" x 8' 4" (3.71m x 2.54m)

Electric heater & front aspect double glazed window.

Bathroom

Suite comprising low level WC, wash basin & bath with mixer taps, shower attachment and drench head shower over. Airing cupboard, wood floor, dado rail & double glazed window.

Outside

To the rear of the property is a charming courtyard garden, with a gravel area & steps up to patio terrace which has covered area and store.

Agent's Note

This property has a right of access across the back garden for the neighbour.

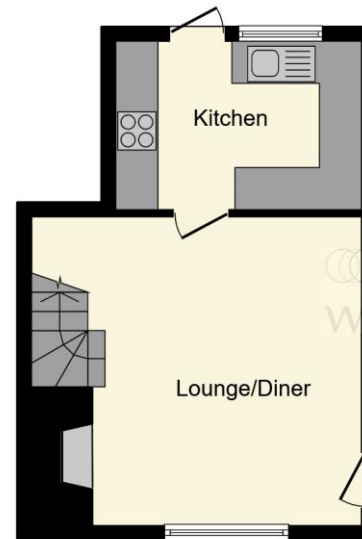

Ground Floor

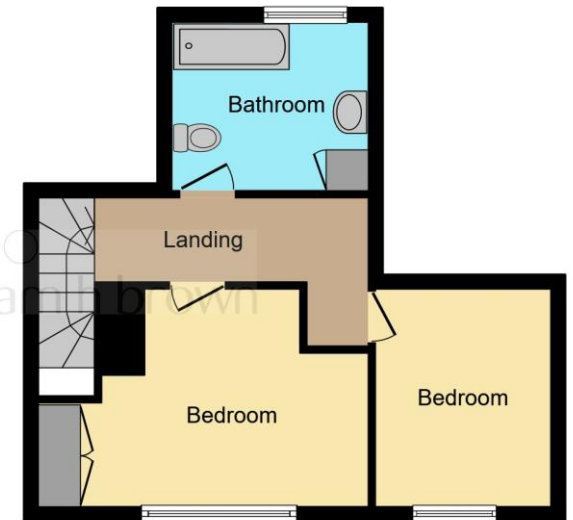

First Floor

This floorplan is for illustrative purposes only and is not drawn to scale. Measurements, floor-areas, openings and orientations are approximate. They should not be relied upon for any purpose and do not form any part of an agreement. No liability is taken for any error or mis-statement. All parties must rely on their own inspections.



view this property online williamhbrown.co.uk/Property/AYS109164



welcome to

Mole End Cottage, Brook Street, Buxton, Norwich

- Charming Mid-Terraced Cottage
- Lounge/Diner with Wood Burner
- Re-Fitted Kitchen
- 2 Bedrooms
- Bathroom
- Courtyard Garden
- Sought After Village Location

Tenure: Freehold EPC Rating: D

offers in excess of

£210,000



Please note the marker reflects the postcode not the actual property

view this property online [williamhbrown.co.uk/Property/AYS109164](https://www.williamhbrown.co.uk/Property/AYS109164)



Property Ref:
AYS109164 - 0010

1. MONEY LAUNDERING REGULATIONS Intending purchasers will be asked to produce identification documentation at a later stage and we would ask for your co-operation in order that there is no delay in agreeing the sale. 2. These particulars do not constitute part or all of an offer or contract. 3. The measurements indicated are supplied for guidance only and as such must be considered incorrect. Potential buyers are advised to recheck measurements before committing to any expense. 4. We have not tested any apparatus, equipment, fixtures or services and it is in the buyers interest to check the working condition of any appliances. 5. Where an EPC, or a Home Report (Scotland only) is held for this property, it is available for inspection at the branch by appointment. If you require a printed version of a Home Report, you will need to pay a reasonable production charge reflecting printing and other costs. 6. We are not able to offer an opinion either written or verbal on the content of these reports and this must be obtained from your legal representative. 7. Whilst we take care in preparing these reports, a buyer should ensure that his/her legal representative confirms as soon as possible all matters relating to title including the extent and boundaries of the property and other important matters before exchange of contracts.

William H Brown is a trading name of Sequence (UK) Limited which is registered in England and Wales under company number 4268443, Registered Office is Cumbria House, 16-20 Hockliffe Street, Leighton Buzzard, Bedfordshire, LU7 1GN. VAT Registration Number is 500 2481 05.



william h brown



01263 735252



Aylsham@williamhbrown.co.uk



23 Market Place, AYLSHAM, NORWICH,
Norfolk, NR11 6EL



[williamhbrown.co.uk](https://www.williamhbrown.co.uk)