



1C Brookfield Avenue, Larkfield

Guide Price £440,000

eden
estates

1C Brookfield Avenue

Larkfield, Aylesford

Guide price £440,000-£470,000. Modern 3 bed detached home with open plan living, en-suite master, driveway parking, no chain. Sought-after area near amenities, schools, and transport links. Council Tax band: D

Tenure: Freehold

- Large rear garden
- Drive way
- Modern kitchen with integrated appliances
- Open plan living area
- En-suite
- Decked patio and outdoor entertaining area
- Detached house
- No chain



eden
estates

Living Room

15' 1" x 8' 7" (4.59m x 2.61m)

Dining Area

13' 2" x 8' 7" (4.01m x 2.61m)

Kitchen

9' 11" x 7' 11" (3.03m x 2.42m)

Bedroom 1

10' 0" x 6' 6" (3.05m x 1.98m)

Bedroom 2

13' 8" x 9' 5" (4.16m x 2.86m)

Bedroom 3

10' 10" x 8' 7" (3.29m x 2.61m)

Bathroom

En-suite

Wc

Hallway





GARDEN

DRIVEWAY

3 Parking Spaces



Approx. total
floor area
914 SQ.FT.
85.00 SQ.M.

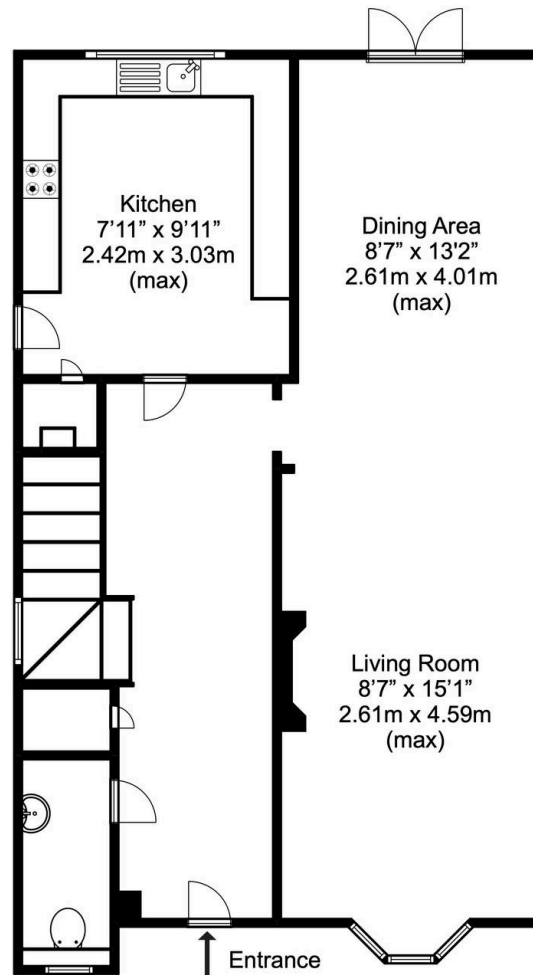

Ground Floor
Approx. floor area
463 SQ.FT.
43.02 SQ.M.

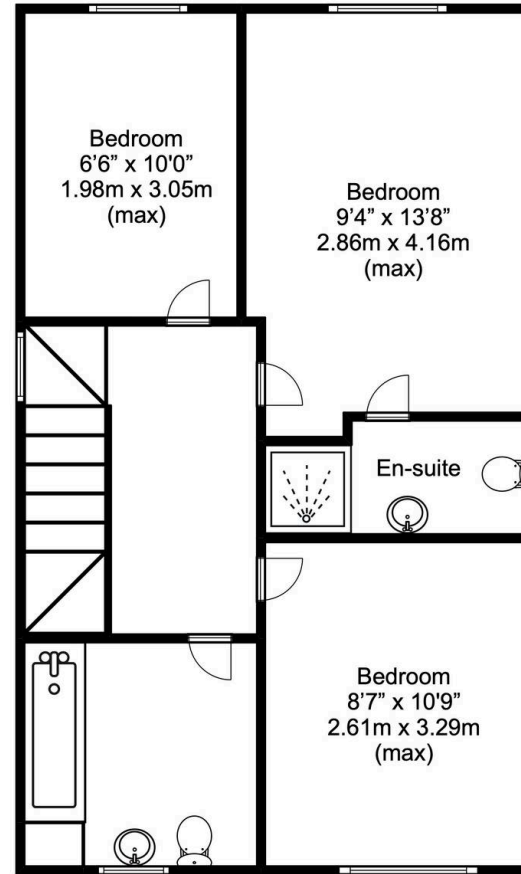

First Floor
Approx. floor area
451 SQ.FT.
41.98 SQ.M.

Disclaimer

This plan is for illustrative purposes only and no responsibility is taken for any error, omission or misstatement. The appliances shown have not been tested and no guarantee as to their operability or efficiency can be given. Measurements have been added as a guide to prospective buyers only, are not precise, not to scale, may have been taken from the widest area and may include wardrobe / cupboard space. Garages and outbuildings may not be represented in their actual location in relation to the property. Compass point, measurements and total areas should be considered inaccurate and checked as no guarantee is given to their accuracy. Buyers are strongly advised to take their own measurements and compass bearing.



Eden Estates

781-783 London Road, Larkfield - ME20 6DE

01732 795162

hey@eden-estates.co.uk

www.eden-estates.co.uk



eden
estates