

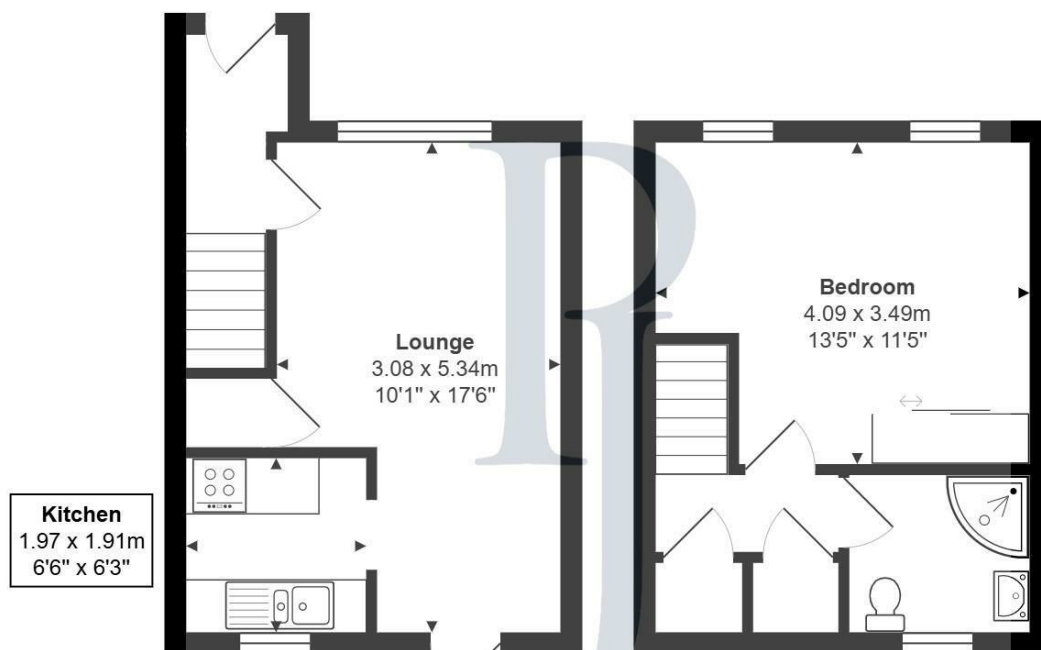

## 24 Middle King, Braintree, Essex, CM7 3XY

£975 PCM

- One bedroom
- Pets considered
- Enclosed rear garden
- Available end of Feb
- Allocated parking
- Viewing highly recommended



Total Area: 44.9 m<sup>2</sup> ... 483 ft<sup>2</sup>

Measurements are approximate for illustrative purposes only and may have been taken from the widest area

Floorplan Copyright The Estate Agents Photographer

[www.theestatesgentsphotographer.co.uk](http://www.theestatesgentsphotographer.co.uk)

## Directions

## Viewings

Viewings by arrangement only. Call 01376563656 to make an appointment.

## Council Tax Band

B

## EPC Rating:

D

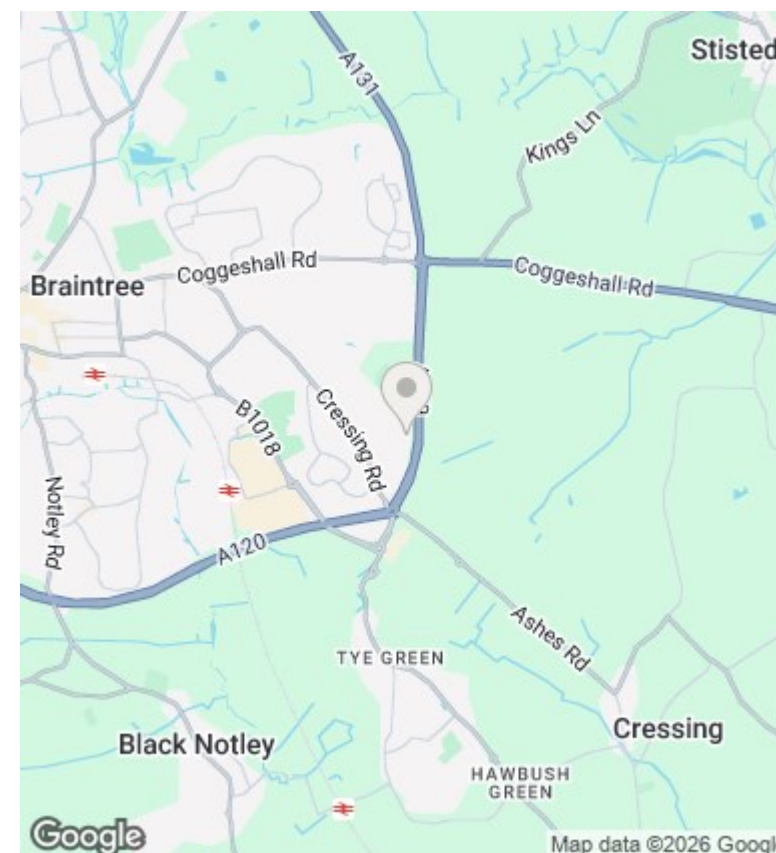

Energy Efficiency Rating		
	Current	Potential
Very energy efficient - lower running costs		
(92 plus) <b>A</b>		<b>90</b>
(81-91) <b>B</b>		
(69-80) <b>C</b>		
(55-68) <b>D</b>	<b>61</b>	
(39-54) <b>E</b>		
(21-38) <b>F</b>		
(1-20) <b>G</b>		
Not energy efficient - higher running costs		
England & Wales		EU Directive 2002/91/EC