



**Connells**

Bramblewood Close  
Gonerby Hill Foot Grantham



# Bramblewood Close Gonerby Hill Foot Grantham NG31 8QH

for sale  
**£175,000**



## Property Description

Connells are delighted to bring to the market this well-proportioned three bedroom family home offering comfortable living space arranged over two floors, ideal for families, first-time buyers or those looking to upsize.

The ground floor comprises of entrance hall with access to a lounge, providing a bright and versatile living area. To the rear, the dining room offers space for family meals and entertaining and leads through to a kitchen.

Upstairs, the first floor features three bedrooms and a shower room, complemented by a central landing providing access to all rooms.

Externally, To the front of the property there is a driveway providing off road parking, leading up to an integral garage with up and over door. To the rear there is an enclosed garden mainly laid to lawn with a patio area.

Early viewing is highly recommended.

## Entrance Hall

With stairs leading to the first floor and a door leading to the lounge.

## Lounge

With a window to the front, radiator, carpet,

opening leading to the dining room.

## Dining Room

With a window to the rear, door leading to the rear garden, opening leading to the kitchen.

## Kitchen

With a window to the rear, range of wall and base units, rolled edge worktops, stainless steel sink, space and plumbing for washing machine, space for free standing appliances.

## First Floor

## Landing

With doors leading to the three bedrooms, shower room and the airing cupboard.

## Bedroom One

With a window to the rear, carpet, radiator.

## Bedroom Two

With a skylight window, carpet.

## Bedroom Three

With a window to the rear, carpet, radiator.

## Shower Room

With a skylight window, W.C, wash hand basin with vanity units, shower cubicle.

## Agent Note

Agents Note: The sale of this property is subject to receipt of Grant of Probate. Please obtain an update from the branch with regards to the potential timeframes involved.













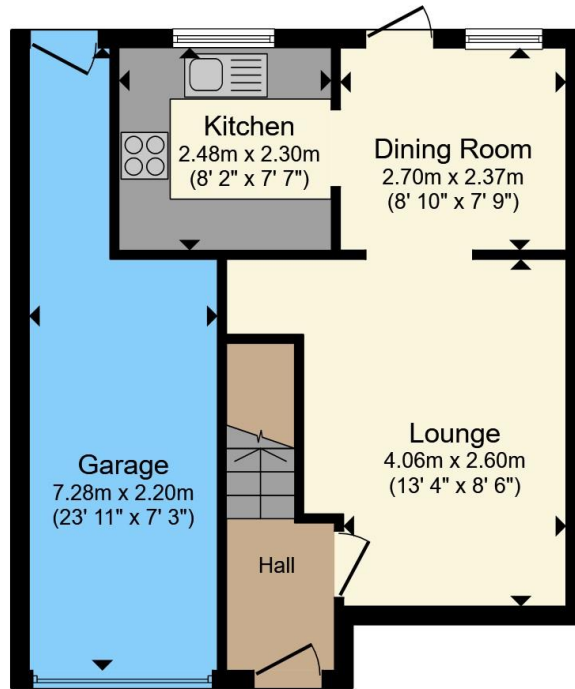

**Ground Floor**

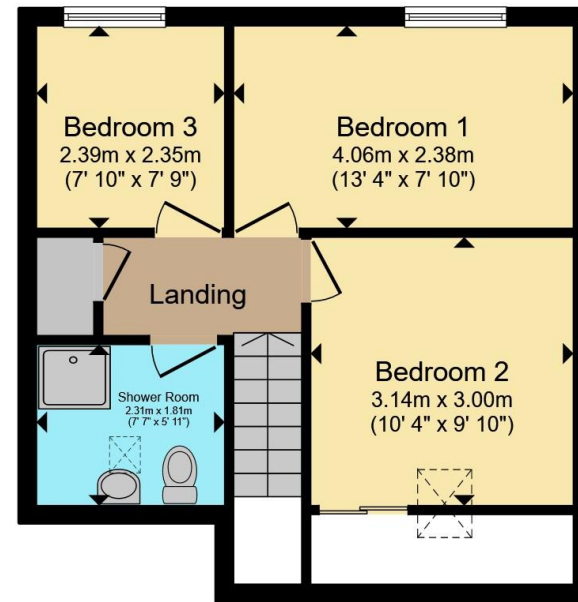

**First Floor**

Total floor area 79.9 m<sup>2</sup> (860 sq.ft.) approx

This floor plan is for illustrative purposes only. It is not drawn to scale. Any measurements, floor areas (including any total floor area), openings and orientation are approximate. No details are guaranteed, they cannot be relied upon for any purpose and they do not form part of any agreement. No liability is taken for any error, omission or misstatement. A party must rely upon its own inspection(s). Powered by [www.propertybox.io](http://www.propertybox.io)

**Connells**

To view this property please contact Connells on

**T 01476 590 050**  
**E [grantham@connells.co.uk](mailto:grantham@connells.co.uk)**

2 Watergate  
GRANTHAM NG31 6PR

EPC Rating: Council Tax  
Awaited Band: B

Tenure: Freehold

**view this property online [connells.co.uk/Property/GRM309434](http://connells.co.uk/Property/GRM309434)**



1. MONEY LAUNDERING REGULATIONS Intending purchasers will be asked to produce identification documentation at a later stage and we would ask for your co-operation in order that there will be no delay in agreeing the sale. 2. These particulars do not constitute part or all of an offer or contract. 3. The measurements indicated are supplied for guidance only and as such must be considered incorrect. Potential buyers are advised to recheck measurements before committing to any expense. 4. We have not tested any apparatus, equipment, fixtures, fittings or services and it is in the buyers interest to check the working condition of any appliances.

Connells Residential is registered in England and Wales under company number 1489613, Registered Office is Cumbria House, 16-20 Hockliffe Street, Leighton Buzzard, Bedfordshire, LU7 1GN. VAT Registration Number is 500 2481 05.

**See all our properties at [www.connells.co.uk](http://www.connells.co.uk) | [www.rightmove.co.uk](http://www.rightmove.co.uk) | [www.zoopla.co.uk](http://www.zoopla.co.uk)**

Property Ref: GRM309434 - 0002