



UPPER CHEYNE ROW
CHELSEA

JACKSON-STOPS 

UPPER CHEYNE ROW CHELSEA, SW3

ASKING PRICE: £2,750 PCM

A raised ground floor one bedroom apartment situated on this delightful street in the heart of Old Chelsea between King's Road and the River Thames.

Just 0.8 miles from South Kensington Station, 1 mile from Sloane Square Station and 0.4 miles from Battersea Park.



KEY FEATURES

- Bedroom
- Bathroom
- Kitchen
- Reception
- Unfurnished
- Tax Band: E



Upper Cheyne Row

Approximate Gross Internal Area = 443 sq ft / 41.2 sq m

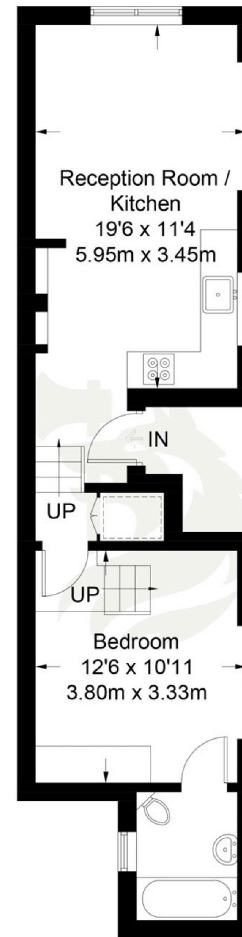

Ground Floor

Not to scale, for guidance only and must not be relied upon as a statement of fact.
All measurements and areas are approximate only and have been prepared in
accordance with the current edition of the RICS Code of Measuring Practice.

Energy Rating: D. We aim to make our particulars both accurate and reliable. However they are not guaranteed; nor do they form part of an offer or contract. If you require clarification on any points then please contact us, especially if you are travelling some distance to view. Please note that appliances and heating systems have not been tested and therefore no warranties can be given as to their good working order.

ASKING PRICE: £2,750 PCM

PIMLICO

020 7828 4243

pimlicolettings@jackson-stops.com

jackson-stops.co.uk

JACKSON-STOPS 