

**Thornlaw Road, London, SE27**

Offers Over £300,000

1 1 1

**Offers in excess of £300,000**

An elegant Victorian flat, this one-bedroom apartment is nestled on the ever-popular Thornlaw Road. A bright and airy home ideal for professionals seeking comfort, convenience, and character.

## Key Features

- Victoria Conversion
- Communal Garden Space
- Bright & Airy
- Well managed building
- Abundant Natural Light
- Prime Road in West Norwood
- Share of Freehold - 947 year lease
- 479 sqft
- Close to transport
- PLEASE QUOTE LT0751 FOR ALL ENQUIRIES

Approximate Gross Internal Area 479 sq ft - 44 sq m

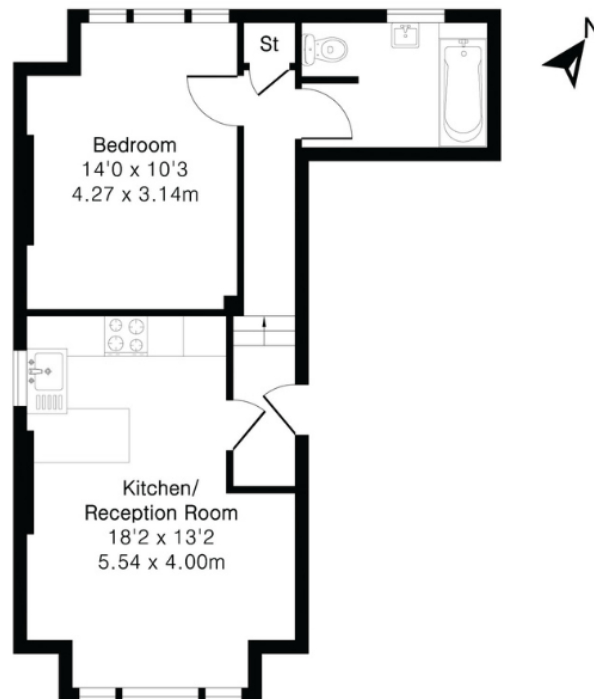

First Floor