



10 Keston Court, Parkhill Road, Bexley DA5 1HN
£1,650 Per Month



Well presented throughout, this spacious two double bedroom top-floor apartment sits within one of Old Bexley Village's most sought-after developments. Its prime location places you within easy walking distance of Bexley Station, popular local schools, bus routes, village shops and all other transport links. The accommodation comprises an entrance hall, two generous double bedrooms, a modern bathroom, a large reception room and a luxury fitted kitchen, along with the added benefit of a private balcony. Further advantages include double glazing, gas central heating, a garage, well-kept communal gardens and an entry-phone system. Viewing is highly recommended to appreciate the space, setting and convenience this property offers.

Local Authority: Bexley
Council Tax Band: D



01322 553322

60-62 High Street, Bexley, Kent DA5 1AH

bexley@parkestates.co.uk
www.parkestates.co.uk

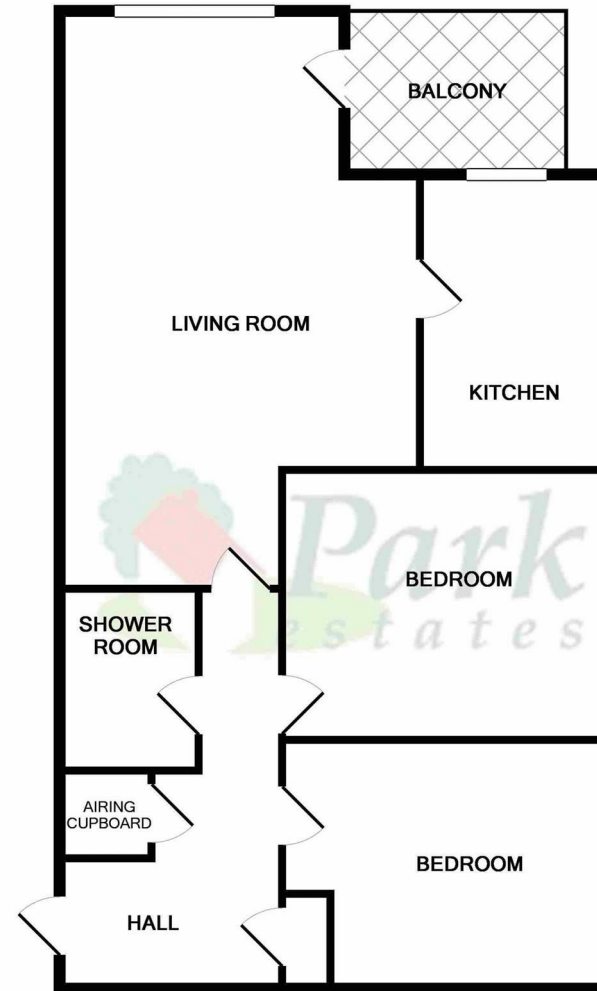

Whilst every attempt has been made to ensure the accuracy of the floor plan contained here, measurements of doors, windows, rooms and any other items are approximate and no responsibility is taken for any error, omission, or mis-statement. This plan is for illustrative purposes only and should be used as such by any prospective purchaser. The services, systems and appliances shown have not been tested and no guarantee as to their operability or efficiency can be given
Made with Metropix ©2019

Every care has been taken with the preparation of details, but accuracy is in no way guaranteed. These particulars do not constitute a contract and are issued and accepted on the express understanding that all negotiations will be conducted through Park Estates. The seller does not make or give, nor do we or our employees have any authority to give a representation or warranty in relation to the property. Please contact this office before viewing the property. If there is any point which is of particular importance to you, we will be pleased to check the information for you and confirm that the property remains available. This is particularly important if you are contemplating travelling some distance to view the property. We would strongly recommend that all the information that we provide about the property is verified by yourself on inspection and also by your conveyancer, especially where statements have been made by us to the effect that the information provided by us has not been verified.