



**POOLE  
TOWNSEND**

# 3 Ashness, Kents Bank Road, Grange over Sands

£145,000

🛏 1 🚿 1 🚗 1



- Prime location in Grange-over-Sands
- Spacious open-plan living area
- Character features
- Generous double bedroom
- EV charger cabling and modern comforts
- Beautifully renovated second-floor apartment
- Views towards Morecambe Bay
- Modern fitted kitchen
- Allocated parking and external storage
- No onward chain



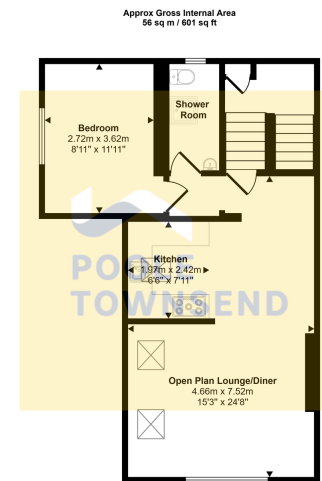

Floorplan

This floorplan is only for illustrative purposes and is not to scale. Measurements of rooms, doors, windows, and any items are approximate and no responsibility is taken for any error, omission or mis-statement. Icons of items such as bathroom suites are representations only and may not look like the real items. Made with Made Snappy 360.

Nestled in the heart of the sought-after coastal town of Grange-over-Sands, this beautifully renovated second-floor apartment offers spacious accommodation, allocated parking, and the advantage of no onward chain. Stylishly presented throughout, the property combines contemporary finishes with attractive character features including exposed stonework and painted beams. The bright open-plan living space enjoys views towards Morecambe Bay and benefits from Velux roof lights and a large front-facing window. The modern kitchen is fitted with sleek grey gloss units, while the spacious double bedroom and contemporary shower room complete the accommodation. The apartment also benefits from PVC double glazing, gas central heating, an allocated parking space, and external storage with EV charger cabling. Conveniently positioned within walking distance of amenities, this impressive home is ideal as a permanent residence, holiday retreat, or investment opportunity.

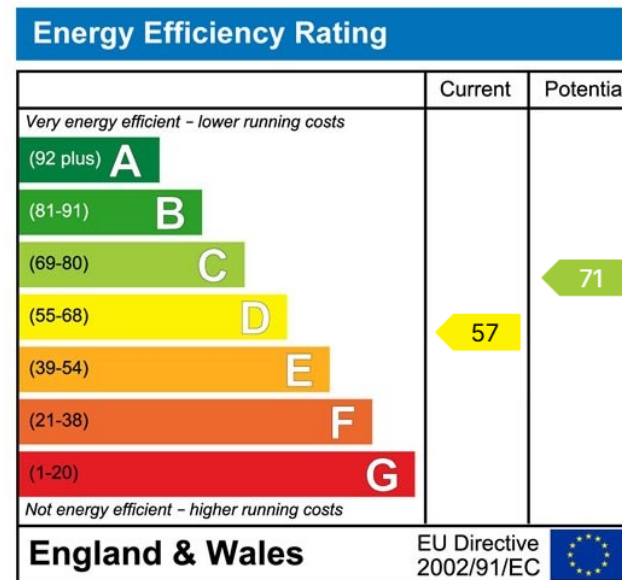

Visit us at  
[www.pooletownsend.co.uk](http://www.pooletownsend.co.uk)  
[enquiries@pooletownsend.co.uk](mailto:enquiries@pooletownsend.co.uk)

We are open  
 Monday – Friday 9.00 – 5.00  
 Saturday 9.00 – 1.00

Barrow 01229 811811  
 Ulverston 01229 588111  
 Grange 015395 33316  
 Kendal 01539 734455  
 Milnthorpe 015395 62044