



Burnt Ash Hill, SE12

£220,000

A well-presented one-bedroom flat in the popular Syon Lodge development on Burnt Ash Hill, SE12, ideal for first-time buyers or investors.

The property offers a spacious reception room, separate kitchen, double bedroom, and bathroom, along with a share of freehold. Further benefits include off-road parking and access to well-maintained communal gardens.

Lee Station is 0.6 miles away or about a 13 minute walk, with its train services to London Charing Cross and Cannon Street that take about 25 minutes. Popular Horn park with its children's play area is an 8 minute walk away. Sainsbury's on Burnt Ash Road is a mile away.

Features

- One Double Bedroom
- Spacious Reception Room
- Off Road Parking
- Communal Garden
- Share Of Freehold
- Ideal First Home/Investment

Burnt Ash Hill,
London, SE12

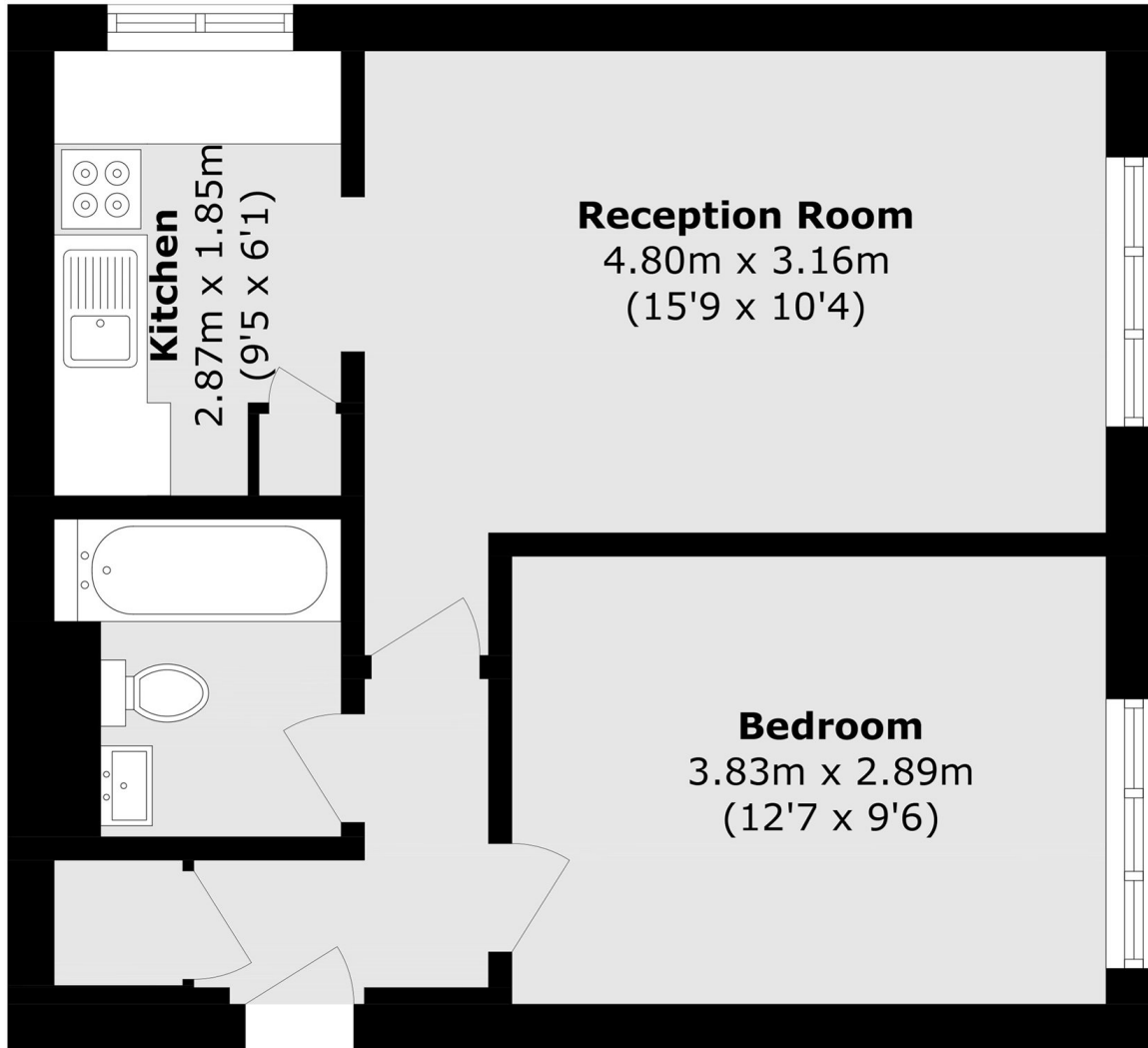

Total area (approx.): 41.6 sq. m (447.7 sq. ft)