

# Bishops Road, Somersham, Huntingdon, PE28 3HP

Offers Over £400,000

3 2 3



- Very well-presented detached chalet-style home.
- Modern kitchen designed for both functionality and style.
- Generous corner plot backing onto peaceful allotments and open fields.
- Beautifully maintained garden offering privacy and a tranquil outdoor escape.
- Virtual tour available upon request
- Three versatile reception rooms plus a bright conservatory.
- Three spacious bedrooms with potential one downstairs if required
- Tandem-length double garage and a large driveway for multiple vehicles.
- Solar panels owned outright, offering reduced energy bills.
- EPC Rating C/78

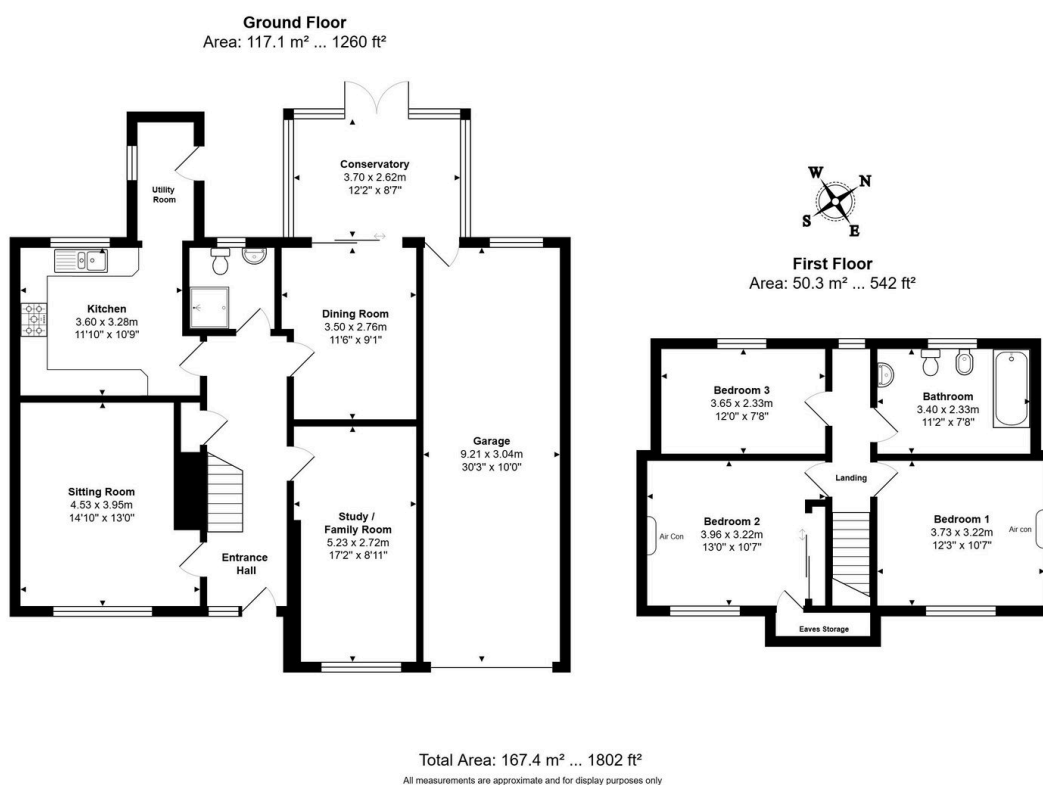

A very well presented, spacious three bedroom detached home, set on a generous corner plot in Somersham.