

## 6 Soar House St. Marys Road, Market Harborough,



**£172,500**

A true rarity! A spacious and modern two bedroom, ground floor apartment superbly positioned within a stones throw of Market Harborough town centre, supermarkets, shops and station having mainline links into London St Pancras in under one hour! This well presented property is situated to the rear of Soar House with a pleasant leafy outlook over the well maintained grounds and River Welland, boasting open plan living, double bedrooms and a private South East facing terrace. The accommodation briefly comprises: Entrance hall, lounge/diner, kitchen area, two bedrooms and bathroom. Outside the property enjoys its own wrap around outdoor space, communal gardens and secure underground parking. The property is offered to market with NO CHAIN! Viewing is highly recommended to truly appreciate the excellent location, well proportioned living spaces and wonderful private outdoor space making this home an excellent FTB, investment or downsize!

*Service without compromise*

## Communal Entrance



Accessed via secure entry system. Post boxes. Lift. Access to stairwell. Double doors leading through to vestibule and communal corridors.

## Entrance Hall



Accessed through wooden front door. Large walk-in store room. Built-in coat cupboard. Laminate wooden flooring. LED spotlights. Door to: Bathroom. Opening through to: Open plan living area.

## Open Plan Living Space



## Lounge/Dining Area 21'6 (max) x 13'9 (6.55m (max) x 4.19m)



UPVC double glazed 'French' doors out to: Private terrace area. LED spotlights. TV and telephone point. 2 x electric radiators. Doors off to: Bedrooms.

## Kitchen Area 21'6 (max) x 12'3 (6.55m (max) x 3.73m)



Having a selection of contemporary fitted base and wall units with a laminate worktop over and stainless steel sink. There is a double fan assisted electric oven, four ring electric hob with stainless steel extractor over, an integrated dishwasher, integral microwave and a space for a full size freestanding fridge/freezer. Tiled flooring. LED spotlights.

## Bedroom One 12'8 x 8'10 (3.86m x 2.69m)



UPVC double glazed door to side aspect. A selection of built-in wardrobes and storage. LED spotlights. TV point. Electric radiator.

## Bedroom Two 11'1 x 8'2 (3.38m x 2.49m)



UPVC double glazed door and window to side aspect. LED spotlights. Electric radiator.

## Bathroom 12'8 x 5'10 (3.86m x 1.78m)



Comprising: Panelled bath with glass shower screen and shower over, low level WC and wash hand basin with built-in mirrored cabinet over. LED spotlights. Feature floor tiling with wall tiling to wet areas. Chrome heated towel rail. Utility cupboard having space and plumbing for a freestanding washing machine. The utility cupboard also has shelving and houses the hot water cylinder.

## Private Terrace



The property has a large, South East facing private terrace area that can be accessed from the lounge and bedrooms. This great outdoor space is extremely low maintenance being laid to paved patio bordered by raised planters with well established planting creating a secluded area to enjoy throughout the seasons!

## Outside, Parking & Communal Gardens



Soar House benefits from immaculately kept communal gardens and grounds that are enjoyed by the residents



with tables and chairs during the summer months, large lawn, beautiful planting scheme and lighting. There are walkways around the gardens and grounds having steps and ramps to access the apartment buildings. The property also benefits from a secure underground parking space.

#### **Leasehold Information**

The property is subject to a 150 year lease from 20/01/2011 with 136 years remaining. The service charge is: £1,672.95 and is payable in two installments of £836.48 and the annual ground rent charge is £373.25.

#### **Note for Prospective Buyers**

Upon acceptance of an offer, all buyers will need to undertake an identification check for which there will be a charge of £50+VAT per person (non-refundable). These checks are completed to meet our obligations under Anti Money Laundering Regulations (AML) and are a legal requirement.

## Floor Plan

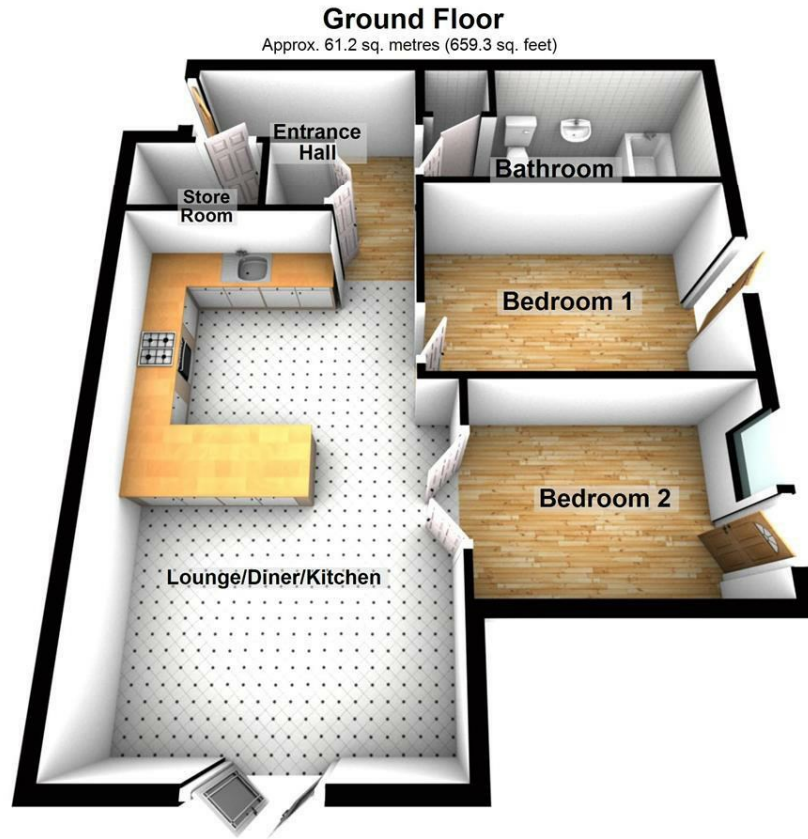

Total area: approx. 61.2 sq. metres (659.3 sq. feet)

THIS FLOOR PLAN WAS PRODUCED BY ADAMS AND JONES ESTATE AGENTS AND REMAINS PROPERTY OF THEM INDEFINITELY. ADAMS AND JONES RESERVE THE RIGHT TO CHARGE A FEE TO ANY OTHER AGENT OR VENDOR ATTEMPTING TO USE THESE PLANS FOR MARKETING PURPOSES WITHOUT PRIOR WRITTEN PERMISSION.  
Plan produced using PlanUp.

## Area Map

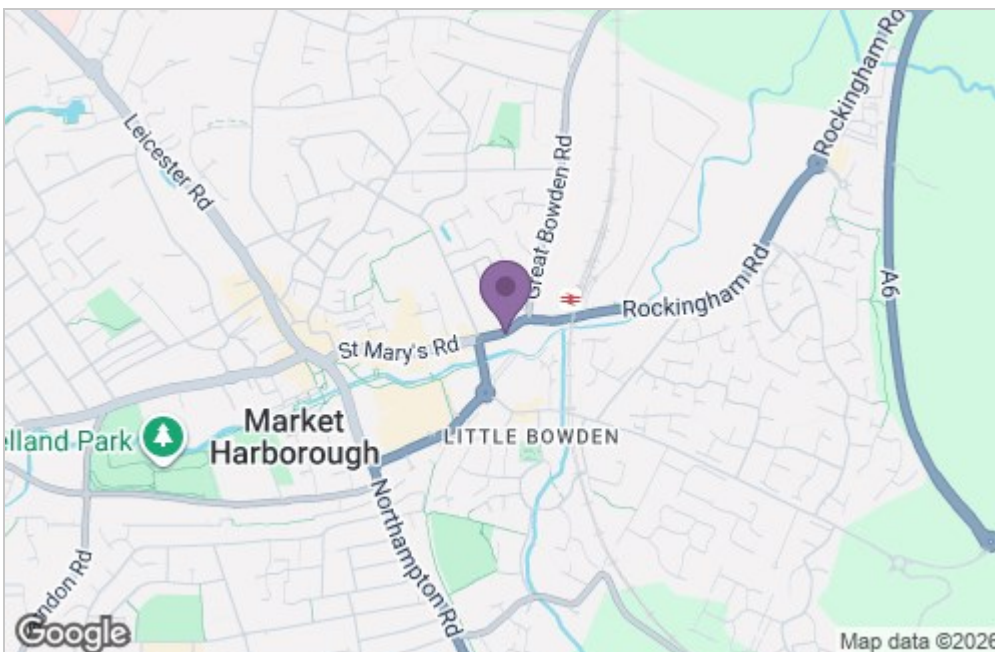

## Energy Efficiency Graph

