



BEAMES ROAD, NW10

£325,000

This superb, one-bedroom apartment is arranged over 646sqft, comprising an open plan kitchen/living room with direct access to a large south-facing balcony, a spacious double bedroom also with access to the

Large One Bedroom Apartment	Quiet Location
South Facing Balcony	Modern Development
Arranged Over 646sqft	Chain Free

STEP INSIDE BEAMES ROAD

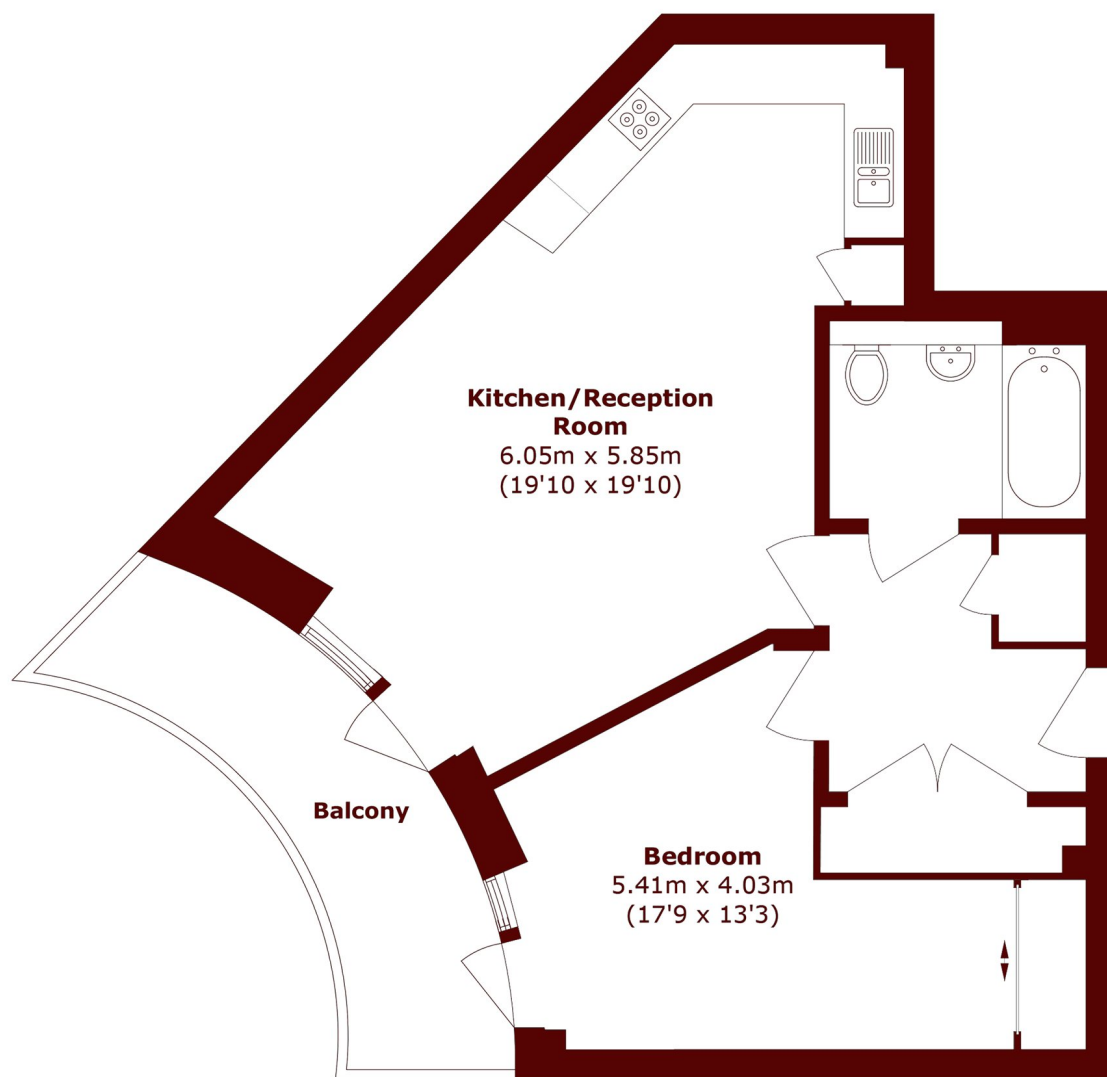

Total area (approx.): 60.1 sq. m (646.9 sq. ft)

Balcony area (approx.): 9.3 sq. m (100.1 sq. ft)

Willesden Green
020 8451 0420

Energy Rating: B We aim to make our particulars both accurate and reliable. However, they are not guaranteed; nor do they form part of an offer or contract. If you require clarification on any points then please contact us, especially if you're traveling some distance to view. Please note that appliances and heating systems have not been tested and therefore no warranties can be given as to their good working order

**MARSH &
PARSONS**