



Apt 6, Clifton House, 32 Clifton Road
£185,000

Apartment 6

Clifton House, Manchester

Millbrooke Estate Agents are delighted to offer for let this wonderful two-bedroom apartment, ideally situated on the ever-popular Corbel Way development just off Monton Road.

Council Tax band: B

Tenure: Leasehold

EPC Energy Efficiency Rating: C

EPC Environmental Impact Rating: B

- A spacious well-presented apartment
- Bright Open-Plan Lounge/Diner with Plenty of Natural Light
- Modern Bathroom Suite
- Two Generous Double Bedrooms
- Resident & Guest Parking Within A Well-Maintained Development
- Prime Monton Location
- Many Local Amenities
- Excellent Transport Links
- Stylish Kitchen with Integrated Appliances





Millbrooke
ESTATE AGENTS



Millbrooke
ESTATE AGENTS



Millbrooke
ESTATE AGENTS



Millbrooke
ESTATE AGENTS



Millbrooke
ESTATE AGENTS



Millbrooke
ESTATE AGENTS

GROUND FLOOR
537 sq.ft. (49.9 sq.m.) approx.

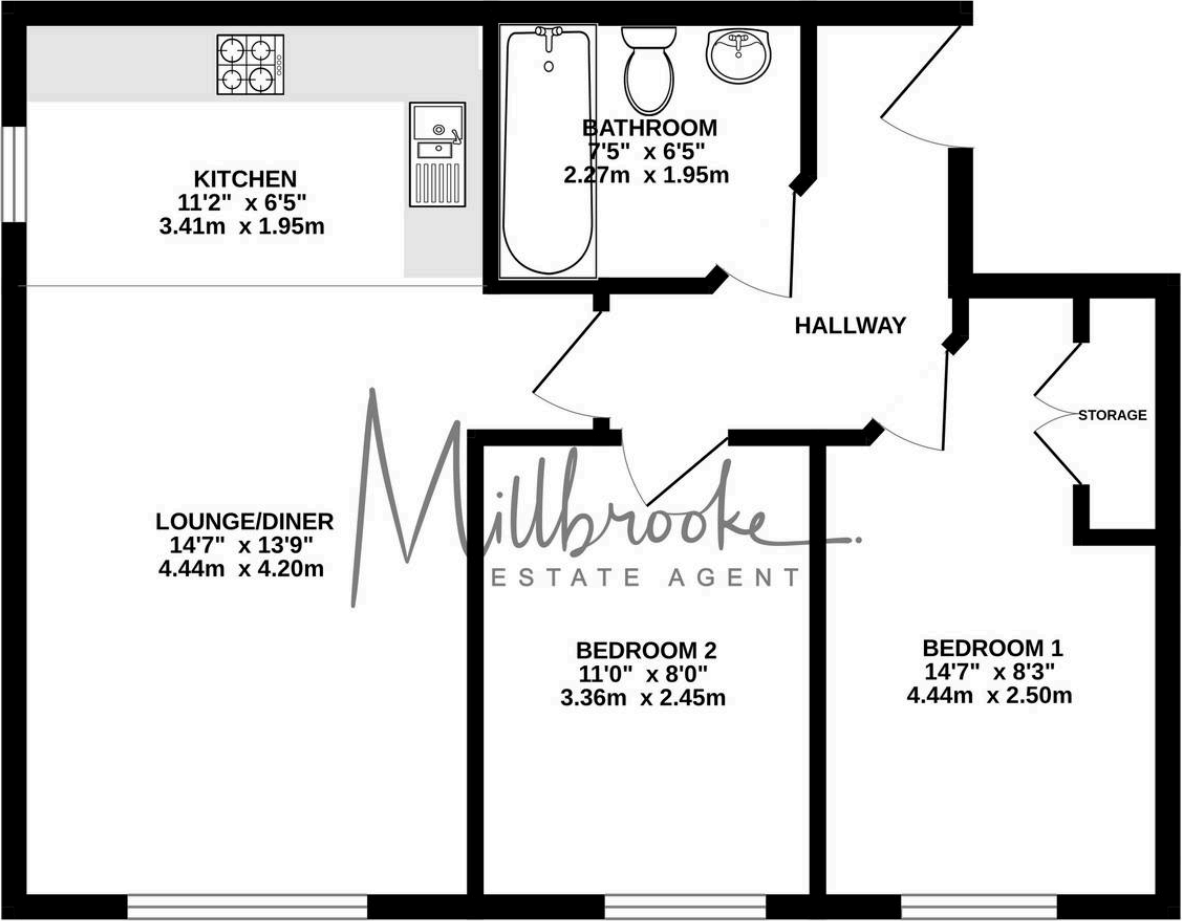

TOTAL FLOOR AREA : 537 sq.ft. (49.9 sq.m.) approx.

Whilst every attempt has been made to ensure the accuracy of the floorplan contained here, measurements of doors, windows, rooms and any other items are approximate and no responsibility is taken for any error, omission or mis-statement. This plan is for illustrative purposes only and should be used as such by any prospective purchaser. The services, systems and appliances shown have not been tested and no guarantee as to their operability or efficiency can be given.
Made with Metropix ©2026



Millbrooke Estate Agents

271 Mosley Common Road, Worsley, Manchester - M28 1BZ

0161 790 5154 • hello@millbrooke.co • millbrooke.co

